

**General Notes**  
The drawing is copyright of Vabel LTD. All rights reserved. No reproduction in any material form is permitted without consent. Do not scale from this drawing. All dimensions are in mm unless stated otherwise. Dimensions, levels, sizes and location of particulars are to be verified by the contractor on site prior to engaging in works. This drawing may incorporate information from other professionals. Vabel LTD cannot accept responsibility for the integrity and accuracy of such information.  
DO NOT SCALE

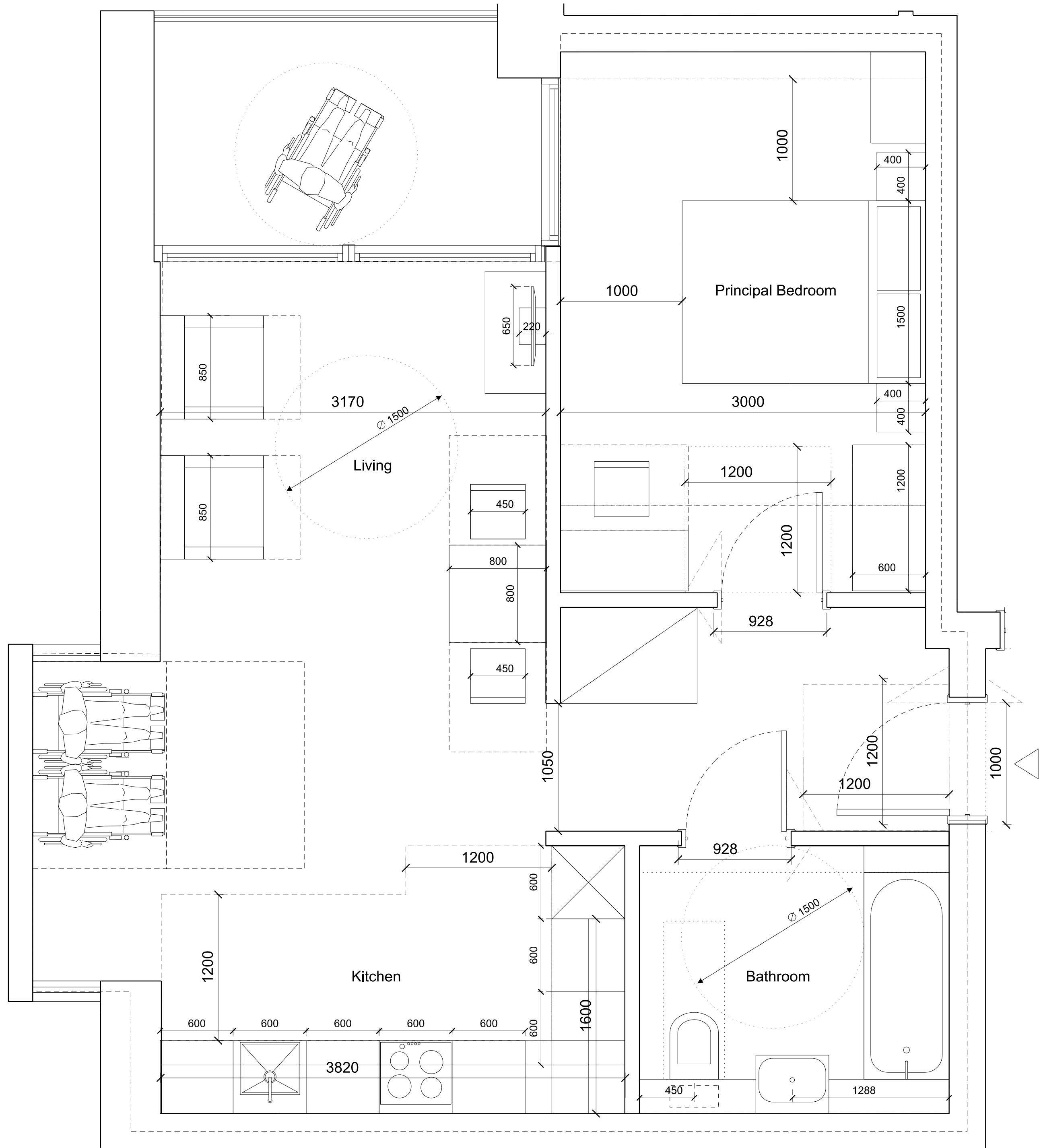
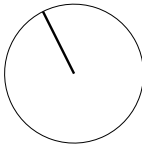

Internal Unit layouts to meet Part M4(3)

Units 8, 15, and 22 have been designed to comply with the guidance set out in M4(3) of Approved document M Volume 1, 2015 edition with 2016 Amendments.

All furniture shown on the layouts has been sized to the dimensions set out in Appendix D: Furniture Schedule in Approved Document Part M Volume 1.

Dimensions have been indicated on the adjacent plans to demonstrate compliance with M4(3) with particular reference to the points and respective paragraphs below. For more complete information please refer to Approved document M Volume 1, 2015 edition with 2016 Amendments.

To summarise:

3.24 - Every door has a minimum clear opening width of 850mm, irrespective of the direction of entry.

3.24 f & j - Minium 300mm ribs have been provided to the leading edge and 200mm ribs have been provided to the following edge of all doors

3.26 - Minimum storage area has been provided

3.32 - Kitchen, dining and living areas all have step free access

3.33 - The overall length of kitchen worktop meets the provisions in table 3.3 (4330mm total worktop length)

3.35 - Every bedroom can provide a minimum clear access route to the window. Every bedroom can provide a minimum 1200mm x 1200mm manoeuvring space inside the doorway, clear of the bed and the door (when the door is closed in position)

3.37 & 3.33 - Bathrooms comply with paragraphs 3.37 and 3.38

Units 8, 15, 22

IN01	23/09/22	Planning Condition Discharge	NE
Rev	Date	Reason for Issue	Chk

**VABEL**  
LONDON

531 Highgate Studios, 53-79 Highgate Road, London NW5 1TL  
Tel +44 (0)20 7183 6405 Email [contact@vabel.co.uk](mailto:contact@vabel.co.uk)

Project  
18-22 Haverstock Hill, NW3

Title  
Planning Condition 18  
M4(3) Units

Date	Scale @ A1	Drawn	Checked
23/09/22	1:25	MB	NE

Status  
Information

Drawing Number	Revision
1901_15_805	IN01