

Proposed Lower Ground Floor Plan

Lintel Schedule: (all lintels to have min 150mm bearings UNO)

LN1 Traditional brick arch lintel to outer leaf with 140mm high x 100mm wide prestressed concrete lintels to inner leaf (1no. per 100mm wall thickness)

LN2 Catmic CG90/100 cavity wall lintel

LN3 140mm high x 100mm wide prestressed concrete lintels to inner leaf (1no. per 100mm wall thickness)

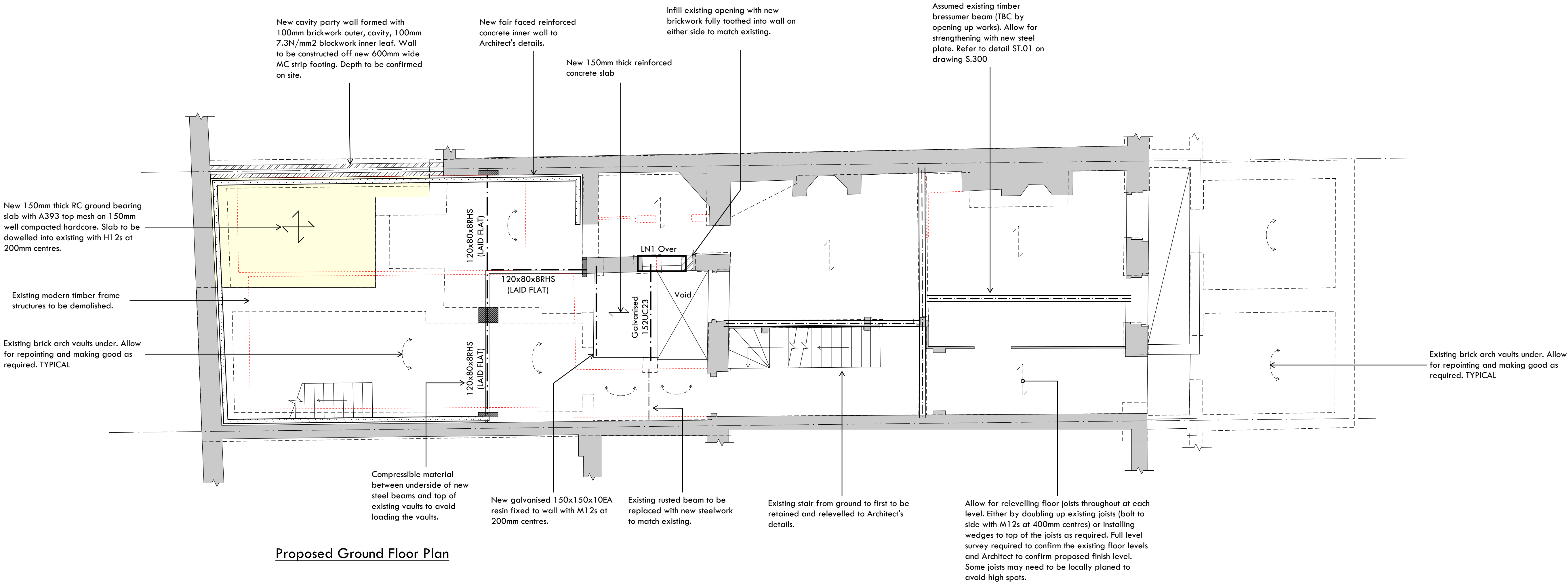

Proposed Ground Floor Plan

- General notes:**
1. Do not scale from this drawing
 2. To be read in conjunction with all other structural drawings and the structural specification
 3. To be read in conjunction with all other relevant disciplines drawings and specifications
 4. All levels, setting out, waterproofing and fireproofing to be confirmed with the Architect
 5. The Contractor is responsible for the temporary stability of the existing and proposed structure throughout the works. The sequencing and method of installation should be carefully considered and the temporary works should be designed and detailed by a suitably qualified person (appointed by the Contractor) prior to commencing the works
 6. Contractor to request splices if required for handling purposes

STRUCTURAL
Design
STUDIO

Studio 1, Three Eastfields Avenue, SW18 1GN

020 8191 8688 | www.structuraldesignstudio.co.uk

Project			
29 Great James Street, WC1N 3EY			
Drawing Title:			
Proposed Lower Ground and Ground Plan			
Job. No.	Drawing no.	Revision	
221090	S100	Preliminary	
Scale	Date	Drawn by	Rev. no:
1:50@A1	Oct 21	SW	P1