

11 D0011 - First Floor Demolition
Scale - 1 : 100

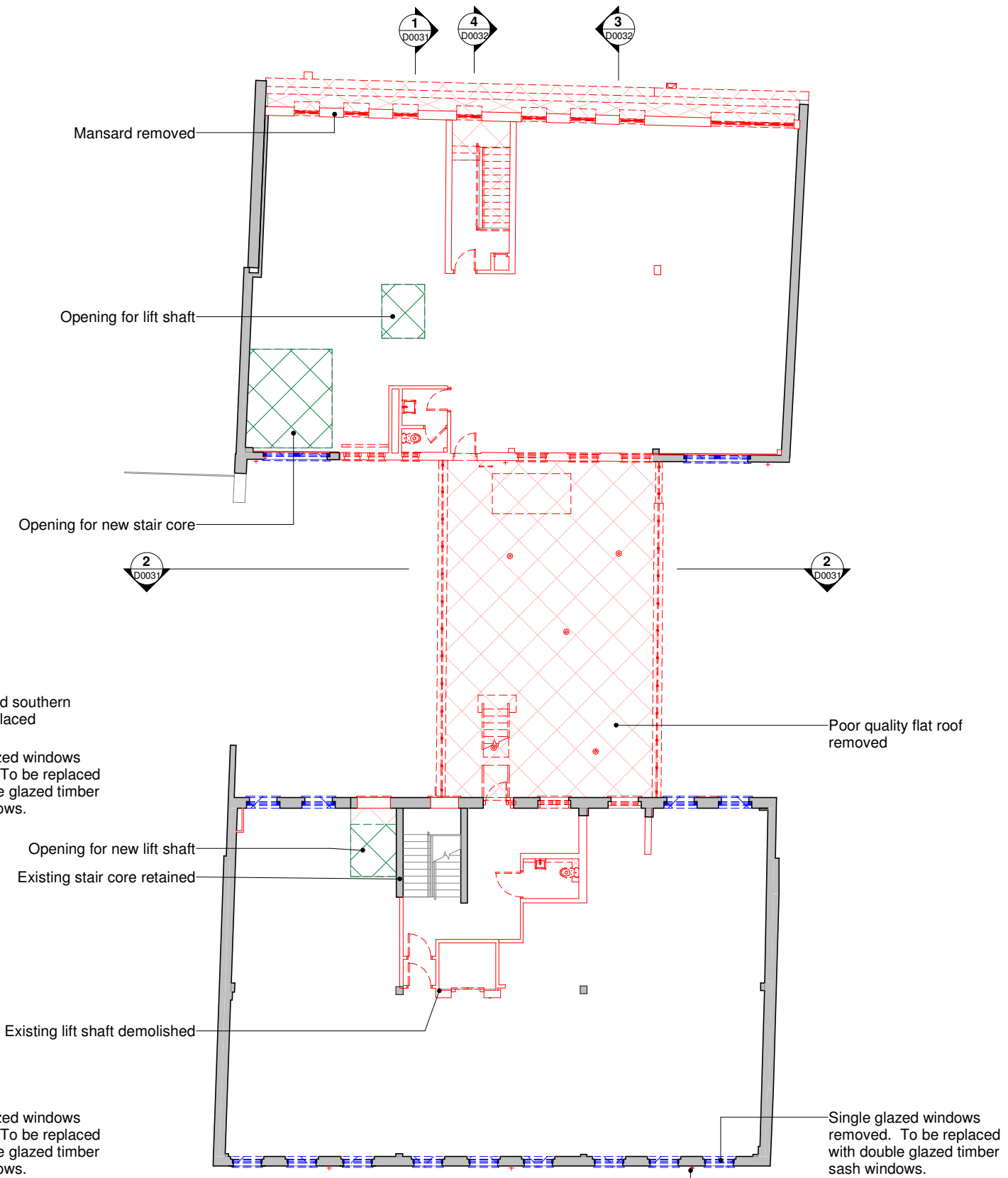

12 D0012 - Second Floor Demolition
Scale - 1 : 100

PLANNING NOTES

Architectural Information - the level of detail shown on the drawings is relative to the submission of a PLANNING APPLICATION.

The drawings should therefore not be used for any other purpose without both the prior agreement of the architect, and subsequent checking / development by others.

Dimensions and setting out - Do not scale from this drawing. All dimensions to be checked on site by the contractor and to be his responsibility.

Structure & Construction - these drawings, unless expressly noted otherwise, have not been fully coordinated with a Structural Engineer's input and show indicative construction build-up only.

Building Control - the client / the contractor will liaise directly with Local Authority to ensure the project is completed in accordance with the Building Regulations.

Planning - the client/ the contractor will ensure that the project is completed in accordance with the approved Planning drawings and take responsibility for the discharge of any planning conditions.

Party Walls & Rights to Light - the client/ the contractor will ensure that any notices and consents required are obtained before work commences.

Freshholder / Leaseholder / Restricted covenants / Easement approvals - the client will ensure that any notices and consents required are obtained before work commences.

Archaeological & Ecological - the client/ the contractor will ensure that any notices and consents required are obtained before work commences.

Areas - the areas provided on drawings are rounded to the nearest whole unit. Measurements are based upon received survey information and as such a reasonable allowance should be made for discrepancies or deviations that may occur during construction.

REFERENCE KEY

- Existing building elements to be retained
- Existing building elements to be demolished or removed
- Windows to be replaced
- Openings within retained slab

Note: all internal RC structure and floor slabs to be retained. Roof structure to be removed only to facilitate extensions



Rev	Date	Description	Author	Checker
0	06.09.2022	Draft issue of demolition drawings for planning	GJ	RD
A	23.09.2022	Frozen Envelope Design for Planning	GJ	RD
B	13.10.2022	PLANNING - Issued for Planning Application	GJ	RD

DEMOLITION

Project Number: H571
Project Name: 3-5 Bedford Row

Drawing Name: Demolition Plans - First and Second

Scale at A1 / A3: 1:200 / 1:400

Drawing Number: H571 - HUT - ZZ - ZZ - DR - A - D0002 - B