

1 Proposed First Floor Plan
Scale: 1:100

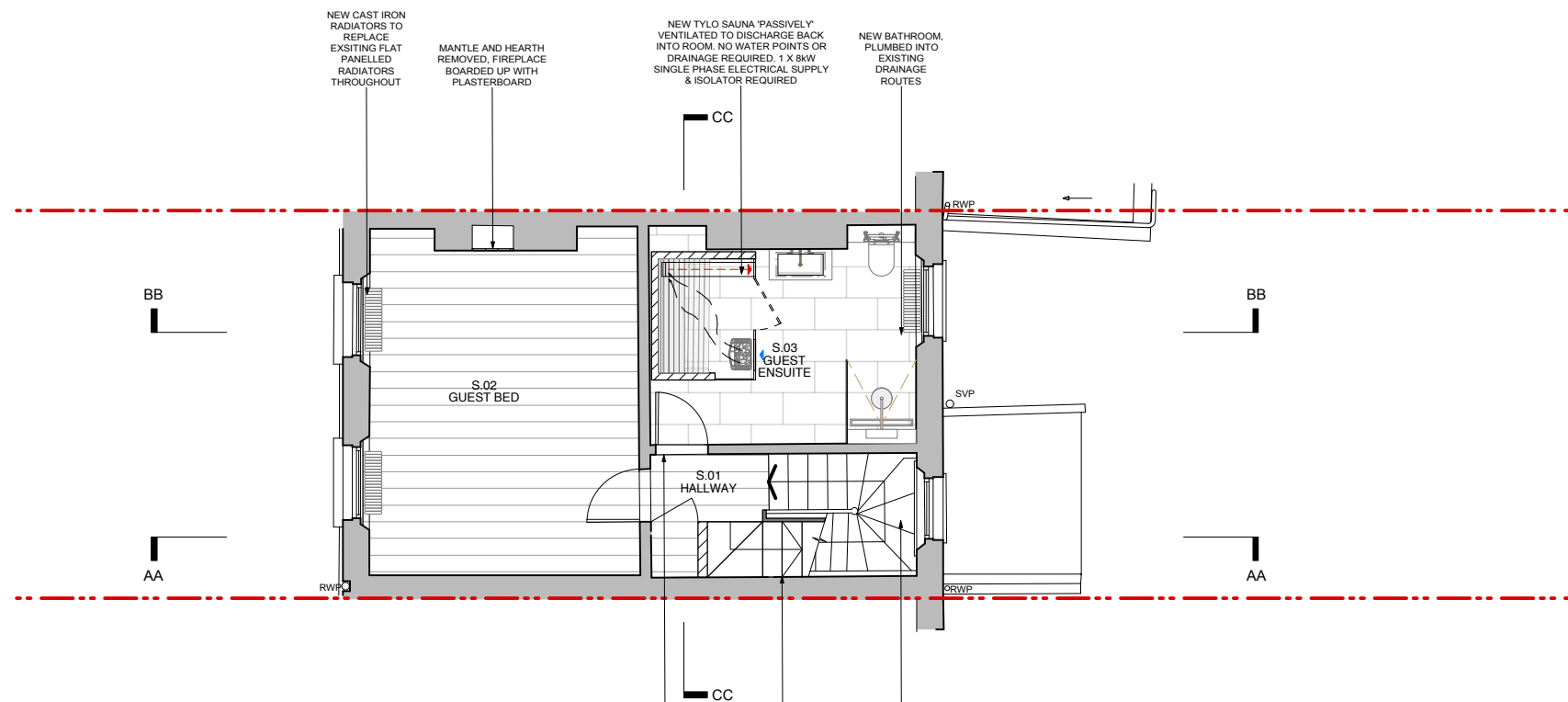

2 Proposed Second Floor Plan
Scale: 1:100



SCALE 1:100@A3
0m 1m 2m 3m 4m 5m 10m

PROPOSED SAUNA - TYLO HELO SAUNA

Power Supply:

Sauna: 1 x 8kW - Single or 3-Phase (3 x 16 Amp) Electrical Supply, isolated locally to sauna room.

Lighting: 1 x 6 Amp lighting feeds to plant room where the transformers will be located.

Water Supply - None required

Drainage: - None Required

Ventilation:

Sauna ventilation is a passive system which requires the supply air and the extract air to come from and discharge to the same area. This moving of air helps to remove hot spots and keep the temperature more uniform within the room. Undercut door to allow air in, with an extract ventilation slot at high level.

Floor:

Tile or stone finishes are laid on top of a waterproof membrane / tanking system.

REVISION			
DATE	28.06.2019	SCALE	1:100@A3
PROJECT	11 Chamberlain Street		
CLIENT	Jaakko Ahmala & Liisa Tornivaara		
DRAWING TITLE	PROPOSED FIRST & SECOND FLOOR PLAN		
DRAWING No.	GA_101		
ISSUE	PLANNING		

TR STUDIO

Architecture | Interiors

Unit 5.10 | Clerkenwell Workshops
27 - 31 Clerkenwell Close | London
EC1R 0AT

T: +44 (0)203 567 0569
E: office@trstudio.co.uk
W: www.trstudio.co.uk

This drawing must not be scaled from nor should it be used for the calculation of areas for the purposes of valuation. All dimensions are indicative and must be verified on site prior to the commencement of any works. This drawing must be read in conjunction with all necessary information from all other design consultants and contractors. All works must comply with the relevant British standards and building control requirements. Drawing errors to be reported to the Architect.