

1 Proposed Lower Ground Floor Plan
Scale: 1:100

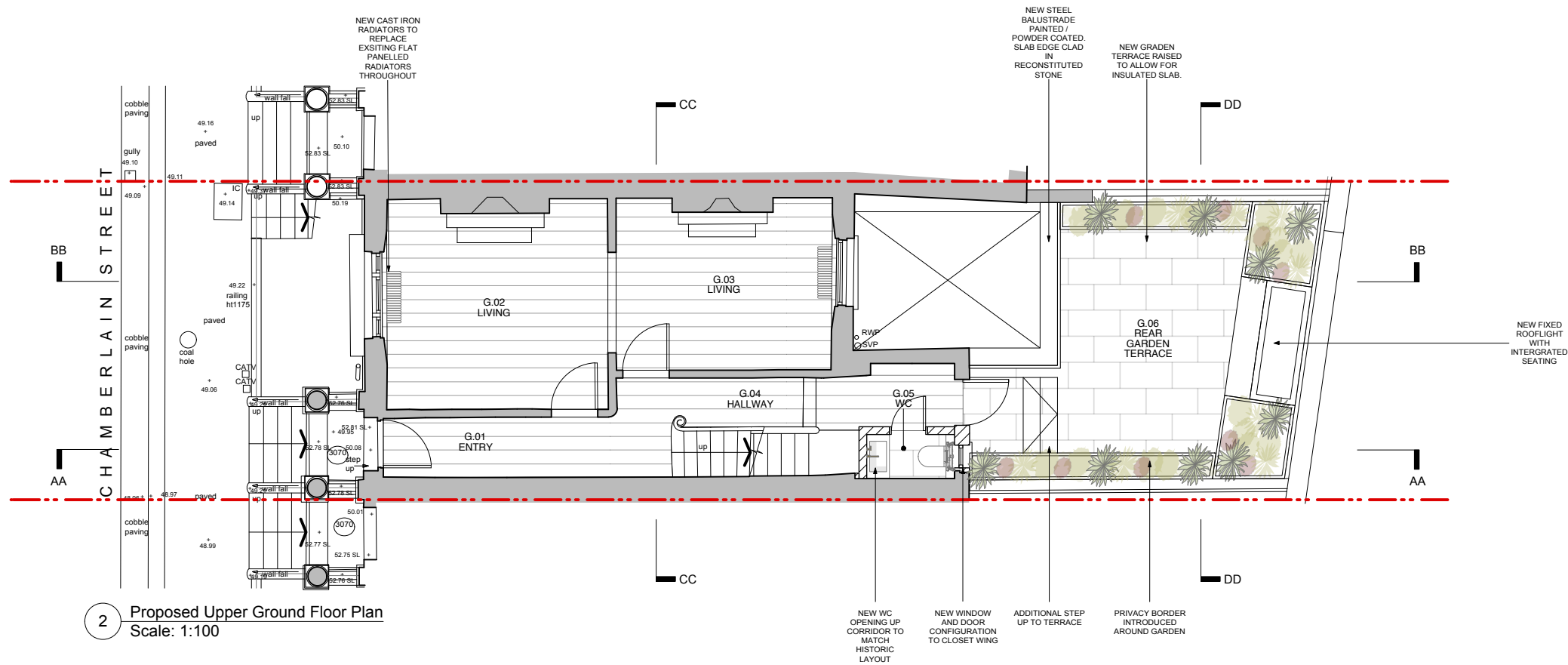

2 Proposed Upper Ground Floor Plan
Scale: 1:100



SCALE 1:100@A3
0m 1m 2m 3m 4m 5m 10m

REVISION			
DATE	28.06.2019	SCALE	1:100@A3
PROJECT	11 Chamberlain Street		
CLIENT	Jaakko Ahmala & Liisa Tornivaara		
DRAWING TITLE	PROPOSED LOWER & UPPER GROUND FLOOR PLAN		
DRAWING No.	GA_100		
ISSUE	PLANNING		

TR STUDIO
Architecture | Interiors

Unit 5.10 | Clerkenwell Workshops
27 - 31 Clerkenwell Close | London
EC1R 0AT
T: +44 (0)203 567 0569
E: office@trstudio.co.uk
W: www.trstudio.co.uk

This drawing must not be scaled from nor should it be used for the calculation of areas for the purposes of valuation. All dimensions are indicative and must be verified on site prior to the commencement of any works. This drawing must be read in conjunction with all necessary information from all other design consultants and contractors. All works must comply with the relevant British standards and building control requirements. Drawing errors to be reported to the Architect.