

OCTAV BOTNAR WING

THE PROPOSED CHILDREN'S CANCER CENTRE (CCC)

VARIETY CLUB BUILDING (VCB)

North Elevation as Proposed
1:200

Key

- 1 Red brick finish

2 Textured red brick finish - vertically oriented with relief pattern

3 Textured red brick finish - sawtooth profile in horizontal courses

4 Reconstituted stone finish - colour red/acid etched

5 Reconstituted stone finish with vertical fluting relief detail - colour red/acid etched
- 6 Reconstituted stone fins and angled overpanel window surround - colour buff / acid etched

7 Reconstituted Stone finish - colour buff / acid etched

8 Bay window assembly comprising neutral solar control glass in thermally broken anodised aluminium frame. Buff coloured reconstituted stone surround and cill panel

9 High performance double glazed window with neutral solar control glass. G-Value 0.34
- 10 Anodised aluminium railings with increased spacing above 1100mm

11 Weather louvre in colour to match buff finishes

12 Balcony soffits comprising secret fixed stamped stainless steel sheets

13 Ventilated rainscreen cladding system with render finish - colour buff/red

14 Curtain walling system with back enamelled insulated glass spandrel panels
- 15 Perforated corrugated metal rainscreen with PPC finish

16 Ventilated rainscreen system with PPC metal finish

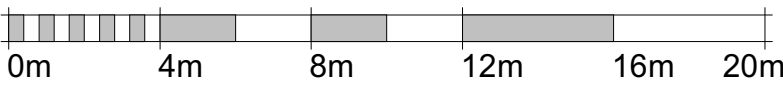

BUILDING DESIGN PARTNERSHIP SHALL HAVE NO RESPONSIBILITY FOR ANY USE MADE OF THIS DOCUMENT OTHER THAN FOR THAT WHICH IT WAS PREPARED AND ISSUED.

ALL DIMENSIONS SHOULD BE CHECKED ON SITE.

DO NOT SCALE FROM THIS DRAWING

ANY DRAWING ERRORS OR DIVERGENCIES SHOULD BE BROUGHT TO THE ATTENTION OF BUILDING DESIGN PARTNERSHIP AT THE ADDRESS SHOWN BELOW.

DRAWINGS SHALL BE READ IN CONJUNCTION WITH THE FOLLOWING BEFORE WORK COMMENCES:

- THE CDM DESIGN ISSUES REGISTER
- THE BDP RISK SERIES OF DRAWINGS
- THE PROJECT CDM RISK REGISTER

NOTES

P02	Revised East Core	PG	MB	07/10/2022
P01	For Planning	KD	MB	20/05/2022

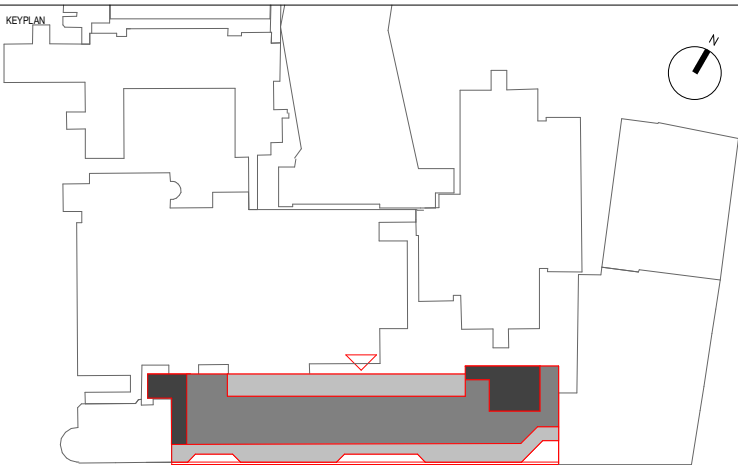

CONTRACTOR
BLIDDERS SISK CONTRACTORS
John Sisk & Son Ltd
2410 Regents Court
The Crescent
Birmingham Business Park
Birmingham
B37 7YE

DESIGN LEAD
BDP.
16 Brewhouse Yard
Clerkenwell
London
EC1V 4LJ
United Kingdom
T +44 (0)20 7812 8000
www.bdp.com

GOSH Children's Cancer Centre			PROJECT NUMBER P2007598	
PROJECT TYPE North Elevation as Proposed				
DRAWING NO. GOSHCCC-BDP-ZZ-ZZ-DR-A-2000-2073				
ISSUANCE/REVISION S2 - For Information		DATE 1 : 200	REVISION/DATE @ A1 07/10/2022	
DRAWN BY KD	CHECKED BY MB	APPROVED BY BZ	REVISION P02	