

BUILDING DESIGN PARTNERSHIP SHALL HAVE NO RESPONSIBILITY FOR ANY USE MADE OF THIS DOCUMENT OTHER THAN FOR THAT WHICH IT WAS PREPARED AND ISSUED.

ALL DIMENSIONS SHOULD BE CHECKED ON SITE.

DO NOT SCALE FROM THIS DRAWING

ANY DRAWING ERRORS OR DIVERGENCIES SHOULD BE BROUGHT TO THE ATTENTION OF BUILDING DESIGN PARTNERSHIP AT THE ADDRESS SHOWN BELOW.

DRAWINGS SHALL BE READ IN CONJUNCTION WITH THE FOLLOWING BEFORE WORK COMMENCES:

- THE CDM DESIGN ISSUES REGISTER
- THE BDP RISK SERIES OF DRAWINGS
- THE PROJECT CDM RISK REGISTER

NOTES

P02 Revised East Core		PG	MB	07/10/2022
P01	For Planning			
REVISION	DESCRIPTION	DRAWN	CHECKED	DATE

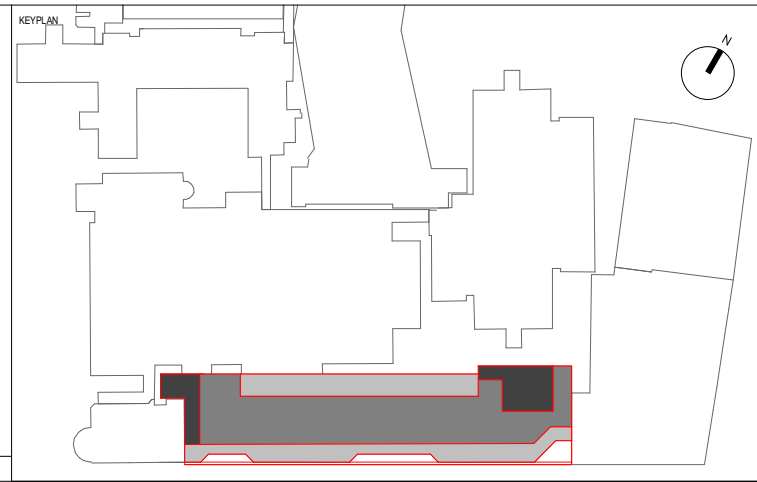

CONTRACTOR

BLISS SISK
CONTRACTORS

John Sisk & Son Ltd
2410 Regents Court
The Crescent
Birmingham Business Park
Birmingham

B37 7YE

DESIGN LEAD

BDP.

16 Brewhouse Yard
Clerkenwell
London
EC1V 4LJ
United Kingdom

T +44 (0)20 7812 8000
www.bdp.com

PROJECT TITLE			PROJECT NUMBER	
GOSH Children's Cancer Centre			P2007598	
Planning - Level 09 plan as Proposed				
DRAWING NO:				
GOSHCCC-BDP-ZZ-09-DR-A-2000-2069				
ISSUANCE/REVISION		DATE	REVISION/DATE	REVISION/DATE
S2 - For Information		1 : 200	@ A1	07/10/2022
DRAWN BY	CHECKED BY	APPROVED BY	REVISION	
AF	MB	BZ	Planning	P02