

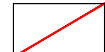







Legend:

-  Indicative Site Boundary
-  Category A Trees (Stem and Canopy Spread)
-  Category B Trees (Stem and Canopy Spread)
-  Category C Trees (Stem and Canopy Spread)
-  Category U Trees (Stem and Canopy Spread)
-  Root Protection Area
-  Existing Site

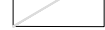
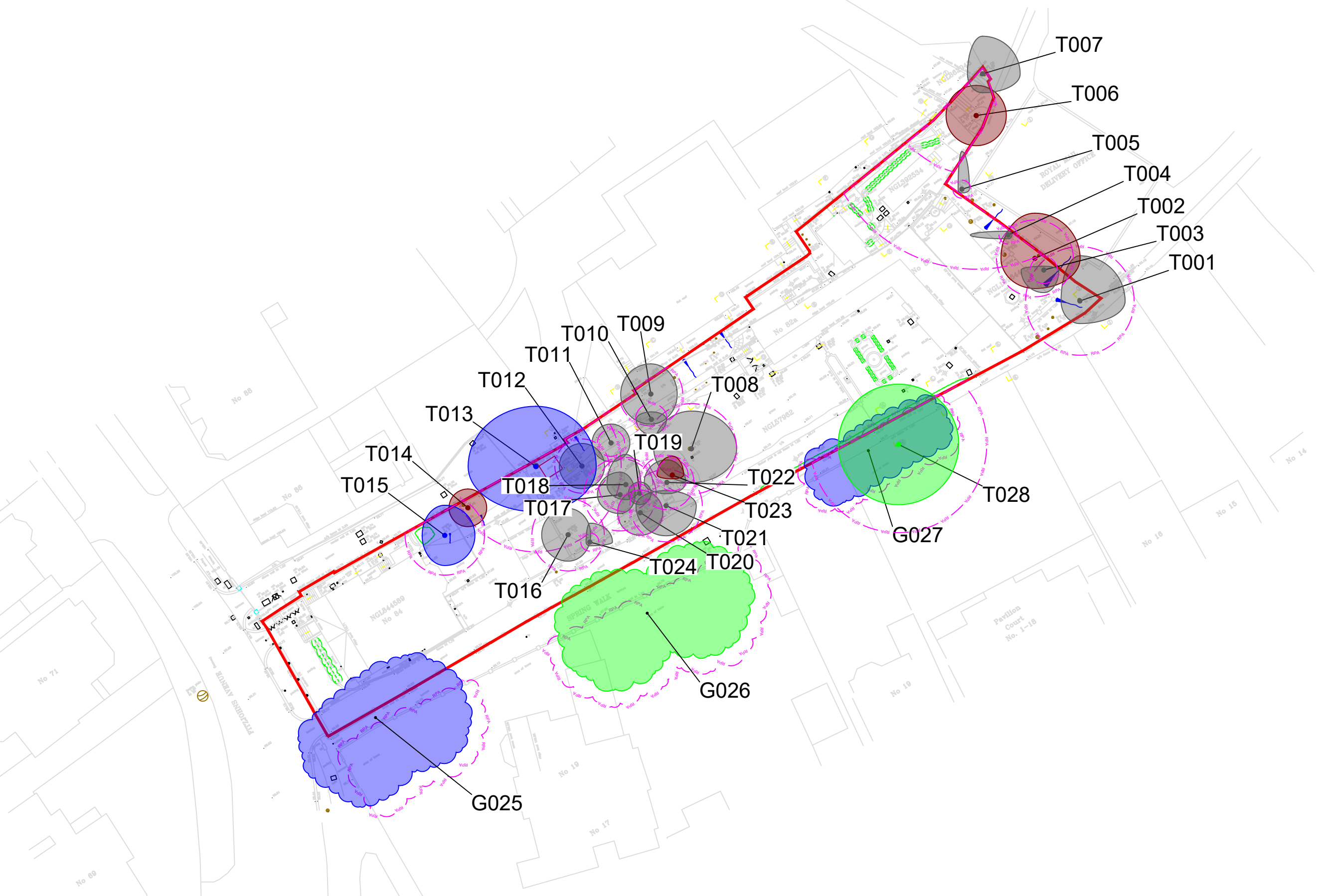

Notes:
 - The site is located in Fitzjohns Netherhall Conservation Area.
 - The RPAs of the following trees have been adjusted based on existing built form/topography; T6, T7, T9, T13, T15, G25, G26, G27 & T28.
 - Site construction works of the existing planning consent (Camden Council Ref: 2021/1787/P) have commenced.

CLIENT:	Charlton Brown Architects	
PROJECT/SITE:	82 Fitzjohns Avenue	
TITLE:	Tree Constraints Plan	
MAP REF:	155-FIT-DRW-TCP	
REVISION:	01	
LAYOUT:	Overview	
DATE:	16.09.2022	PRODUCED BY: SW
SCALE:	1:500@A3	REVIEWED BY: -

The original of this drawing was produced in colour - a monochrome copy should not be relied upon.

