

Waste storage to be included within each kitchen

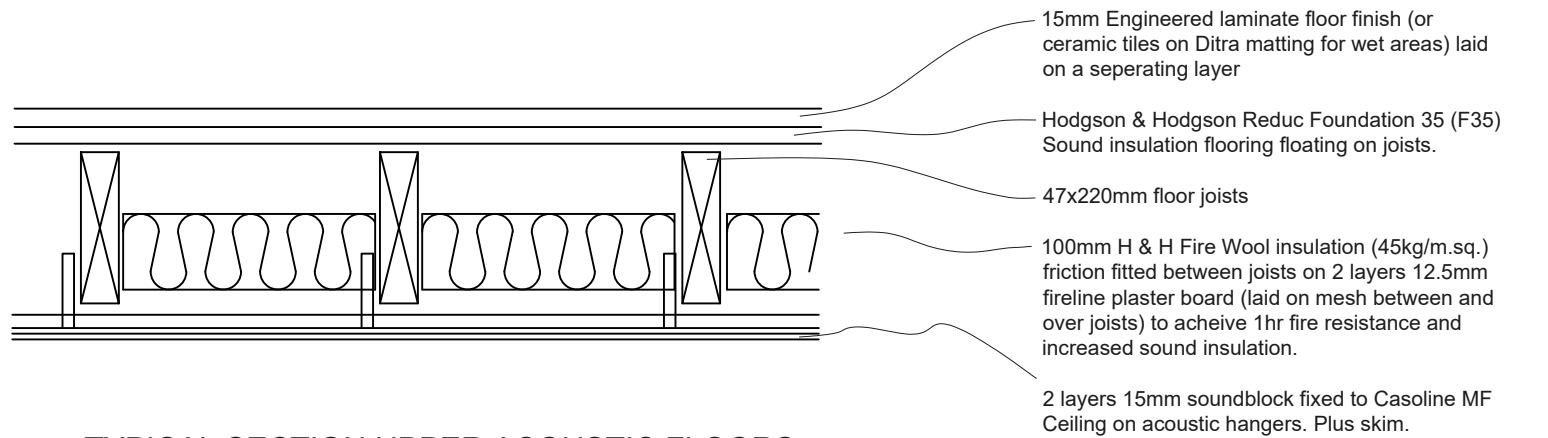

TYPICAL SECTION UPPER ACOUSTIC FLOORS

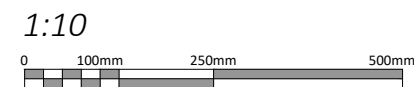
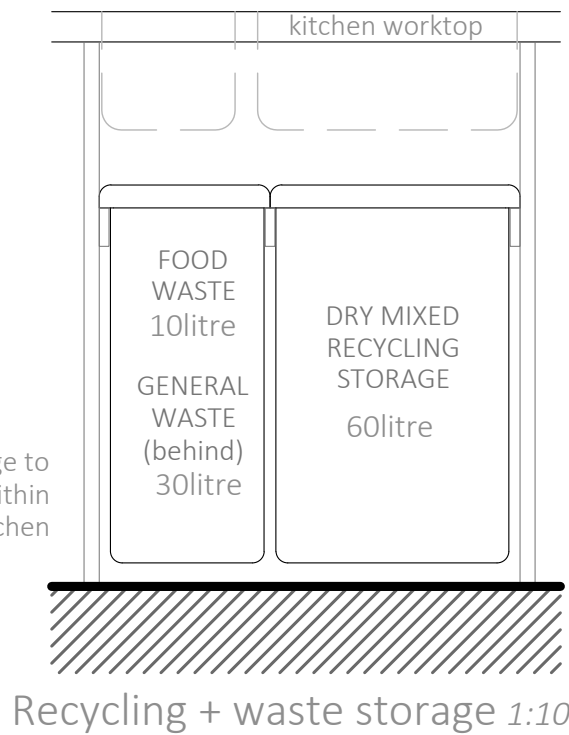
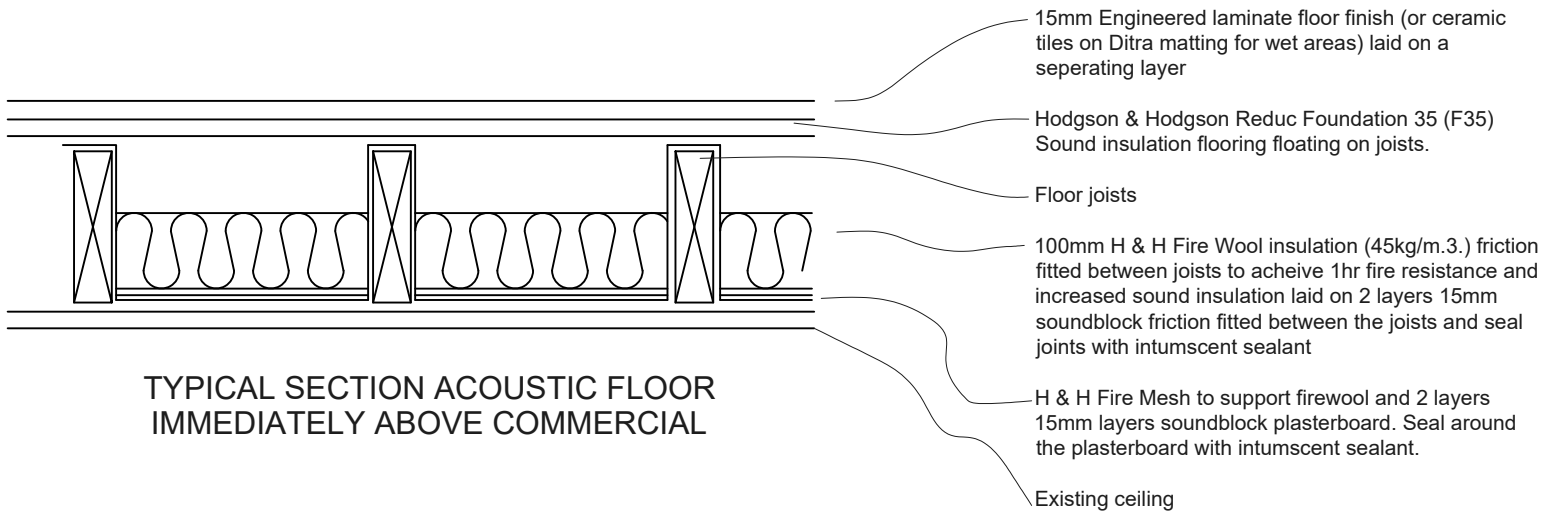

TYPICAL SECTION ACOUSTIC FLOOR IMMEDIATELY ABOVE COMMERCIAL

NOTE, ALL FLOORS:
TO ACHIEVE 60MIN FIRE PROTECTION
TO CONFORM TO THE REQUIREMENTS OF BUILDING
REGULATIONS FOR ACOUSTIC AND FIRE SEPARATION.

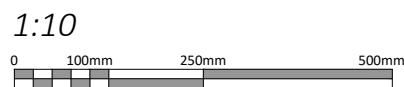

Disclaimer and Notes
Do not scale this drawing. All dimensions should be checked on site. Any discrepancy found between this drawing, site and any other document should be referred immediately to Fresson and Tee. All drawings should be read in conjunction with all other contract documents and specifications and all other consultants drawings.

Copying or reproduction of this drawing without the written permission of Fresson and Tee is not permitted. Copyright is Reserved

The PDF hard copy accompanying the CAD data is legal transmission of information. The electronic copies are issued only for convenience of use and need of original file. No liability for the accuracy or for any consequence resulting from the use, additions or alteration of information is accepted by Fresson and Tee

Title plan at 1:1250 and North point is up



P1	CM	Planning Issue	08.09.2022
Rev	Iss.	Description	Date

DRAWING TITLE

Kitchen Waste Storage
&
Typical Floor Details

PROJECT NAME
Residential Conversion of
Upper Parts and Alterations
to the Public House & Sui
Generis Use

ADDRESS
The Wheatsheaf
25 Rathbone Place
London W1T 1JB
CLIENT
Shaftesbury CL Ltd

DRAWN BY
CM

CHECKED BY

JOB NO.
25446

SCALE
1:10@A3

DATE
Apr 2022

DRAWING NO.
A-501-P1



SECTION A-A
as Existing

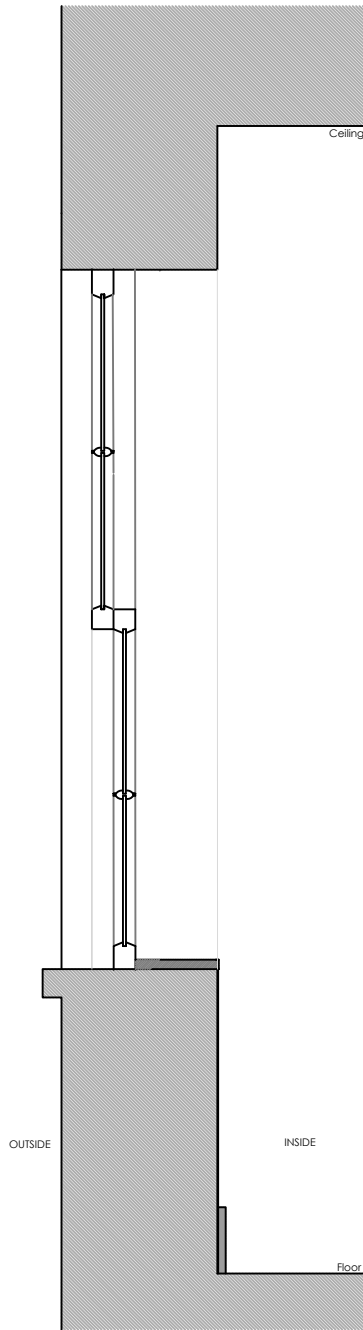

EXISTING SECTION
DETAIL THROUGH EXTERNAL WALL

General Notes:
Exact profiles and replicas to be copied on-site
using identical moulds/studies to match.
All techniques, materials and finishes to carefully
match the existing present.

SECTION A-A
as Proposed

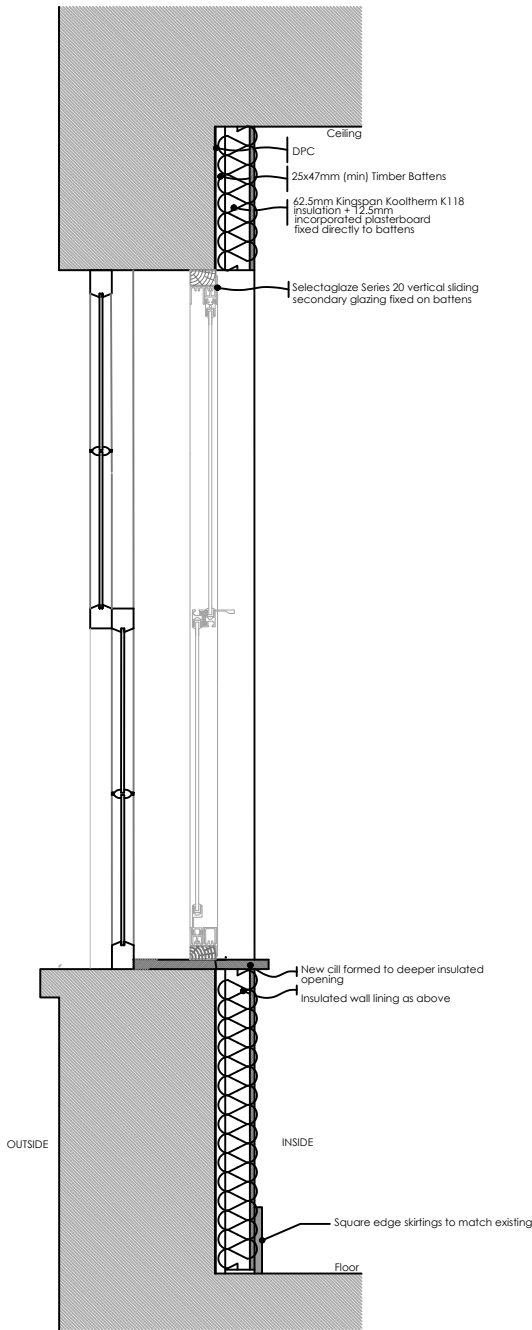

PROPOSED SECTION
DETAIL THROUGH EXTERNAL WALL

SECTION B-B
as Existing

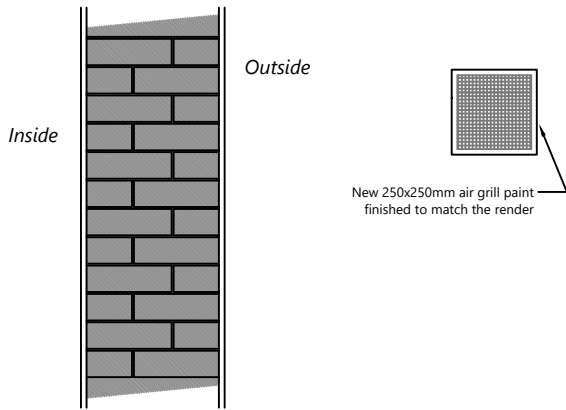

SECTION B-B
as Proposed

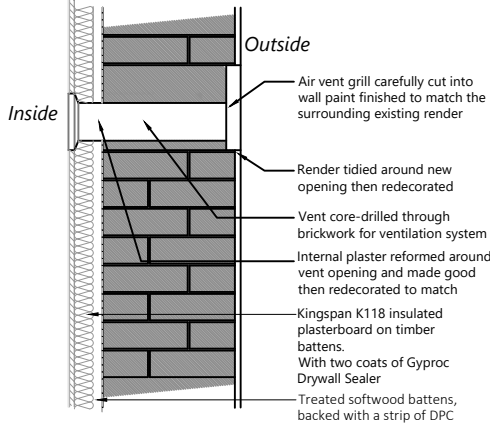

Disclaimer and Notes
Do not scale this drawing. All dimensions should be checked on site. Any discrepancy found between this drawing, site and any other document should be referred immediately to Fresson and Tee. All drawings should be read in conjunction with all other contract documents and specifications and all other consultants drawings.
Copying or reproduction of this drawing without the written permission of Fresson and Tee is not permitted. Copyright is Reserved.
The PDF hard copy accompanying the CAD data is legal transmission of information. The electronic copies are issued only for convenience of use and repeat of original file. No liability for the accuracy or for any consequence resulting from the use, additions or alteration of information is accepted by Fresson and Tee.
Title plan at 1:1250 and North point is up

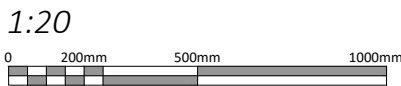
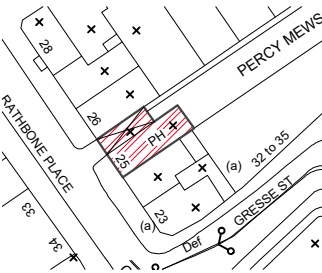

P1	CM	Planning Issue	08.09.2022
Rev	Iss.	Description	Date

DRAWING TITLE

Secondary Glazing Detail
&
External Vent Detail

PROJECT NAME
Residential Conversion of
Upper Parts and Alterations
to the Public House & Sui
Generis Use

ADDRESS
The Wheatsheaf
25 Rathbone Place
London W1T 1JB
CLIENT
Shaftesbury CL Ltd

DRAWN BY
CM

CHECKED BY

JOB NO.
25446

SCALE
1:20@A3

DATE
Apr 2022

DRAWING NO.
A-502-P1

