

1 Eight Floor - Proposed
1:100

Legend:

- Proposed Partition Locations
- Proposed flexible partition locations. (Minimum laboratory width = 3 meters)
- Drainage Positions - Proposed drainage penetrations in slab
- Ramps - Proposed 'illustrative' location of transition in level from slab to raised access floor. Location dependent on final tenant fit out.

Note:

For all items being removed, please refer to demolition drawings 21593-0340 - 0356

Existing services in modernised areas to be altered, refer to services consultant drawings and reports for details.

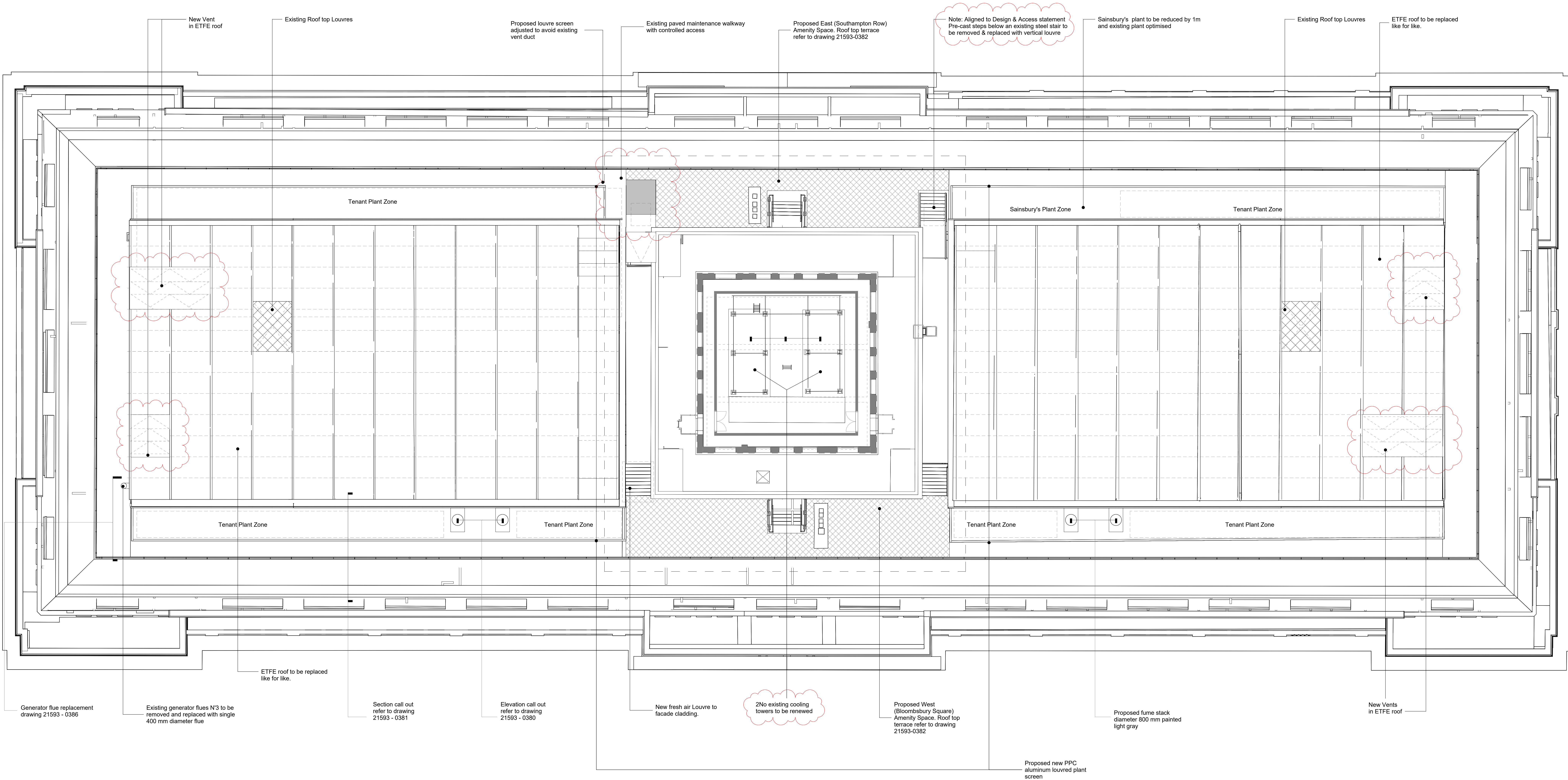

1 Roof - Proposed
1 : 100

Proposed Partition Locations
Proposed flexible partition locations. (Minimum laboratory width = 3 meters)
Drainage Positions - Proposed drainage penetrations in slab
Ramps - Proposed 'illustrative' location of transition in level from slab to raised access floor. Location dependent on final tenant fit out.

Note
For all items being removed, please refer to demolition drawings 21593-0340 - 0356
Existing services in modernised areas to be altered, refer to services consultant drawings and reports for details.

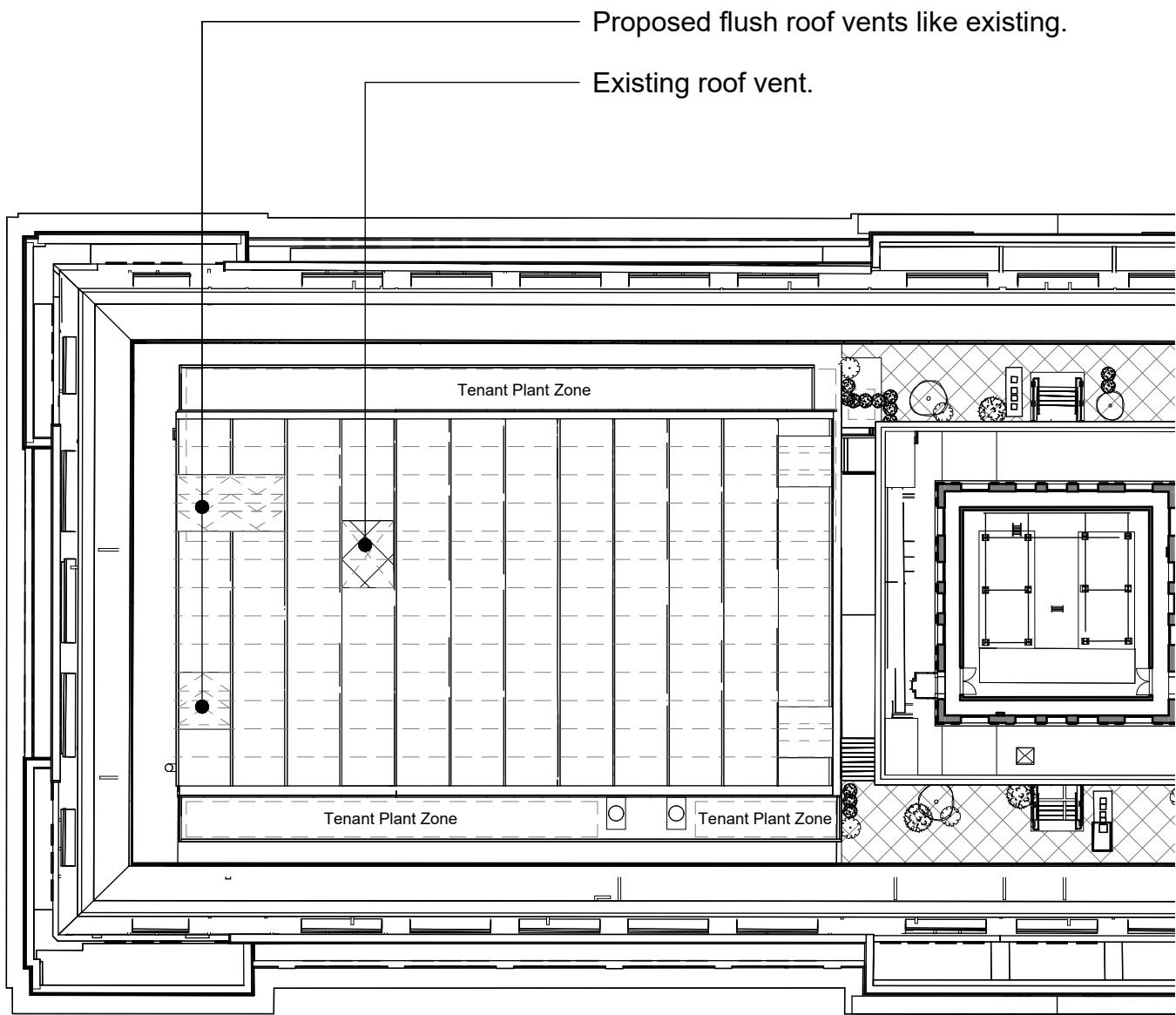

1 Roof - North end
1 : 350

The copyright of this drawing is vested with Corstorphine & Wright Ltd and must not be copied or reproduced without the consent of the company.

P-01	PLANNING REVISED	29/09/2022	TI	RS
P-00	FOR PLANNING	01/07/2022	RS	ATJ
Rev.	Description	Date	Drw.	Chk.

Client
Oxford Victoria House Ltd.

Project
21593 - Victoria House

Drawing Title
Louvres in Roof

Drawing Status
PLANNING

Corstorphine & Wright

London Studio
One Mortimer Street, London, W1T 3JA
020 7842 0820
corstorphine-wright.com

Drawing No. 21593-CWA-VH-A-0383				Revision P-01
Drawn TI	Checked RS	Paper Size A3	Scale 1 : 350	Date 07/21/22