

**Stems:** 1

**Location:** London Zoo

**Site:** LZ 25 - St. Mark's Bridge

**Position:**

**Species:** Ulmus sp ( Elm)

**Owner:** The Royal Parks

**Grid Ref:** 528263.12, 183674.57

---

**Inspection Only: 14/10/2022**

**Height:** 1.5-7.0 metres

**Age:** Semi-mature

**Trunk:** 90 mm

**Spread:** Up to 3 meters

**Features:**

**Conditions:** Dead

**Priority:** 1 - Very high

**Visited By: HOR**

**Failure:** Probable/Soon

**Target:** Very High

**Impact:** Medium 35-10

**Authority:** Camden

**Recommendations:** Fell to ground

**Works:**

**Comments:** Complete work by 11/11/2022.

---

**Stems:** 1

**Location:** London Zoo

**Site:** LZ 25 - St. Mark's Bridge

**Position:**

**Species:** Ulmus sp ( Elm)

**Owner:** The Royal Parks

**Grid Ref:** 528263.50, 183675.25

---

**Inspection Only: 14/10/2022**

**Height:** 1.5-7.0 metres

**Age:** Semi-mature

**Trunk:** 90 mm

**Spread:** Up to 3 meters

**Features:**

**Conditions:** Dead

**Priority:** 1 - Very high

**Visited By: HOR**

**Failure:** Probable/Soon

**Target:** Very High

**Impact:** Medium 35-10

**Authority:** Camden

**Recommendations:** Fell to ground

**Works:**

**Comments:** Complete work by 11/11/2022.

---

**Stems:** 1

**Location:** London Zoo

**Site:** LZ 25 - St. Mark's Bridge

**Position:**

**Species:** Ulmus sp ( Elm)

**Owner:** The Royal Parks

**Grid Ref:** 528261.87, 183675.42

---

**Inspection Only: 14/10/2022**

**Height:** 1.5-7.0 metres

**Age:** Semi-mature

**Trunk:** 90 mm

**Spread:** Up to 3 meters

**Features:**

**Conditions:** Dead

**Priority:** 1 - Very high

**Visited By: HOR**

**Failure:** Probable/Soon

**Target:** Very High

**Impact:** Medium 35-10

**Authority:** Camden

**Recommendations:** Fell to ground

**Works:**

**Comments:** Complete work by 11/11/2022.

---

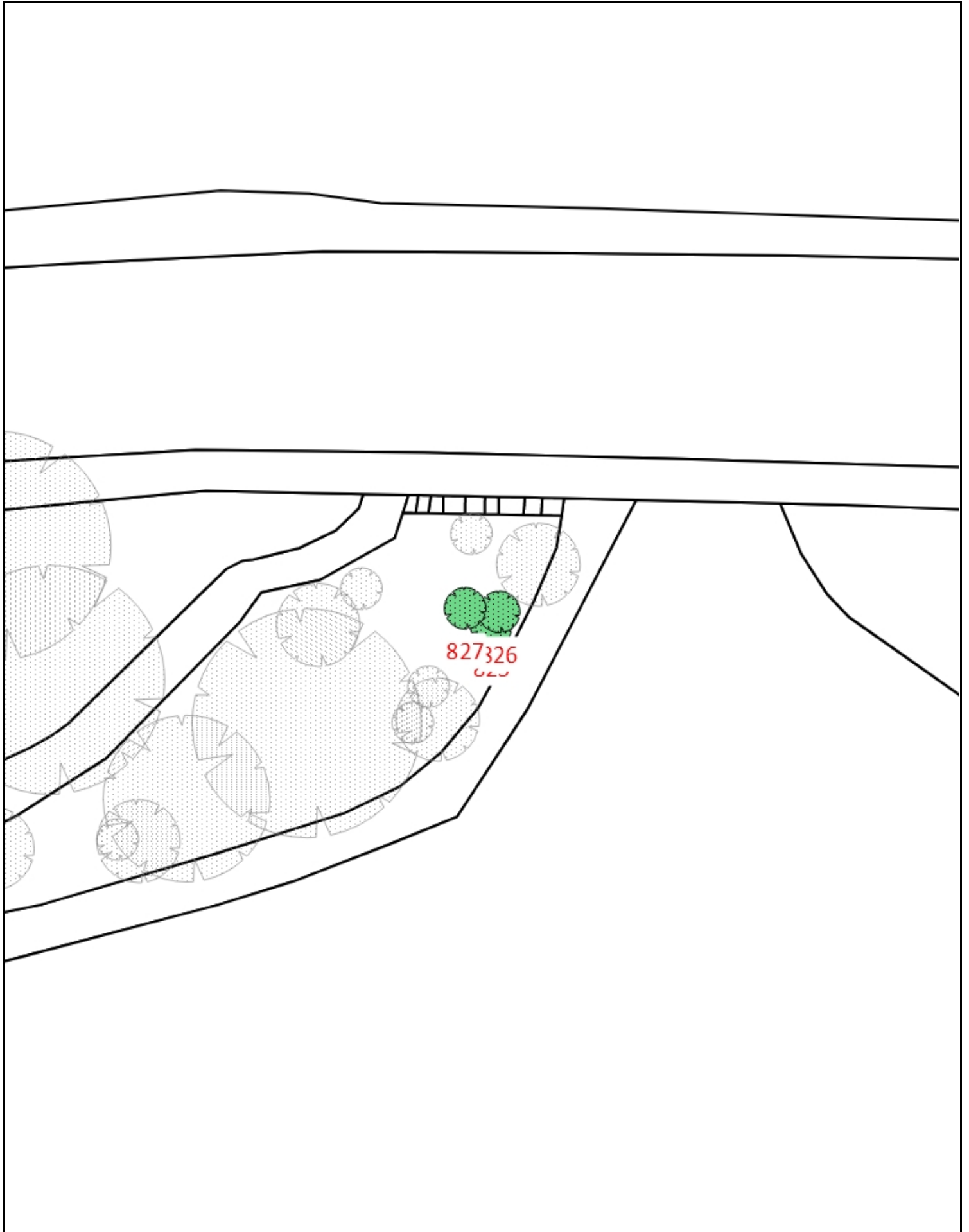

827326  
 623

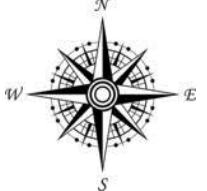
	<b>LZ 25 - St. Mark's Bridge</b>	<b>Scale</b>	<b>1: 232</b>	
		<b>Date</b>	<b>17/10/2022</b>	