

date: OCTOBER 2022
 scale: 1:100 @ A3
 job: CHETWYND ROAD
 drawing: PROPOSED
 LOFT PLAN
 number: **189 012**
 revision: P02
 drawn: AW
 checked: PdA

GENERAL NOTES:

1. DO NOT SCALE FROM THIS DRAWING, EXCEPT FOR PLANNING PURPOSES
 2. ALL DIMENSIONS AND LEVELS TO BE CHECKED ONSITE
 3. ALL STRUCTURAL ELEMENTS TO STRUCTURAL ENGINEER'S SPECIFICATION AND DETAILS
 4. ALL DETAILS TO MANUFACTURERS SPECIFICATION AND DETAILS
 5. DRAWINGS TO BE READ IN CONJUNCTION WITH SCOPE OF WORKS T01
 6. ALL DETAILS SUBJECT TO BUILDING CONTROL APPROVAL
 7. ALL DETAILS SUBJECT TO PARTY WALL AWARD
 8. BOUNDARY LINES SHOWN ARE INDICATIVE AND TO BE CONFIRMED BY CLIENT
 9. ISSUE NOT FOR CONSTRUCTION
- ©2022 - MAY NOT BE REPRODUCED WITHOUT PERMISSION

revision	date	details
A	16.06.22	first thoughts
B	13.07.22	updated options
C	29.07.22	dimensions added
P01	05.08.22	planning application
P02	17.10.22	amendments to side return

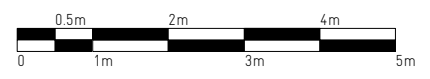
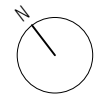
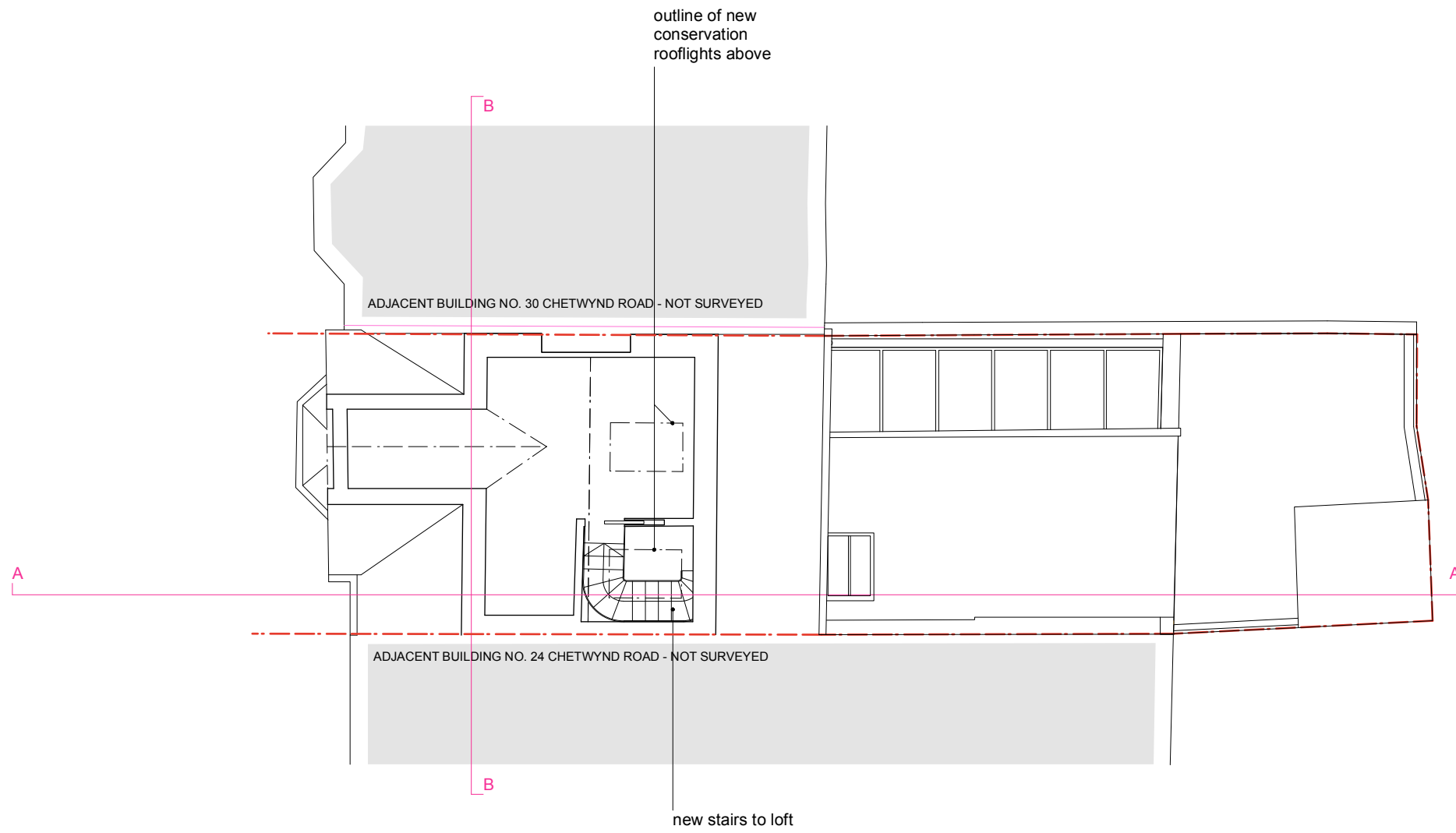

RUSSIAN FOR FISH

14 the stables
 16 pixley street
 london e14 7df
 studio@russianforfish.com
 020 8895 6536