

TORRINGTON PLACE

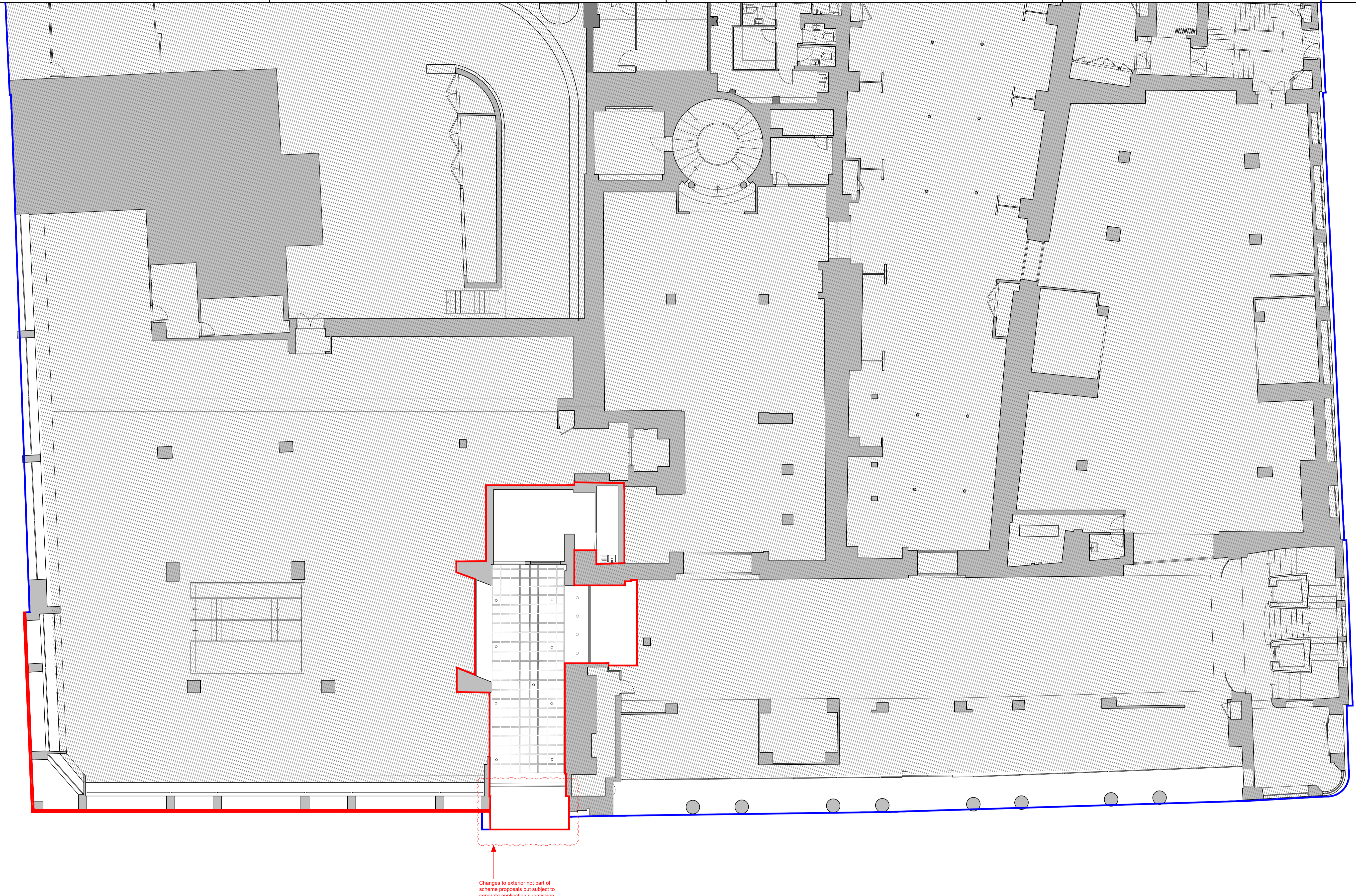

TOTTENHAM COURT ROAD

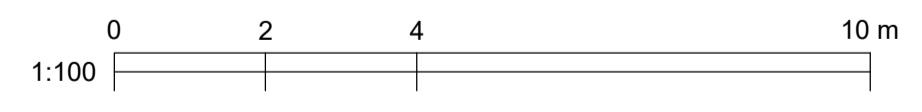

KEY
Site ownership boundary
Phase 3A boundary
Area outside of scope of works

REV	DATE	DESCRIPTION	NOTES
01	12/08/2022	PLANNING ISSUE	
02	05/10/2022	UPDATED PLANNING ISSUE	

CLIENT: GENERAL PROJECTS	NOTE
PROJECT MANAGER & QS: QUARTZ PROJECT SERVICES	<p>1. Do not scale form this drawing. 2. All dimensions to be checked on site by the contractor and such dimensions to be their responsibility. 3. Report all drawings errors, omissions, and discrepancies to the architect. 4. This document may be issued in an uncontrolled CAD format to enable others to use it as background information to make alterations and/or additions. In that instance the file will be accompanied by a PDF version. It is for those making such alterations and additions to ensure that they make use of current background information. WRA Ltd Accepts no liability for any such alterations or additions to the background information or arising out of changes to background information which occur prior to alterations or additions being made.</p>
M.E.P ENGINEER: WATERMANS	
STRUCTURAL ENGINEER: WEBB YATES	
FIRE ENGINEER: DESIGN FIRE CONSULTANTS	
PLANNING CONSULTANT: TURLEY	
CDM CONSULTANT: BRIAN BULFIN ASSOCIATES	
APPROVED INSPECTOR: SOCOTEC	

LOCATION	THE HEAL'S BUILDING	WHITE RED ARCHITECTS
196 TOTTENHAM COURT LONDON W1T 7LQ	45 Charlotte Road London EC2A 3PD	TEL: 020 7859 4521 white:red.co.uk
	PROJECT NAME:	The Heals Building - Phase 3A
	DRAWING TITLE:	Existing - Ground Floor RCP
	DRAWN: SE	CHECKED: JJ
	SCALE @A1: 1:100	STATUS: PLANNING
	PROJECT NO: 5436	ZONE: -
	TYPE: -	SHEET NO: PL_01_110
		REVISION: 02

NOT FOR CONSTRUCTION