

All dimensions are in mm unless otherwise stated  
 All dimensions to be verified on site before proceeding with the work  
 Any discrepancies to be notified in writing to Architect immediately  
 All boundaries indicative only and to be confirmed by others

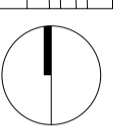
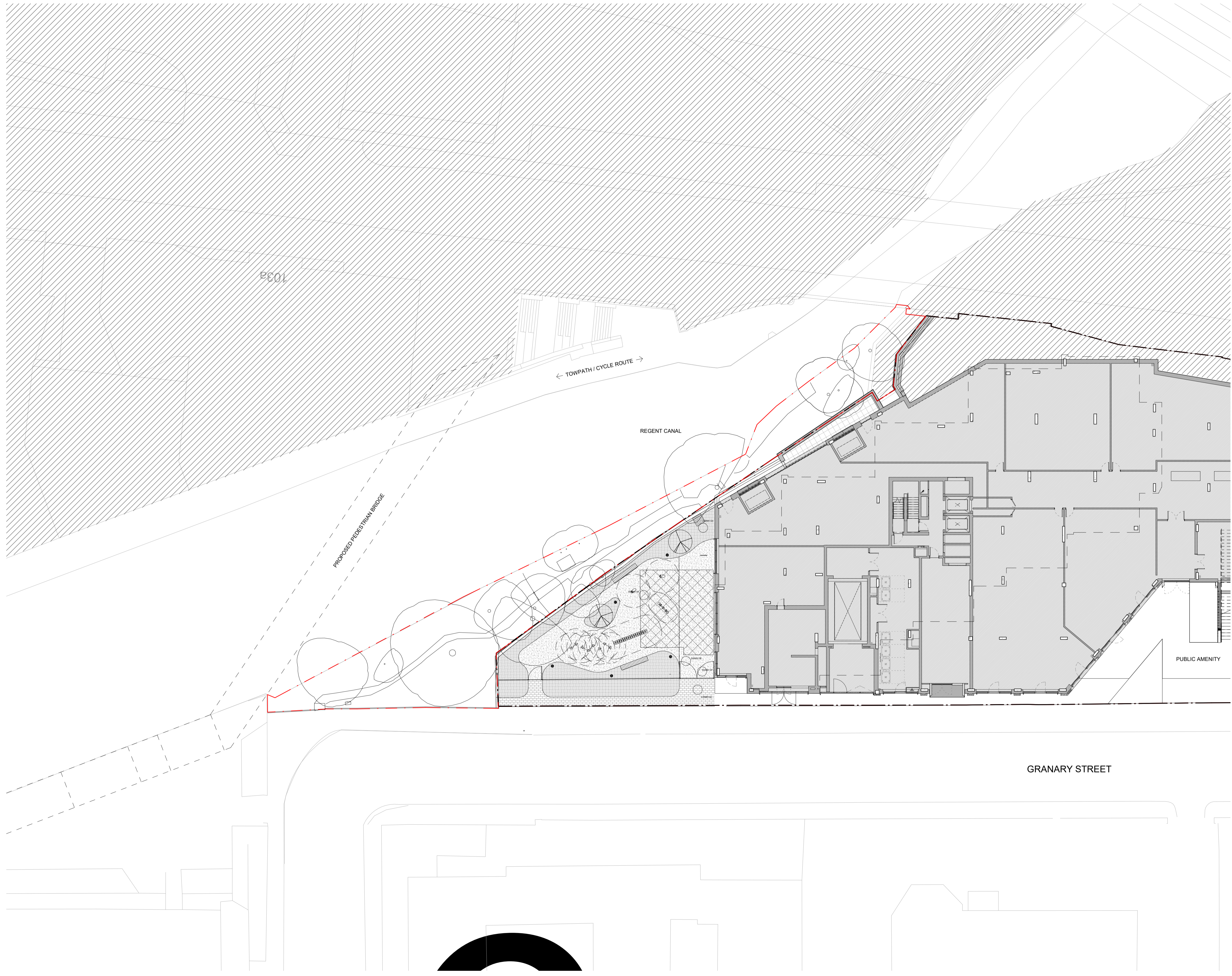

- Key**
- Boundary
  - Planning Submission Boundary
- Commercial Notes**
- Internal layouts shown indicatively

REV	DATE	NOTES	TW	INT
-	12.09.22	First Issue		

**PLANNING**

**HUTCHINSON & PARTNERS**

3.12 The Record Hall, 16-16A Baldwin's Garden, London, EC1N 7RJ  
 t. 020 3176 8192 e. info@hutchinsonsandpartners.com w. www.hutchinsonsandpartners.com

**JOB TITLE**  
 101 Camley Street, Camden

**DRAWING TITLE / LOCATION**  
 Existing Site Plan

<b>DRAWN BY</b>	<b>CHECKED</b>	<b>SCALE</b>	<b>STATUS</b>
JH	TW	1:200 @ A1 / 1:400 @ A3	PLANNING
<b>PROJECT</b>	<b>DRAWING NO</b>	<b>REVISION</b>	
18014	01 AP 0010 101	-	

**CLIENT**

Camley Street SÁRL

© 2022 HUTCHINSON & PARTNERS Limited

