

No Extension & Coupler

Extension & Coupler

Please Note : Trickle Vents For Illustrative Purposes Only

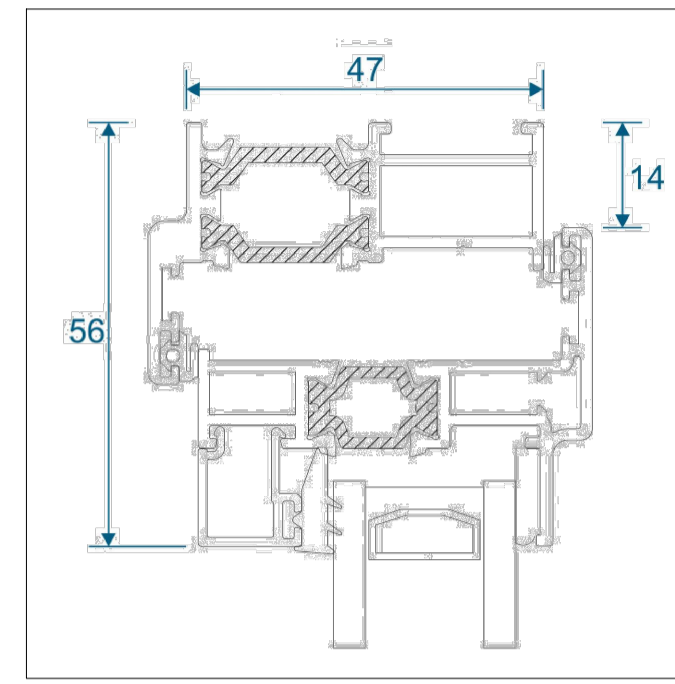

Section F-F Opener

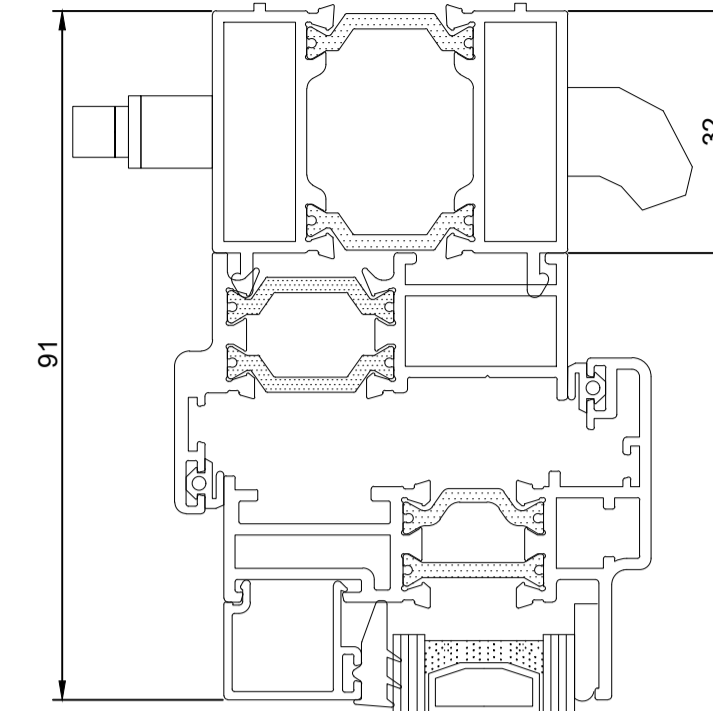

Section F-F Opener

REFER TO SECTION F-F IF
EXTENSION COUPLER
DETAIL REQUIRED

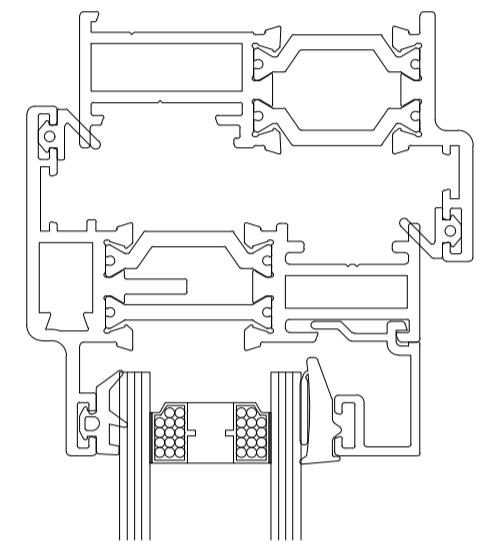

Section 32

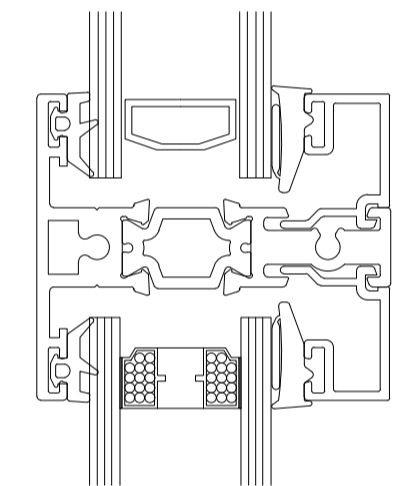

Section 33

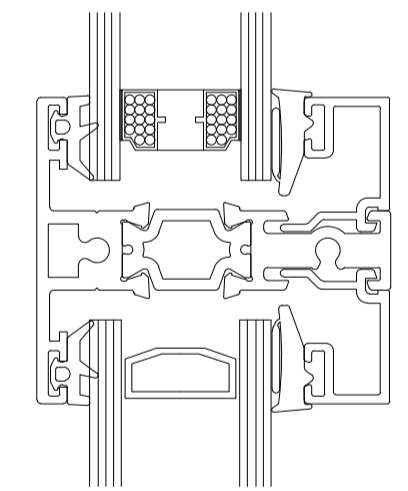

Section 34

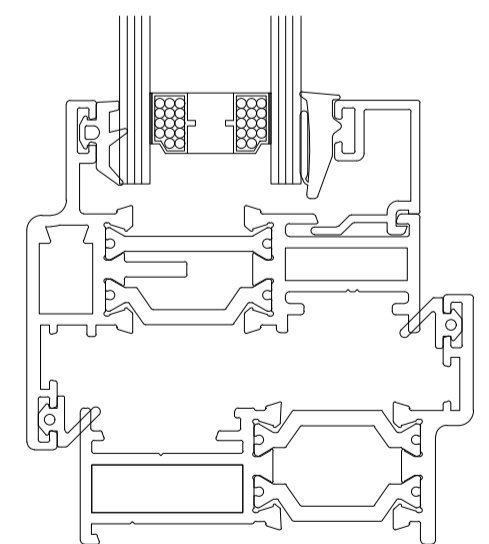

Section 35

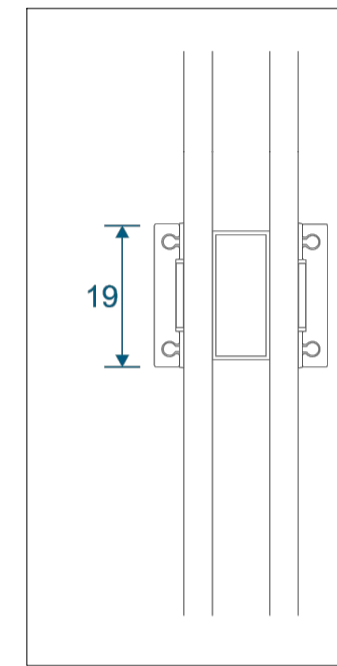

Astragal bar

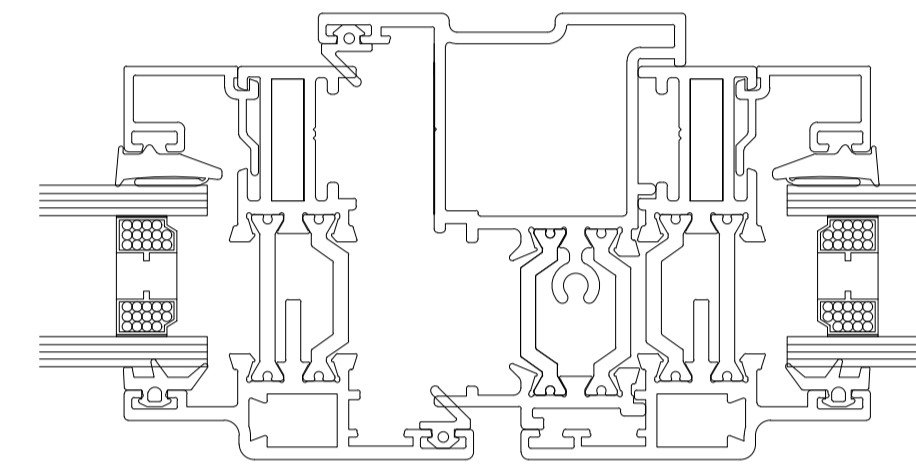

Section 36

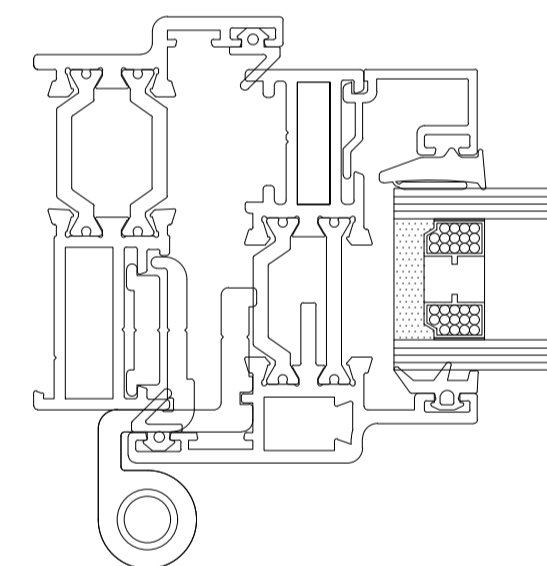

Section 37

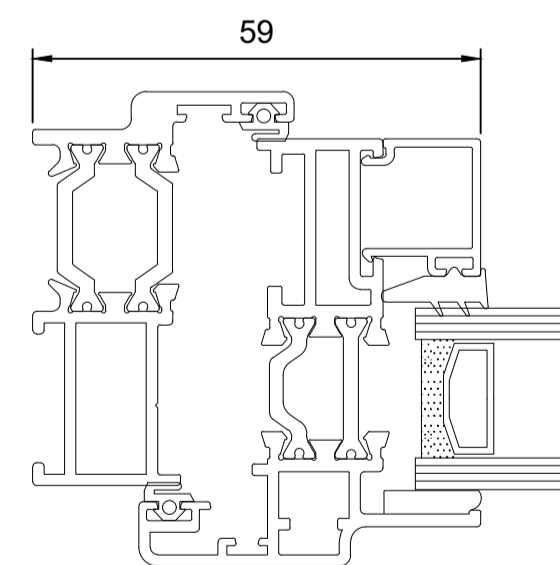
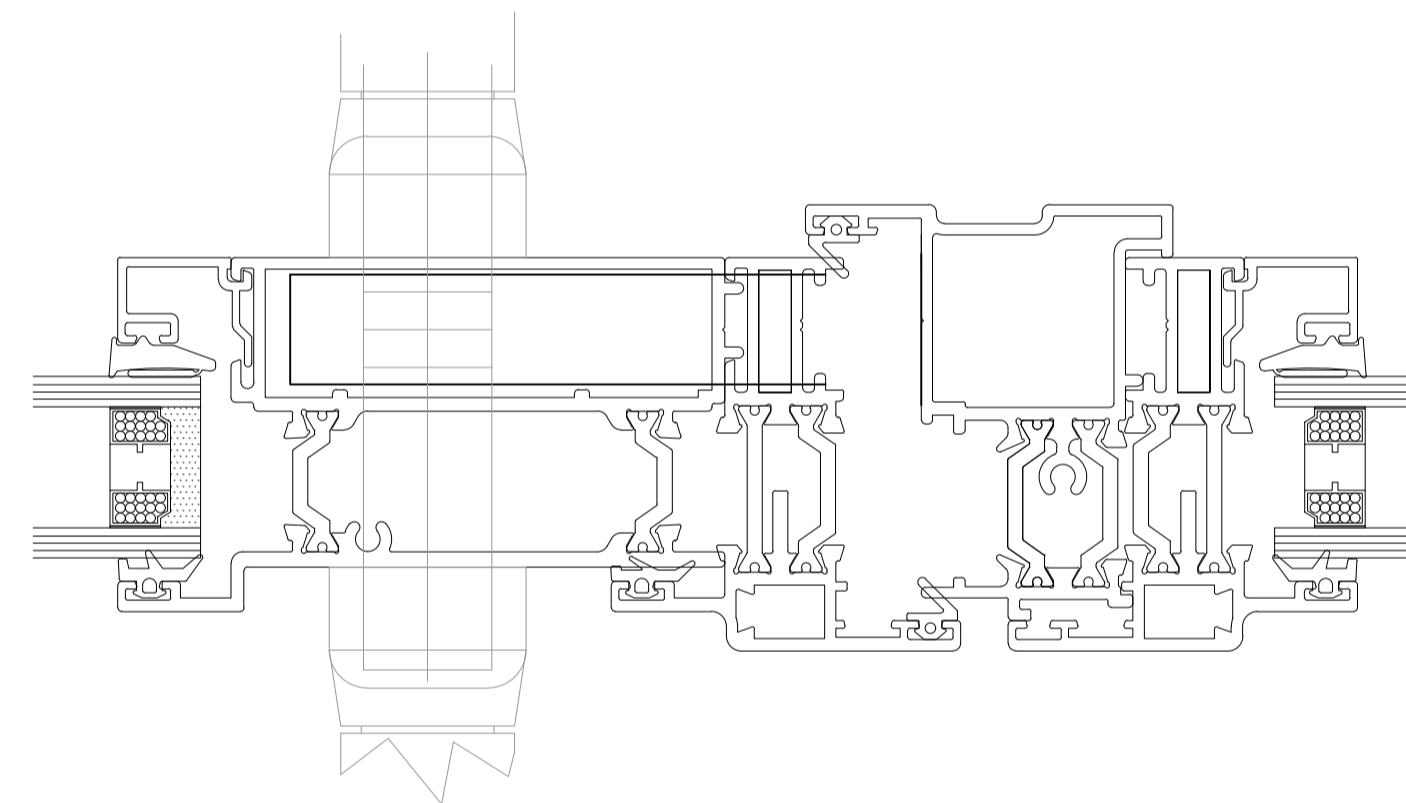

Section A-A

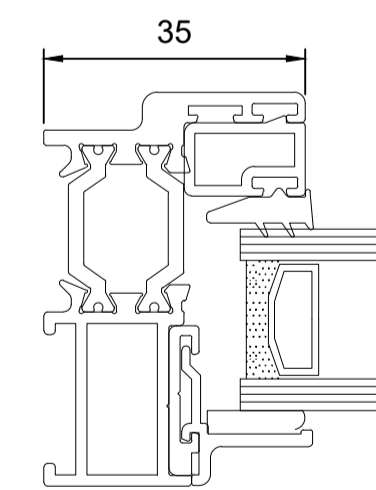

Section B-B

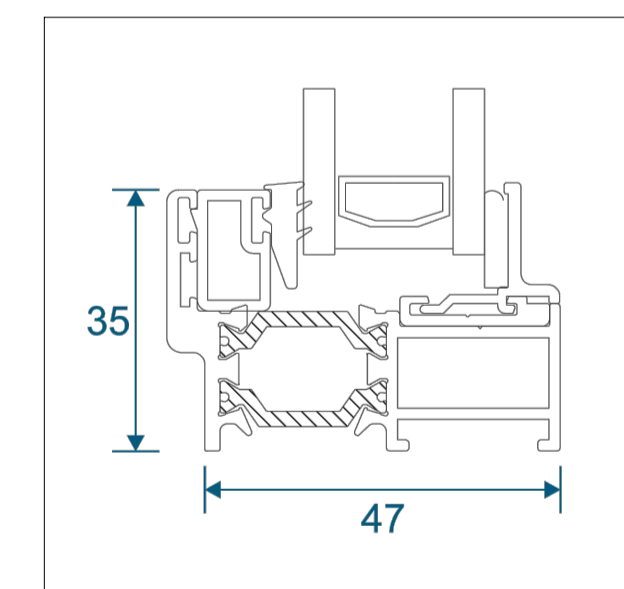

Section D-D

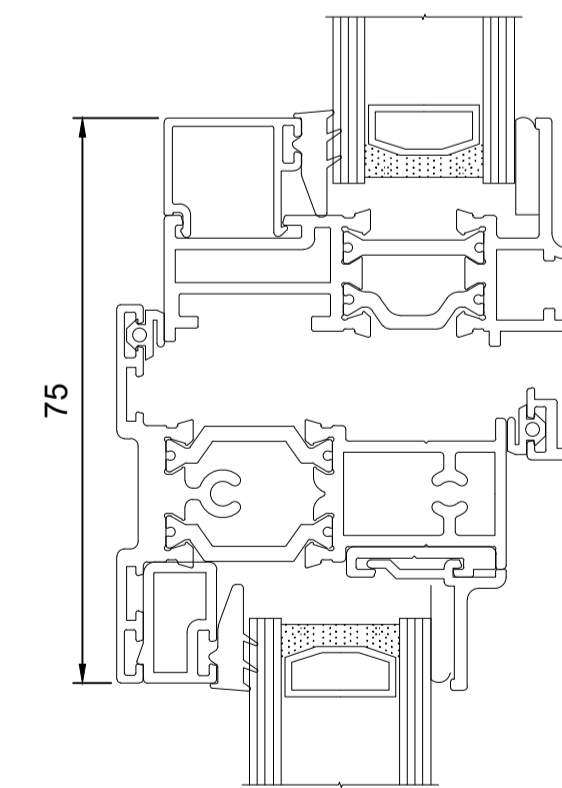

Section K-K

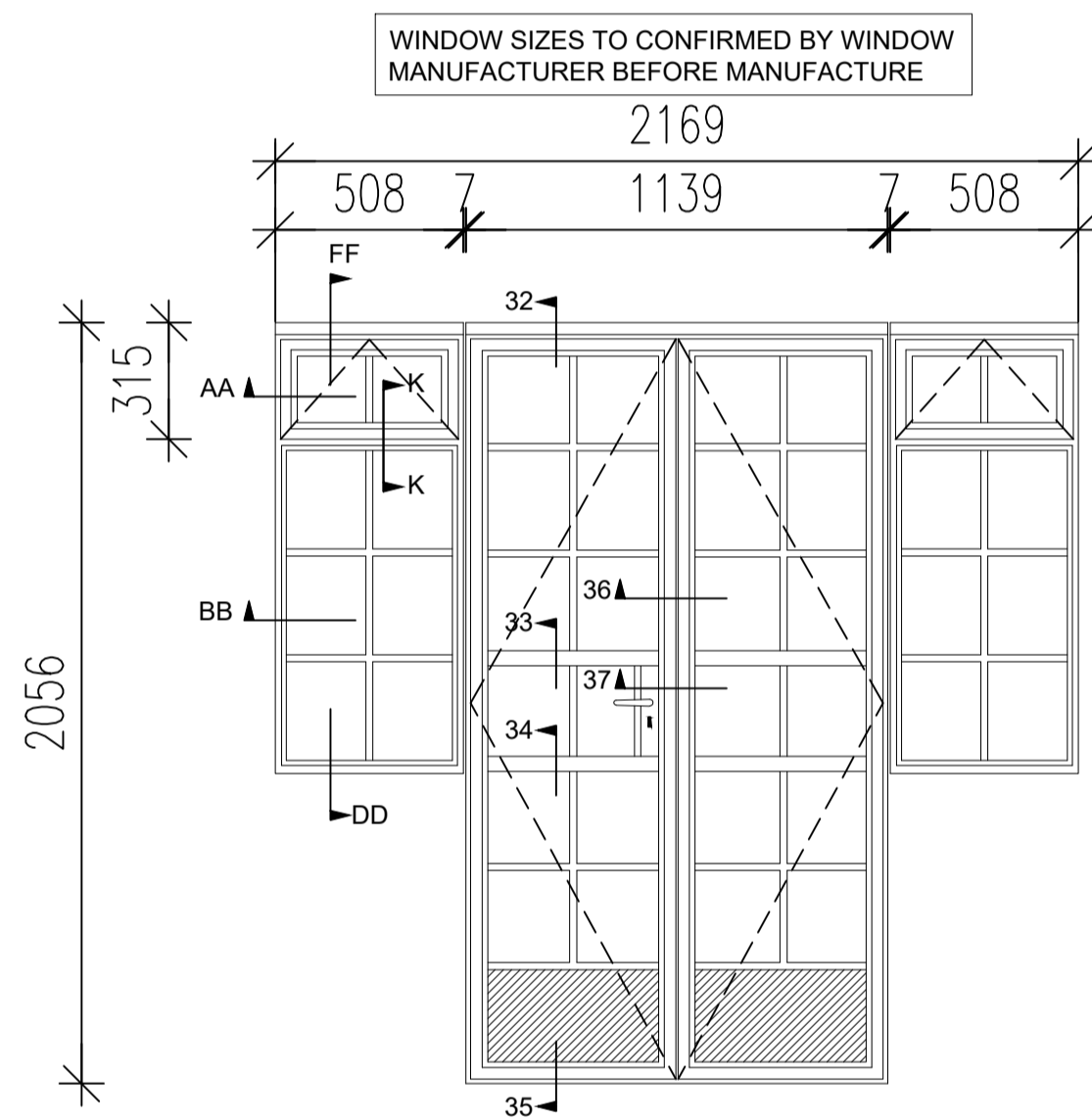

PROPOSED WINDOW/FRENCH DOOR - SCALE 1:20
MANUFACTURED BY DURATION WINDOWS

WINDOW STYLE IS INDICATIVE ONLY. TO BE
CONFIRMED BY WINDOW MANUFACTURER

Revisions:

Scale Check:

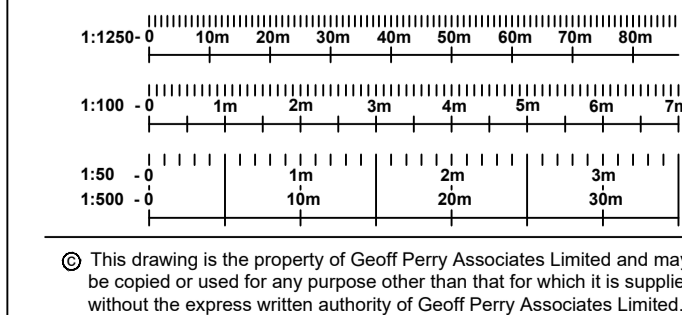

Client: Russell Court (Bloomsbury)
Management Limited

Project: Russell Court, Upper Woburn Place,
London

Title: Proposed French Door Detail

Date: Nov. 2020 **Scale:** 1:1 &
1:20 @ A1

Drawn by: GPA **Checked by:** ~

Job No. A 191 **Drg No.** 154 **Rev.** ~

Geoff Perry Associates Limited
The Shrubbery, 28 Erdington Road,
Aldridge, Walsall, WS9 8UH
enquiries@geoffperryassoc.co.uk
t: 01922 744 900

The Contractor is to check and verify all building and site dimensions, levels and sewer invert levels at connection points before work starts. The Contractor is to comply in all respects with current Building Legislation, British Standard Specifications, Building Regulations, Construction (Design & Management) Regulations, Party Wall Act, etc. whether or not specifically stated on this drawing. This drawing must be read with and checked against any structural, geotechnical or other specialist documentation provided. This drawing is not intended to show details of foundations, ground conditions or ground contaminants. Each area of ground relied upon to support any structure depicted (including drainage) must be investigated by the Contractor. A suitable method of foundation should be provided allowing for existing ground conditions. Any suspect or fluid ground, contaminants on or within the ground, should be further investigated by a suitable expert. Any earthwork constructions shown indicate typical slopes for guidance only & should be further investigated by a suitable expert. All trees are to be retained where existing trees are to be retained they should be subject to a full Arboricultural Inspection for safety. All trees are to be planted so as to ensure they are a minimum of 5 metres from buildings and 3 metres from drainage and services. A suitable method of foundation is to be provided to accommodate the proposed tree planting. Geoff Perry Associates Limited do not accept any responsibility for any losses (financial or otherwise) to any Client or third party arising out of the Clients (be it Developer or Contractor but not limited thereto) non-compliance with above mentioned provisions.