

01 Existing Site Location Plan
1:1250

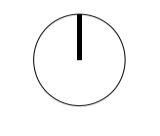

02 Existing Site Plan
1:500

Notes
This drawing is copyright Piercy&Company.
Do not scale from this drawing.
All dimensions and levels to be checked on site by the contractor and such dimensions to be his responsibility.
Report all drawing errors, omissions and discrepancies to the architect.
DISCLAIMER
This document may be issued in an editable digital CAD format to enable others to use it as background information to make alterations and/or additions. In that instance the file will be accompanied by a PDF version as a record of the original file. It is for those parties making such alterations and/or additions to ensure that they make use of current background information.
Piercy&Company accepts no liability for either: any such alterations and/or additions to the background information by others; or any other changes made by others to the architectural content of the background information itself.

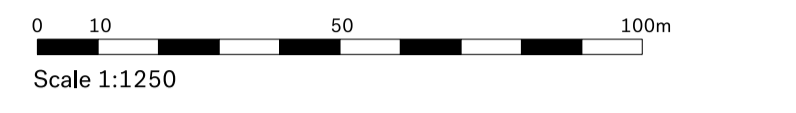

- Proposed Building footprint
- Planning Application Site Extent

Rev	Date	Description

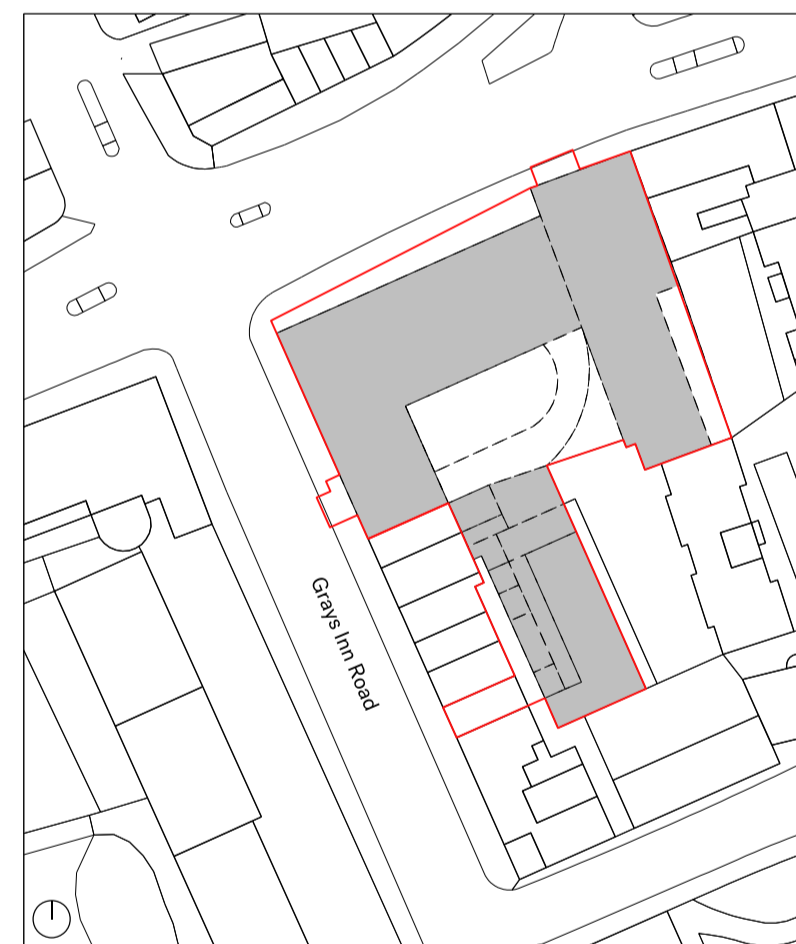

Project
100 & 88 Gray's Inn Road / 127 Clerkenwell Road

Client
Lawnmist Ltd

Date
30.09.2022

Scale
As indicated @A1

Drawing Title

Existing Site Location Plans		
Drawn	Checked	Approved
KC	YH	DC

Drawing Status						
Project	Disc	Zone	Level	Series	Drg No.	Rev.
13636	A	ZZ	-	03	100	-

The Centro Building
39 Plender Street
London NW1 0DT
Telephone
+44 (0)207429611

info@piercyandco.com
www.piercyandco.com