

NOTES

- TO BE READ IN CONJUNCTION WITH FIRE STRATEGY DRAWINGS SERIES 0402, ACOUSTIC DRAWINGS SERIES 0403, THERMAL DRAWINGS SERIES 0413
- REFER TO 0404 DRAWINGS FOR INTERNAL WALLS SCOPE. FOR INTERNAL CEILING SCOPE REFER TO 0407 DRAWINGS.
- ALL PLASTERBOARD TO RETURN AROUND WINDOWS
- FOR ACCESS PANELS, PLEASE REFER TO M&E DOCUMENTATION. FINAL NUMBER AND LOCATION TO BE CONFIRMED WITH SUBCONTRACTOR. ALL ACCESS PANELS TO BE CONCEALED AND FLUSH. FINISHES TO MATCH ADJACENT SURFACE. DETAILS TO BE DEVELOPED AS PART OF STAGE 4
- ANY VISIBLE SERVICES GOING THROUGH DRYLINING WALLS/ CEILINGS TO SIT FLUSH. DETAILS TO BE DEVELOPED AS PART OF STAGE 4
- WHEN USED IN WET AREAS SUCH AS WC'S, SHOWERS PLEASE USE MOISTURE RESISTANCE BOARD TO MANUFACTURER'S RECOMMENDATION.
- BLOCKWORK PACKAGE TO BE READ IN CONJUNCTION WITH S.E. DOCUMENTATION. FINAL DESIGN BY SUBCONTRACTOR. DETAILS ARE INDICATIVELY ONLY. WINDPOST, MOVEMENT JOINTS LOCATION TO BE COORDINATED WITH S.E. IN STAGE 4.
- FOR PLY PATTERNS & SKIRTING REFER TO XX
- BUILD-UPS & INTERFACE DETAILS SHOWN INDICATIVELY ONLY. SUBCONTRACTOR TO ENSURE IT ACHIEVES THE REQUIRED FIRE, ACOUSTIC & THERMAL PERFORMANCE. SUBCONTRACTOR TO ENSURE ALL DETAILS ARE IN LINE WITH MANUFACTURER'S BROCHURE AND RECOMMENDATION.
- SUBCONTRACTOR TO ENSURE THAT ALL PENETRATION THROUGH WALLS AND FLOORS ACHIEVE THE FIRE PERFORMANCE (INSULATION & INTEGRITY) REQUIRED AS PER THE FIRE STRATEGY.
- ALL BOARDS TO GO FROM SLAB TO SLAB TO ENSURE FIRE, ACOUSTICS AND THERMAL IS ACHIEVED.
- TO BE READ IN CONJUNCTION WITH MEP & S.E. DOCUMENTATION

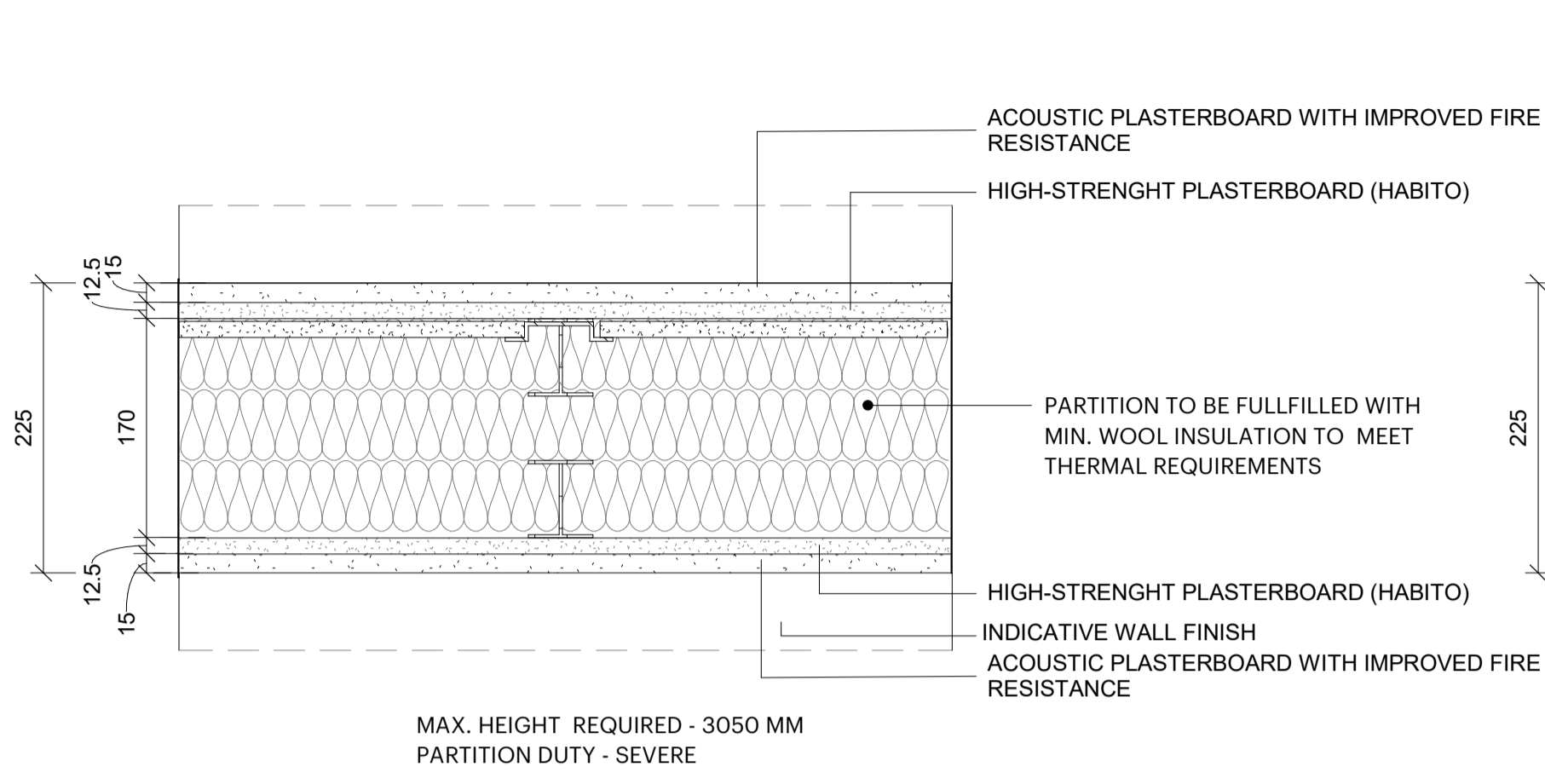

MAX. HEIGHT REQUIRED - 3050 MM
PARTITION DUTY - SEVERE

THERMAL - 0.19 W/m2K
FIRE RATING 120/120
ACOUSTIC RATING 50 DnTw + Ctr

01 WALL TYPE C1
PARTY WALL FLATS TO LOBBY

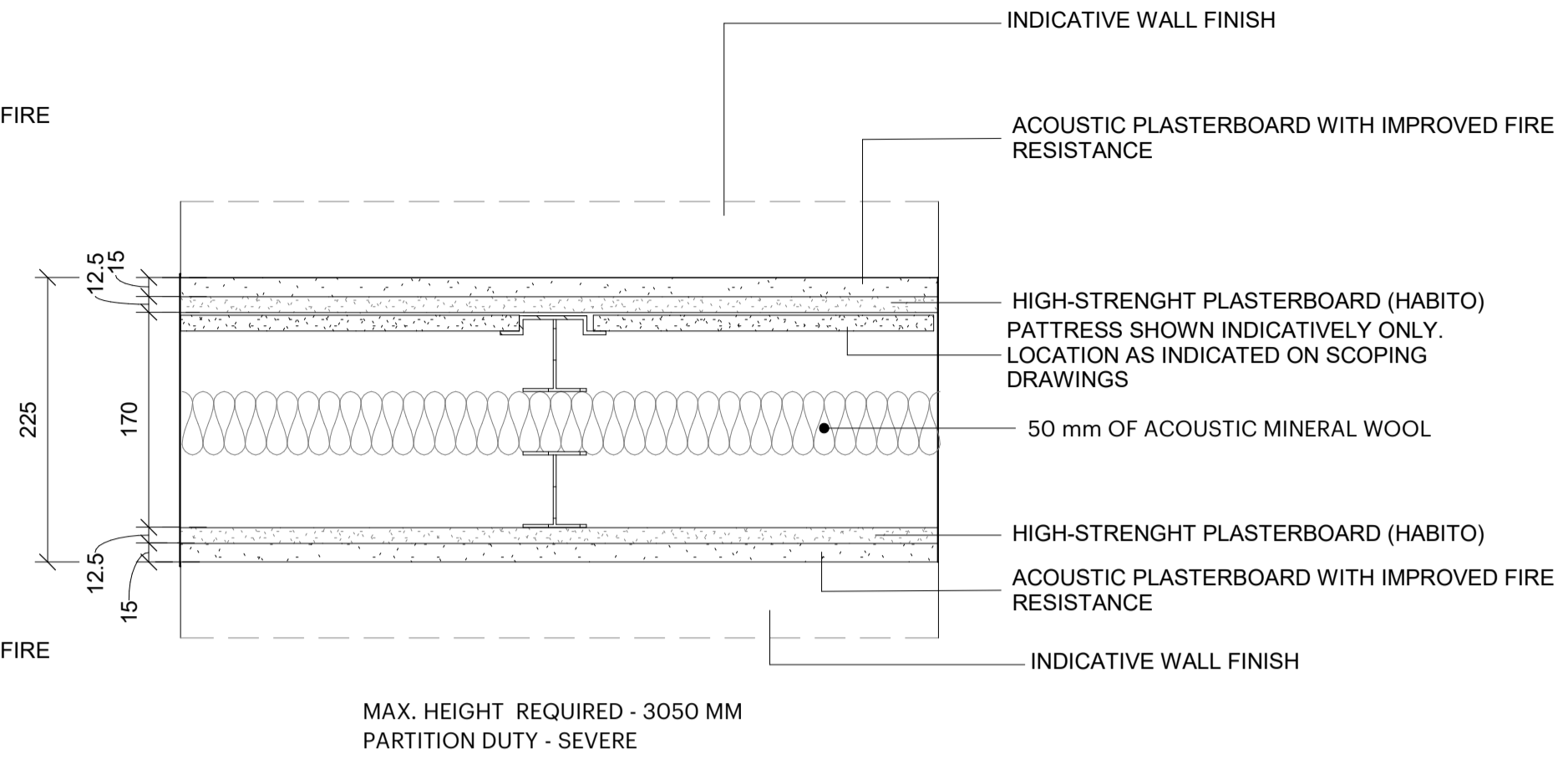

MAX. HEIGHT REQUIRED - 3050 MM
PARTITION DUTY - SEVERE

FIRE RATING 60 / 60
ACOUSTIC RATING 50 DnTw + Ctr

02 WALL TYPE C2
PARTY WALL BETWEEN FLATS

Date	Rev	Description	Legend	Notes	Key Plan	Disclaimer
------	-----	-------------	--------	-------	----------	------------

14.07.2022	P1	STAGE 3 ISSUE				
------------	----	---------------	--	--	--	--

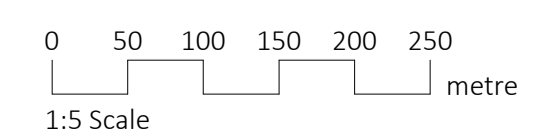

dMFK Architects Ltd take no responsibility for dimensions obtained by scaling from this drawing. If no dimension is shown the recipient must ascertain the dimension specifically from the architect or by site measurement and may not rely on the drawing. Supply of the drawing in digital form is solely for convenience and no reliance may be placed on any data in digital form. All data must be checked against hard copy. This drawing is issued for design intent only and should not be used for construction unless stated.

Copyright: This drawing is the property of dMFK Architects Ltd. No disclosure or copy of it may be made without the written permission of dMFK Architects Ltd

Scale	As indicated	Drawn	Checked	Date
A1	1 : 10	RG	JW	14.07.2022

Project:
Kentish Town Road
Client:
Folgate Estates

Drawing Title:
Internal Wall - Type C
Drawing No:
KTT-dMFK-ZZ-DR-A-060502
Rev: **P1** Suit: **S4**



The Old Library, 119 Cholmley Gardens, London. NW6 1AA
t: 0207 435 1144 e: info@dmfk.co.uk w: www.dmfk.co.uk