

KEY PLAN/ SECTION

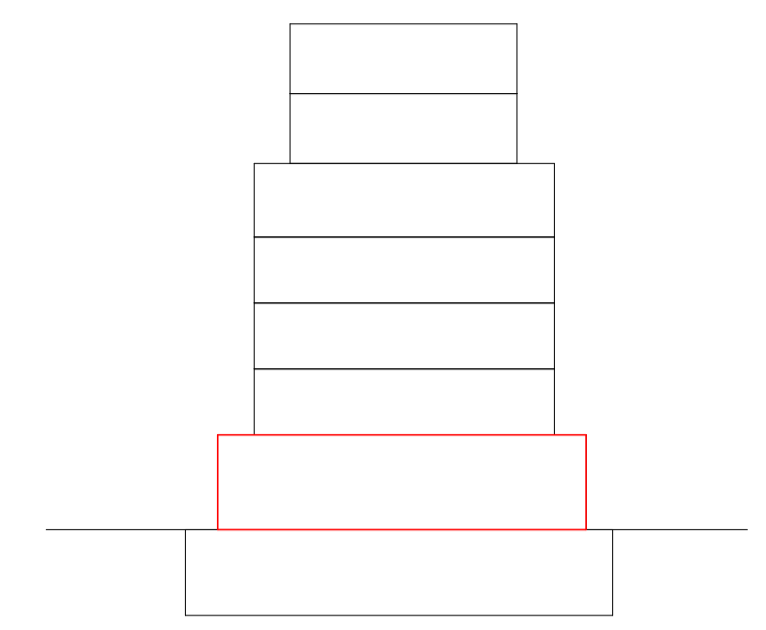

NOTES

1. DRAWING TO BE READ IN CONJUNCTION WITH MEP, S.E., ACOUSTIC, FIRE & OTHER RELEVANT CONSULTANT DOCUMENTATION
2. FOR LOCATION OF DRAINAGE OUTLETS PLEASE REFER TO SERVICES ENGINEER'S DOCUMENTATION.
3. FOR INTERNAL WALLS INFORMATION AND SETTING OUT, REFER TO O6 SERIES
4. FOR FLAT AREAS PLEASE REFER TO AREA SCHEDULE.

Date	Rev	Description	Legend	Notes	Key Plan	Disclaimer
14.07.2022	P1	STAGE 3 ISSUE				

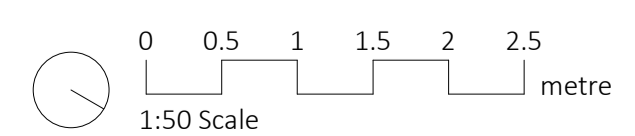

dMFK Architects Ltd take no responsibility for dimensions obtained by scaling from this drawing. If no dimension is shown the recipient must ascertain the dimension specifically from the architect or by site measurement and may not rely on the drawing. Supply of the drawing in digital form is solely for convenience and no reliance may be placed on any data in digital form. All data must be checked against hard copy. This drawing is issued for design intent only and should not be used for construction unless stated.

Copyright: This drawing is the property of dMFK Architects Ltd. No disclosure or copy of it may be made without the written permission of dMFK Architects Ltd

Scale	Drawn	Checked	Date
1 : 50 @A1	RG	JW	14.07.2022

Project:
 Kentish Town Road
 Client:
 Folgate Estates

Drawing Title:
 Ground Floor
 Drawing No:
 KTT-dMFK-ZZ-00-DR-A-030010
 Rev: P1
 Suit: S4



The Old Library, 119 Cholmley Gardens, London. NW6 1AA
 t: 0207 435 1144 e: info@dmfk.co.uk w: www.dmfk.co.uk

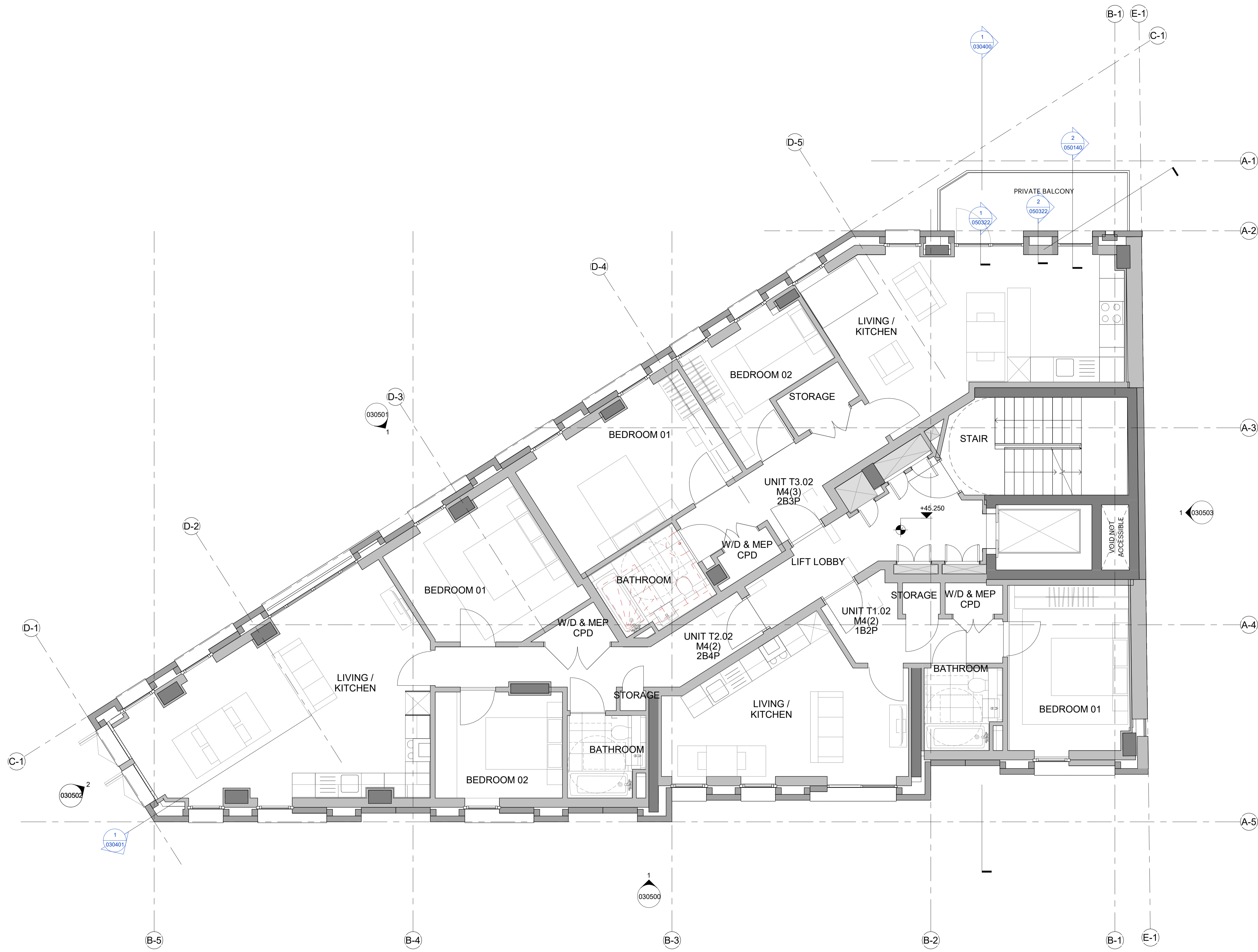

KEY PLAN/ SECTION

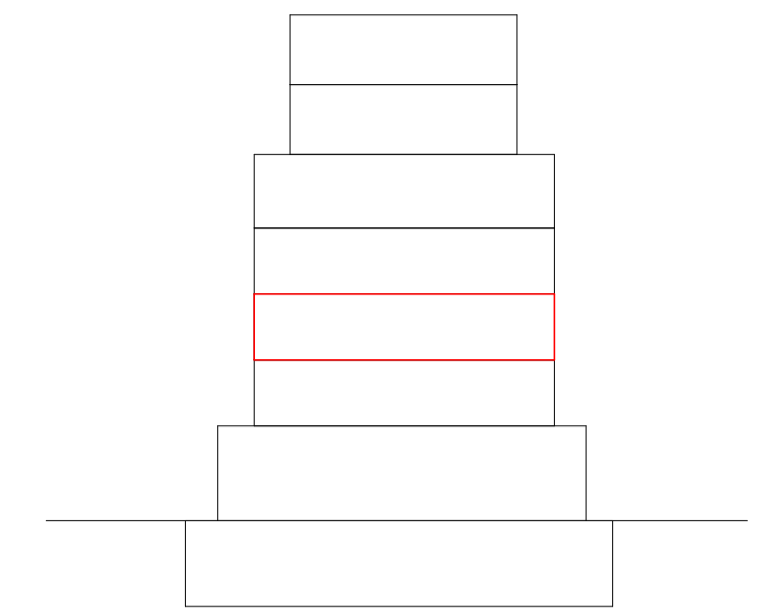

NOTES

1. DRAWING TO BE READ IN CONJUNCTION WITH MEP, S.E., ACOUSTIC, FIRE & OTHER RELEVANT CONSULTANT DOCUMENTATION
2. FOR LOCATION OF DRAINAGE OUTLETS PLEASE REFER TO SERVICES ENGINEER'S DOCUMENTATION.
3. FOR INTERNAL WALLS INFORMATION AND SETTING OUT, REFER TO O6 SERIES
4. FOR FLAT AREAS PLEASE REFER TO AREA SCHEDULE.

Date	Rev	Description	Legend	Notes	Key Plan	Disclaimer
14.07.2022	P1	STAGE 3 ISSUE				

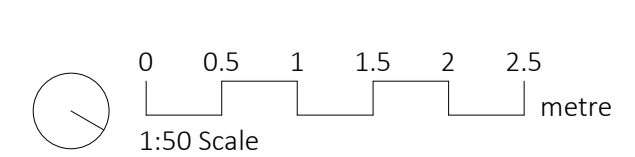

dMFK Architects Ltd take no responsibility for dimensions obtained by scaling from this drawing. If no dimension is shown the recipient must ascertain the dimension specifically from the architect or by site measurement and may not rely on the drawing. Supply of the drawing in digital form is solely for convenience and no reliance may be placed on any data in digital form. All data must be checked against hard copy. This drawing is issued for design intent only and should not be used for construction unless stated.

Copyright: This drawing is the property of dMFK Architects Ltd. No disclosure or copy of it may be made without the written permission of dMFK Architects Ltd

Scale	Drawn	Checked	Date
1 : 50 @A1	RG	JW	14.07.2022

Project:
 Kentish Town Road
 Client:
 Folgate Estates

Drawing Title:
 Second Floor
 Drawing No:
 KTT-dMFK-ZZ-02-DR-A-030012

Rev: P1
 Suit: S4



The Old Library, 119 Cholmley Gardens, London. NW6 1AA
 t: 0207 435 1144 e: info@dmfk.co.uk w: www.dmfk.co.uk

KEY PLAN/ SECTION

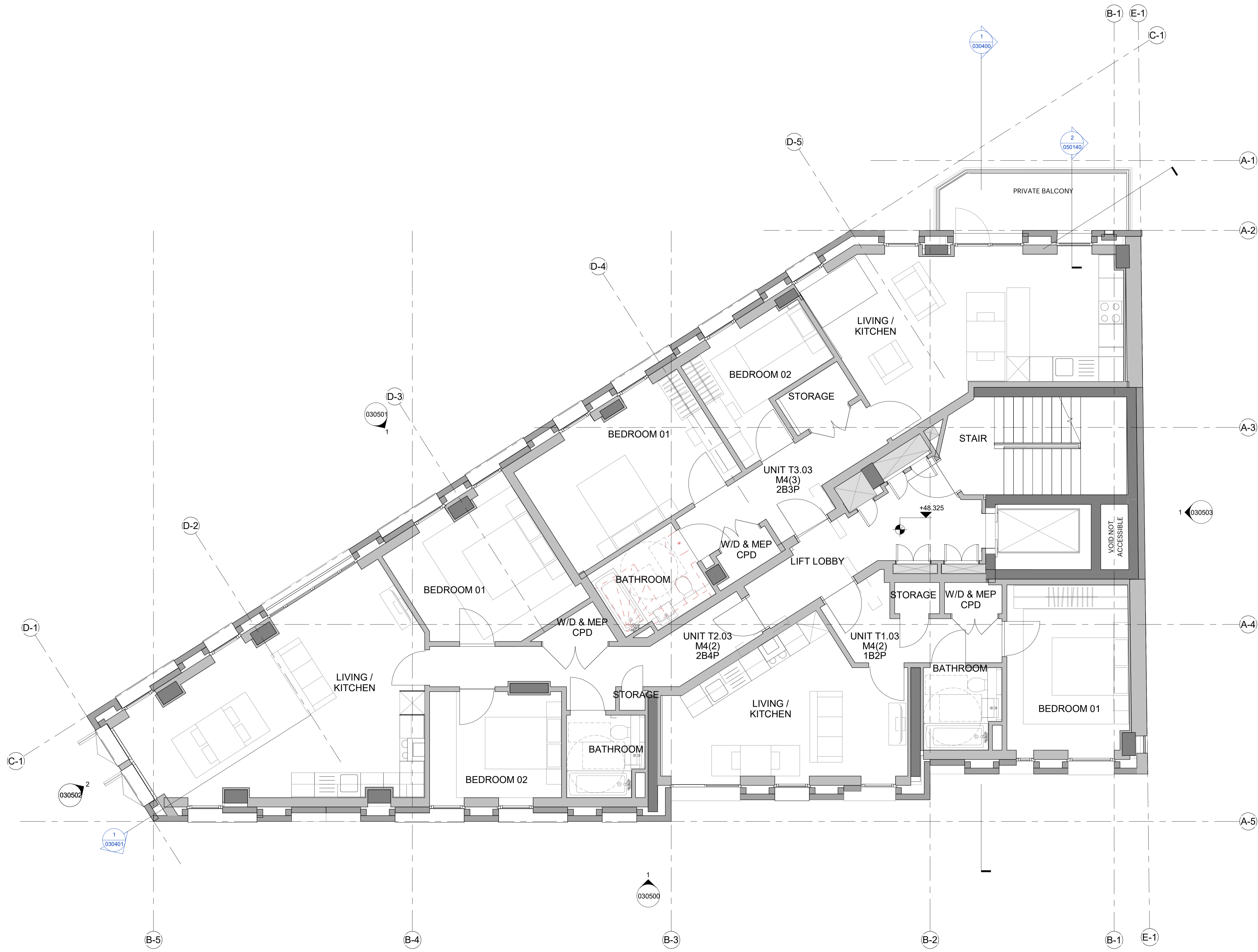

NOTES

1. DRAWING TO BE READ IN CONJUNCTION WITH MEP, S.E., ACOUSTIC, FIRE & OTHER RELEVANT CONSULTANT DOCUMENTATION
2. FOR LOCATION OF DRAINAGE OUTLETS PLEASE REFER TO SERVICES ENGINEER'S DOCUMENTATION.
3. FOR INTERNAL WALLS INFORMATION AND SETTING OUT, REFER TO O6 SERIES
4. FOR FLAT AREAS PLEASE REFER TO AREA SCHEDULE.

Date	Rev	Description	Legend	Notes	Key Plan	Disclaimer
14.07.2022	P1	STAGE 3 ISSUE				

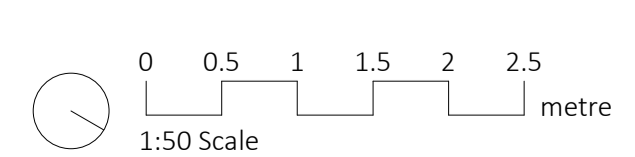

dMFK Architects Ltd take no responsibility for dimensions obtained by scaling from this drawing. If no dimension is shown the recipient must ascertain the dimension specifically from the architect or by site measurement and may not rely on the drawing. Supply of the drawing in digital form is solely for convenience and no reliance may be placed on any data in digital form. All data must be checked against hard copy. This drawing is issued for design intent only and should not be used for construction unless stated.

Copyright: This drawing is the property of dMFK Architects Ltd. No disclosure or copy of it may be made without the written permission of dMFK Architects Ltd

Scale	Drawn	Checked	Date
1 : 50 @A1	RG	JW	14.07.2022

Project:
 Kentish Town Road
 Client:
 Folgate Estates

Drawing Title:
 Third Floor
 Drawing No:
 KTT-dMFK-ZZ-03-DR-A-030013

Rev: P1
 Suit: S4



The Old Library, 119 Cholmley Gardens, London. NW6 1AA
 t: 0207 435 1144 e: info@dmfk.co.uk w: www.dmfk.co.uk

KEY PLAN/ SECTION

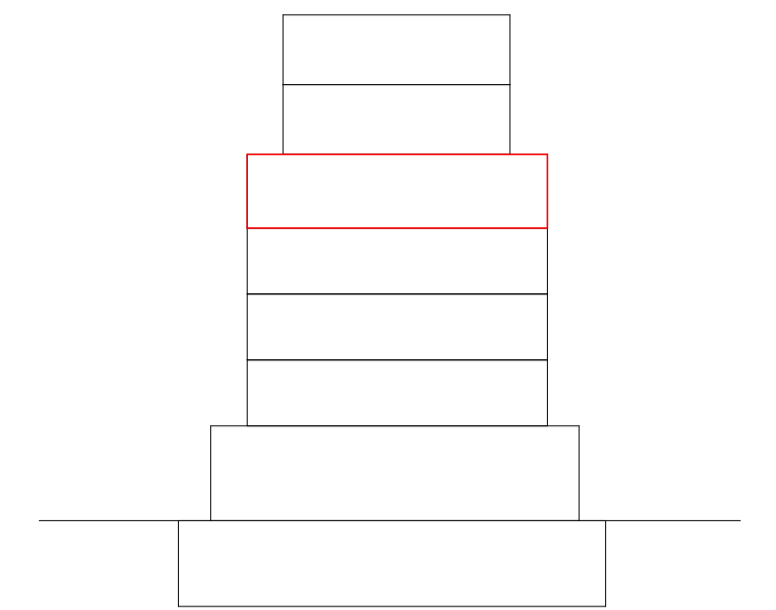

NOTES

1. DRAWING TO BE READ IN CONJUNCTION WITH MEP, S.E., ACOUSTIC, FIRE & OTHER RELEVANT CONSULTANT DOCUMENTATION
2. FOR LOCATION OF DRAINAGE OUTLETS PLEASE REFER TO SERVICES ENGINEER'S DOCUMENTATION.
3. FOR INTERNAL WALLS INFORMATION AND SETTING OUT, REFER TO O6 SERIES
4. FOR FLAT AREAS PLEASE REFER TO AREA SCHEDULE.

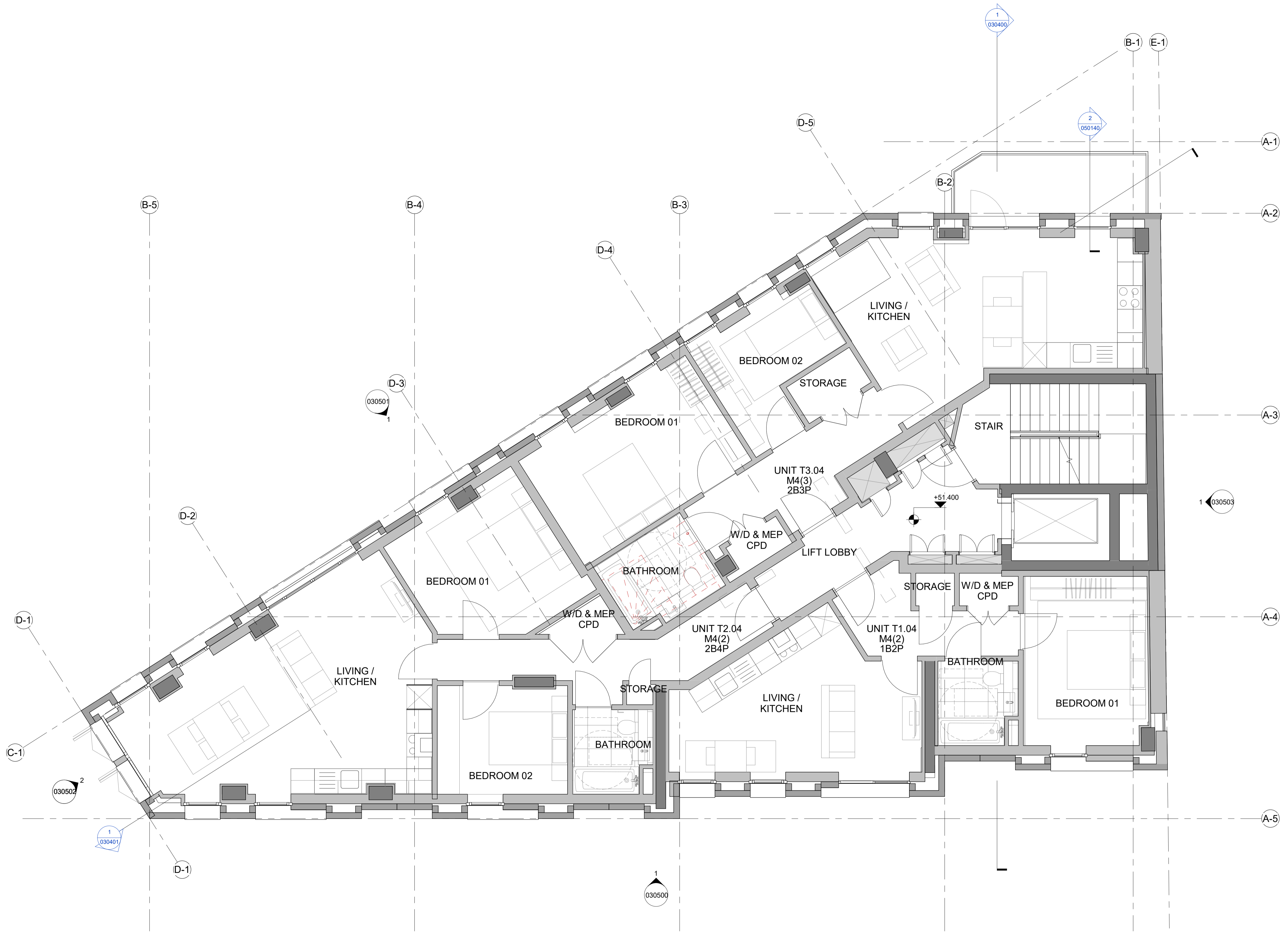

Date	Rev	Description	Legend	Notes	Key Plan	Disclaimer
14.07.2022	P1	STAGE 3 ISSUE				

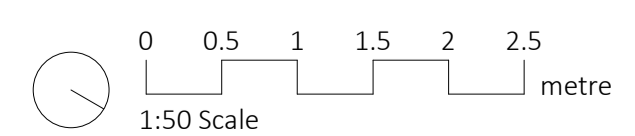

dMFK Architects Ltd take no responsibility for dimensions obtained by scaling from this drawing. If no dimension is shown the recipient must ascertain the dimension specifically from the architect or by site measurement and may not rely on the drawing. Supply of the drawing in digital form is solely for convenience and no reliance may be placed on any data in digital form. All data must be checked against hard copy. This drawing is issued for design intent only and should not be used for construction unless stated.

Copyright: This drawing is the property of dMFK Architects Ltd. No disclosure or copy of it may be made without the written permission of dMFK Architects Ltd

Scale	Drawn	Checked	Date
1 : 50 @A1	RG	JW	14.07.2022

Project:
 Kentish Town Road
 Client:
 Folgate Estates

Drawing Title:
 Fourth Floor
 Drawing No:
 KTT-dMFK-ZZ-04-DR-A-030014
 Rev: P1
 Suit: S4



The Old Library, 119 Cholmley Gardens, London. NW6 1AA
 t: 0207 435 1144 e: info@dmfk.co.uk w: www.dmfk.co.uk

KEY PLAN/ SECTION

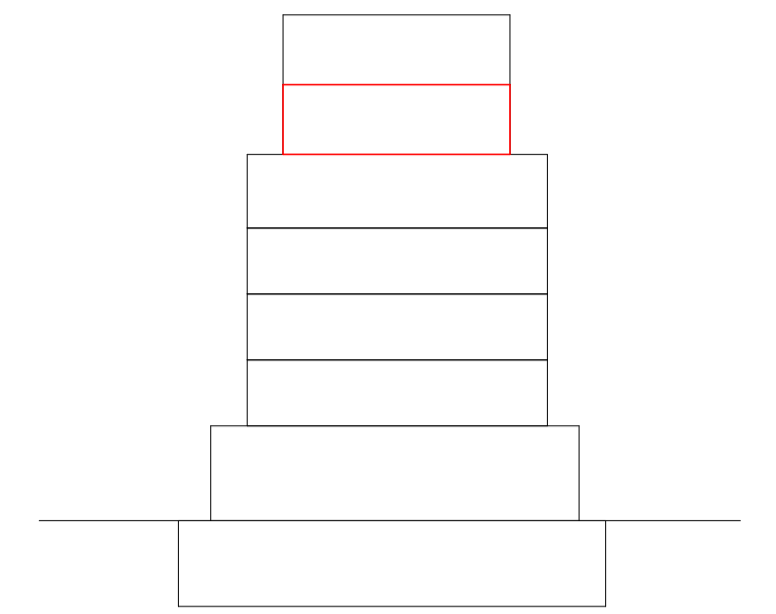

NOTES

1. DRAWING TO BE READ IN CONJUNCTION WITH MEP, S.E., ACOUSTIC, FIRE & OTHER RELEVANT CONSULTANT DOCUMENTATION
2. FOR LOCATION OF DRAINAGE OUTLETS PLEASE REFER TO SERVICES ENGINEER'S DOCUMENTATION.
3. FOR INTERNAL WALLS INFORMATION AND SETTING OUT, REFER TO O6 SERIES
4. FOR FLAT AREAS PLEASE REFER TO AREA SCHEDULE.



Date	Rev	Description	Legend	Notes	Key Plan	Disclaimer
14.07.2022	P1	STAGE 3 ISSUE				

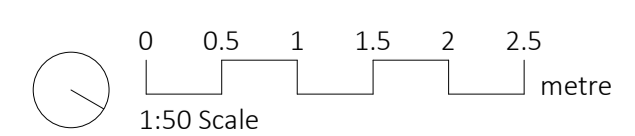

dMFK Architects Ltd take no responsibility for dimensions obtained by scaling from this drawing. If no dimension is shown the recipient must ascertain the dimension specifically from the architect or by site measurement and may not rely on the drawing. Supply of the drawing in digital form is solely for convenience and no reliance may be placed on any data in digital form. All data must be checked against hard copy. This drawing is issued for design intent only and should not be used for construction unless stated.

Copyright: This drawing is the property of dMFK Architects Ltd. No disclosure or copy of it may be made without the written permission of dMFK Architects Ltd

Scale	Drawn	Checked	Date
1 : 50 @A1	RG	JW	14.07.2022

Project:
 Kentish Town Road
 Client:
 Folgate Estates

Drawing Title:
 Fifth Floor
 Drawing No:
 KTT-dMFK-ZZ-05-DR-A-030015
 Rev: P1
 Suit: S4



The Old Library, 119 Cholmley Gardens, London. NW6 1AA
 t: 0207 435 1144 e: info@dmfk.co.uk w: www.dmfk.co.uk

KEY PLAN/ SECTION

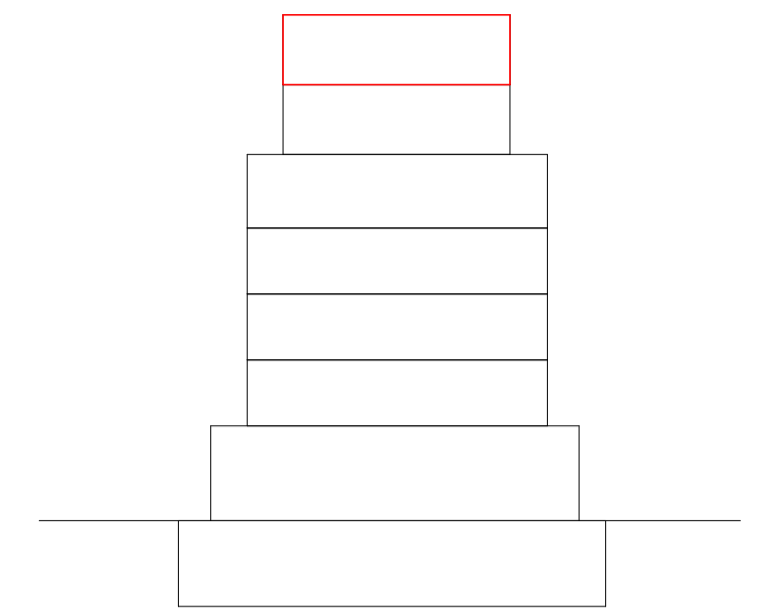

NOTES

1. DRAWING TO BE READ IN CONJUNCTION WITH MEP, S.E., ACOUSTIC, FIRE & OTHER RELEVANT CONSULTANT DOCUMENTATION
2. FOR LOCATION OF DRAINAGE OUTLETS PLEASE REFER TO SERVICES ENGINEER'S DOCUMENTATION.
3. FOR INTERNAL WALLS INFORMATION AND SETTING OUT, REFER TO O6 SERIES
4. FOR FLAT AREAS PLEASE REFER TO AREA SCHEDULE.

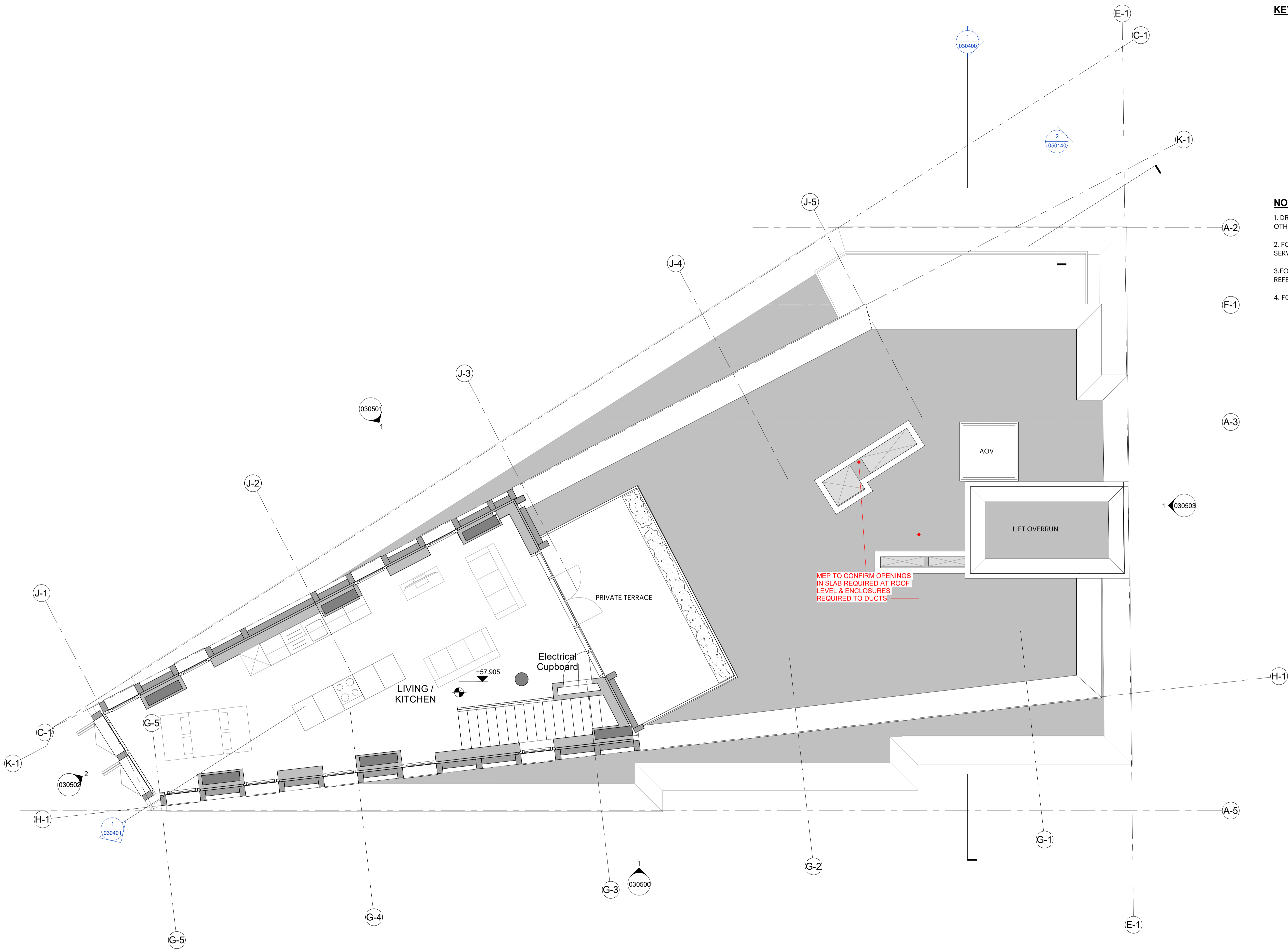

Date	Rev	Description	Legend	Notes	Key Plan	Disclaimer
------	-----	-------------	--------	-------	----------	------------

14.07.2022 P1 STAGE 3 ISSUE

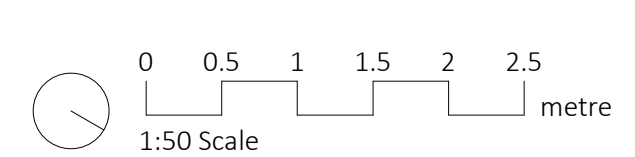

dMFK Architects Ltd take no responsibility for dimensions obtained by scaling from this drawing. If no dimension is shown the recipient must ascertain the dimension specifically from the architect or by site measurement and may not rely on the drawing. Supply of the drawing in digital form is solely for convenience and no reliance may be placed on any data in digital form. All data must be checked against hard copy. This drawing is issued for design intent only and should not be used for construction unless stated.

Copyright: This drawing is the property of dMFK Architects Ltd. No disclosure or copy of it may be made without the written permission of dMFK Architects Ltd

Scale	Drawn	Checked	Date
1 : 50 @A1	RG	JW	14.07.2022

Project:
 Kentish Town Road
 Client:
 Folgate Estates

Drawing Title:
 Sixth Floor
 Drawing No:
 KTT-dMFK-ZZ-06-DR-A-030016
 Rev: P1
 Suit: S4



The Old Library, 119 Cholmley Gardens, London. NW6 1AA
 t: 0207 435 1144 e: info@dmfk.co.uk w: www.dmfk.co.uk

KEY PLAN/ SECTION

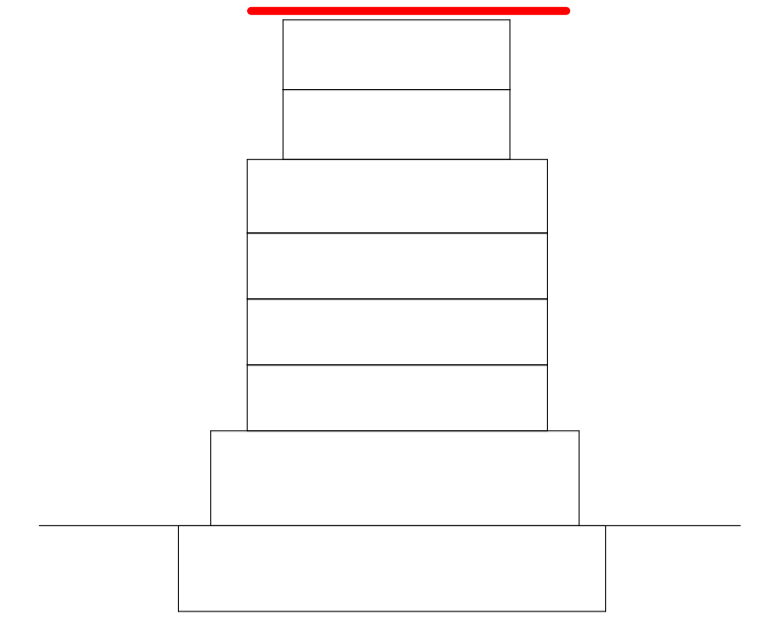

NOTES

1. DRAWING TO BE READ IN CONJUNCTION WITH MEP, S.E., ACOUSTIC, FIRE & OTHER RELEVANT CONSULTANT DOCUMENTATION
2. FOR LOCATION OF DRAINAGE OUTLETS PLEASE REFER TO SERVICES ENGINEER'S DOCUMENTATION.
3. FOR INTERNAL WALLS INFORMATION AND SETTING OUT, REFER TO O6 SERIES
4. FOR FLAT AREAS PLEASE REFER TO AREA SCHEDULE.

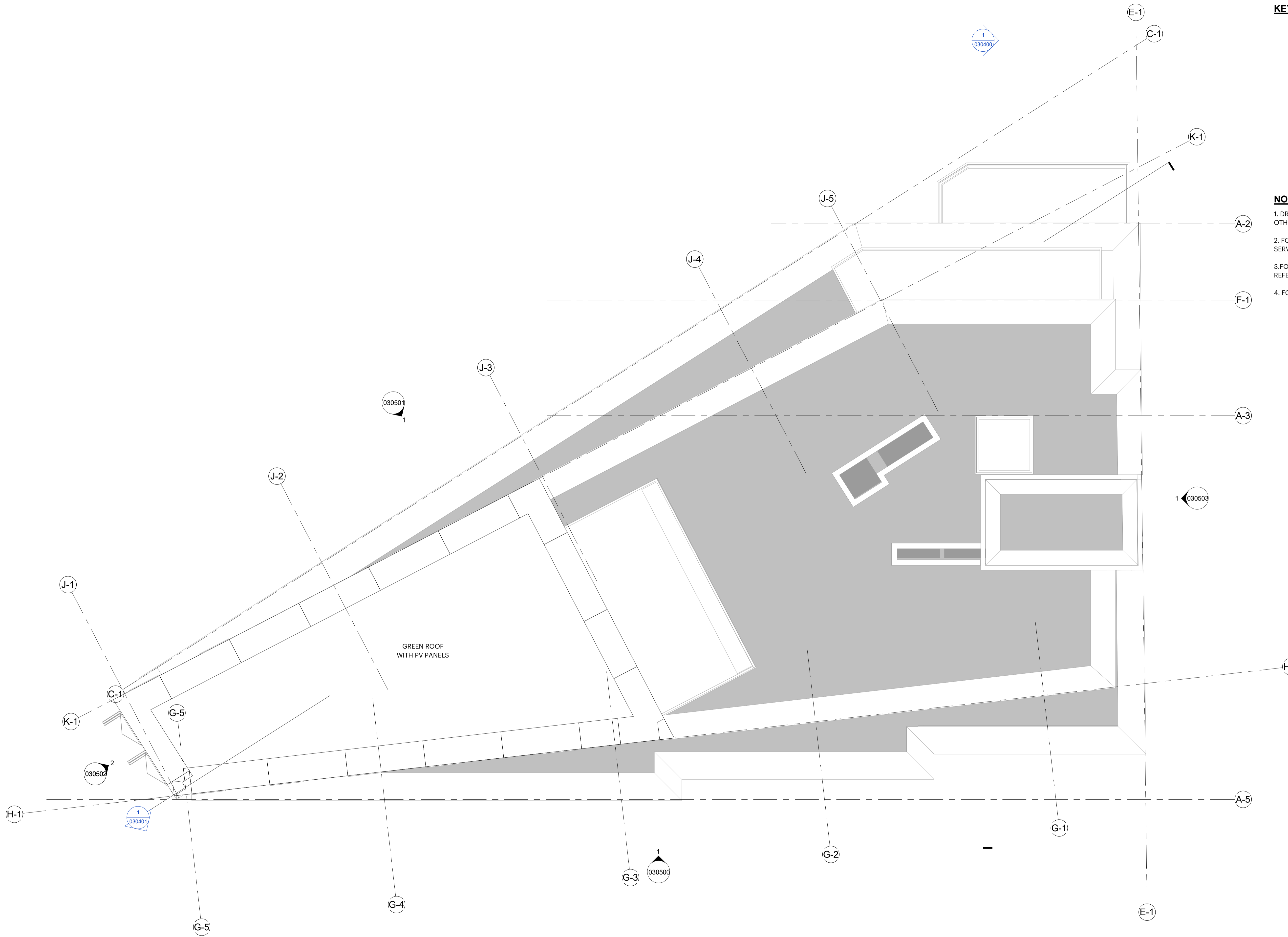

Date	Rev	Description	Legend	Notes
14.07.2022	P1	STAGE 3 ISSUE		

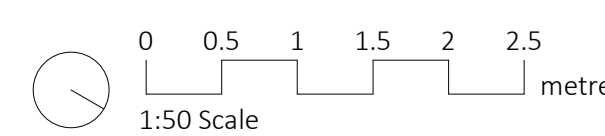

Disclaimer
 dMFK Architects Ltd take no responsibility for dimensions obtained by scaling from this drawing. If no dimension is shown the recipient must ascertain the dimension specifically from the architect or by site measurement and may not rely on the drawing. Supply of the drawing in digital form is solely for convenience and no reliance may be placed on any data in digital form. All data must be checked against hard copy. This drawing is issued for design intent only and should not be used for construction unless stated.

Copyright: This drawing is the property of dMFK Architects Ltd. No disclosure or copy of it may be made without the written permission of dMFK Architects Ltd

Scale	Drawn	Checked	Date
1 : 50 @A1	RG	JW	14.07.2022

Project:
 Kentish Town Road
Client:
 Folgate Estates

Drawing Title:	Rev:	Suit:
Roof	P1	S4

dMFK
 The Old Library, 119 Cholmley Gardens, London. NW6 1AA
 t: 0207 435 1144 e: info@dmfk.co.uk w: www.dmfk.co.uk

KEY PLAN/ SECTION

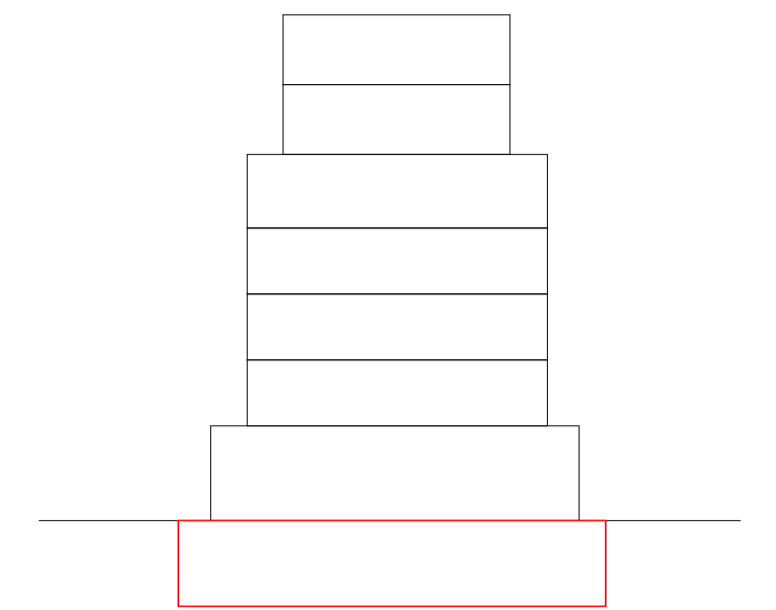

NOTES

- DRAWING TO BE READ IN CONJUNCTION WITH MEP, S.E., ACOUSTIC, FIRE & OTHER RELEVANT CONSULTANT DOCUMENTATION
- FOR LOCATION OF DRAINAGE OUTLETS PLEASE REFER TO SERVICES ENGINEER'S DOCUMENTATION.
- FOR INTERNAL WALLS INFORMATION AND SETTING OUT, REFER TO O6 SERIES
- FOR FLAT AREAS PLEASE REFER TO AREA SCHEDULE.

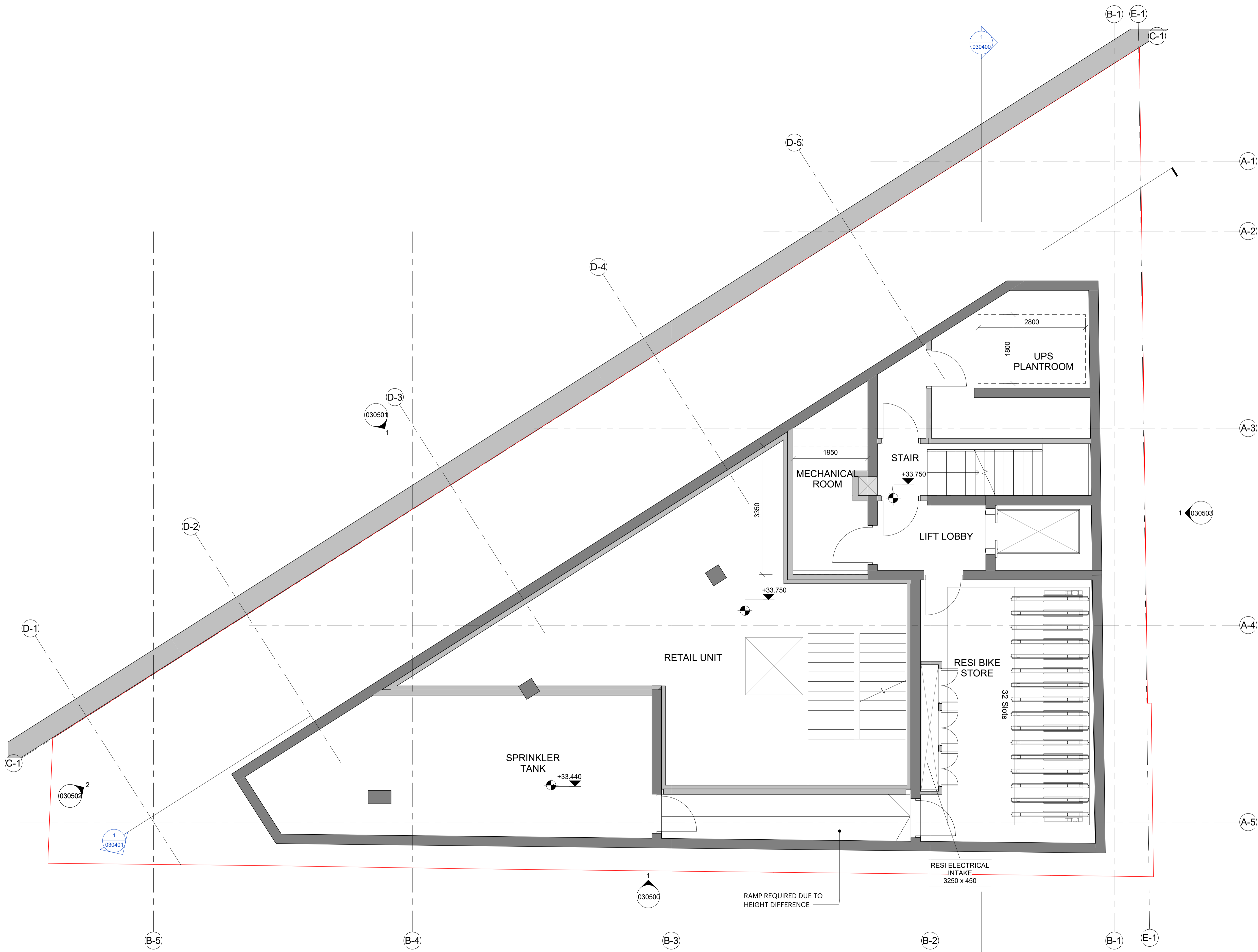

Date	Rev	Description	Legend	Notes	Key Plan	Disclaimer
14.07.2022	P1	STAGE 3 ISSUE				

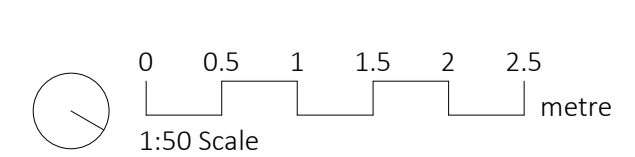

dMFK Architects Ltd take no responsibility for dimensions obtained by scaling from this drawing. If no dimension is shown the recipient must ascertain the dimension specifically from the architect or by site measurement and may not rely on the drawing. Supply of the drawing in digital form is solely for convenience and no reliance may be placed on any data in digital form. All data must be checked against hard copy. This drawing is issued for design intent only and should not be used for construction unless stated.

Copyright: This drawing is the property of dMFK Architects Ltd. No disclosure or copy of it may be made without the written permission of dMFK Architects Ltd

Scale	Drawn	Checked	Date
1 : 50 @A1	RG	JW	14.07.2022

Project:
 Kentish Town Road
 Client:
 Folgate Estates

Drawing Title:
 Basement
 Drawing No:
 KTT-dMFK-ZZ-B1-DR-A-030009
 Rev: P1
 Suit: S4



The Old Library, 119 Cholmley Gardens, London. NW6 1AA
 t: 0207 435 1144 e: info@dmfk.co.uk w: www.dmfk.co.uk