

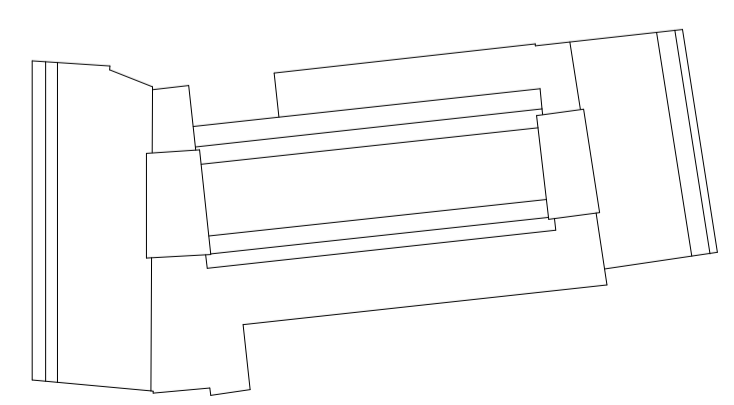

- Solid metal door integrated in curtain wall
Signage panel with integrated louvres concealed behind
- Retractable awnings
Retail bays, appearance as per consented scheme
- Retractable awnings
External signage as per consented scheme
- Templar House sign as per consented scheme
Glazed entrance door on the existing recessed area
- Retractable awnings
Retail frontages, appearance to match consented scheme
- Retractable awnings
Retail frontages, appearance to match consented scheme
- Solid metal door integrated in curtain wall

General Note: colour and material of proposed elevation is to match consented scheme

South Elevation



WINDOW LEGEND

| | |
|--|-----------------------|
| | Translucent glass |
| | Glazed spandrel panel |
| | Clear glass |

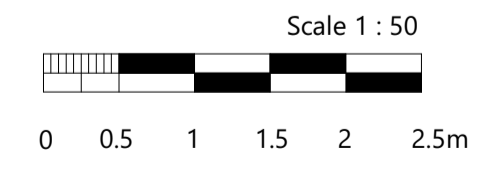

| Rev | Description | Date | Dr | Ap |
|-----|---------------------|------------|----|----|
| P02 | Planning amendments | 2022-09-06 | MF | AL |
| P01 | Planning | 2021-08-06 | ML | NG |

Revisions

Author

4th Floor, 30 Millbank, London SW1P 4DU
T: +44(0)207 401 4100 E: info@astudio.co.uk
www.astudio.co.uk

Client

Project
Uncommon Holborn
85 High Holborn

Drawing name
SET B Proposed High Holborn Frontage Elevation

Drawing number
UCH-AST-XX-XX-DR-A-011852

Scale: **As indicated A1** Format: **A1**

Project number: **21003** Drawing Status: **Stage 4** Suitability: **S4** Rev: **P02**

Disclaimer: This drawing is to be read in conjunction with all related drawings. Do not scale from this drawing. All dimensions must be checked and verified on site before commencing any work or producing shop drawings. The originator should be notified immediately of any discrepancy. This drawing is copyright and remains the property of astudio architecture.