



1 West Central Street - Proposed South West Elevation

1 : 100



2 West Central Street - Proposed South East Elevation

1 : 100



NOTES

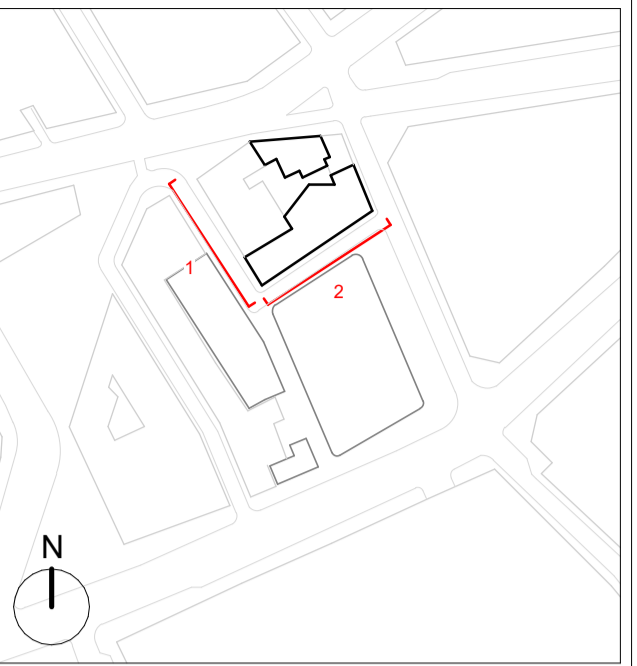

GENERAL NOTES:

Planning Boundary shown is intended to align with proposed West End Project kerb extents along High Holborn. Post-submission amendment to as-built kerb line may be required.

The internal layouts within office floor space, residential apartments and ancillary areas of buildings are indicative and will be subject to design development.

The precise location of walls, internal doors, columns, risers and the detailed layout of office, bathroom and kitchen areas will be the subject of non-material changes and may vary from the internal layouts set out in these plans.

These minor alterations will not affect the position and arrangements of external doors and windows nor will they affect the relative relationship between habitable rooms and windows.

Landscape proposals are indicative only, refer to Landscape drawings for details.

Plant layouts are indicative only.

All materials shown or highlighted are indicative only and may be subject to changes made during detailed design development.

Museum Street landscape proposals are indicative.

Materials Key

1. Replacement Timber Shop Front
2. Replacement Timber Retail Entrance
3. Timber Signage Zone
4. Replacement Heritage Style Sash Window
5. Existing Facade: Repaired and repainted
6. Zinc Standing Seam Cladding
7. PPC metalwork: Colour Varies
8. Curtain Walling: Colour Varies
9. GRC Fin Extrusion with Backing Panel
10. Bespoke PPC Guardrail
11. Timber Door
12. Brickwork
13. Brickwork: Corbel Detail
14. Pre-cast Brick Cornice
15. GRC Cladding
16. Insulated Render system and Deco profiles
17. Existing Brickwork: Repaired and Repointed
18. Aluminium Casement Window. Colour Varies
19. Bespoke PPC Aluminium Louvered Door

A 01.06.22 IM Issued for Planning Addendum
 - 22.03.21 IM Issued for Planning

PLANNING

rev	date	author / check	comments
A	01.06.22	IM	Issued for Planning Addendum
-	22.03.21	IM	Issued for Planning

DSDHA
 357 Kennington Lane London SE11 5QY
 T 020 7703 3555
 F 020 7703 3890
 E info@dshda.co.uk
 W www.dshda.co.uk

project
Museum Street and West Central Street

London, WC1A 1JR
 drawing title

WCS - West Central Street Elevations

drawn	size	date	scale
Author	A1	22/03/21	1 : 100
drawing number	revision		

295B_P30.141 A

REPORT DISCREPANCIES DO NOT SCALE FROM THIS DRAWING COPYRIGHT DSDHA
 USE LATEST REVISION CHECK DIMENSIONS ON SITE