

NOTES

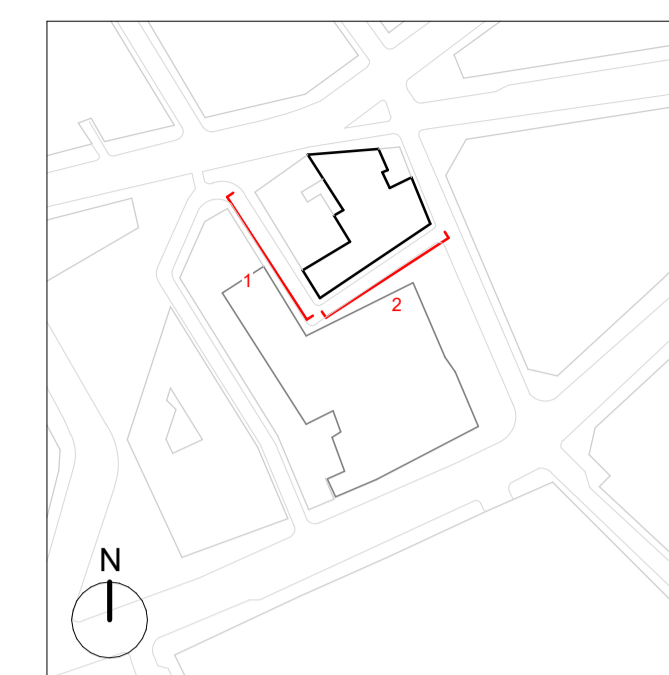

GENERAL NOTES:
 Existing drawings are for reference only - not for approval.
 Planning Boundary shown is intended to align with proposed West End Project front extents along High Holborn, and is based on available information as submitted.



2 **West Central Street - South West - Proposed Demolition Elevation**

1 : 100

KEY:

- Planning Boundary
- Extent of Walls Demolition
- Extent of Demolition
- Extent of Existing Strip-out
* All fixtures and fittings are to be removed
 ** Floor finishes as part of strip-out, however existing slab structure to be retained except where noted.
- Existing structure removed and replaced
- Existing window frame removed and replaced
- Existing window frame removed & structural opening increased to add new window/door size
- New structural opening in the existing facade for new door/window
- Existing window frame demolished and structural opening closed

A 01.06.22 IM Issued for Planning Addendum
 22.03.21 IM Issued for Planning

PLANNING

DSDHA
 357 Kennington Lane London SE11 5QY
 T 020 7703 3555
 F 020 7703 3890
 E info@dsdha.co.uk
 W www.dsdha.co.uk

project
Museum Street and West Central Street

London, WC1A 1JR
 drawing title

WCS - Demolition Elevations - West Central Street

drawn	size	date	scale
Author	A1	22/03/21	1 : 100
drawing number	revision		

295B_P10.401 A

REPORT DISCREPANCIES DO NOT SCALE FROM THIS DRAWING COPYRIGHT DSDHA USE LATEST REVISION CHECK DIMENSIONS ON SITE



1 **West Central Street - South East - Proposed Demolition Elevation**

1 : 100

