

NOTES

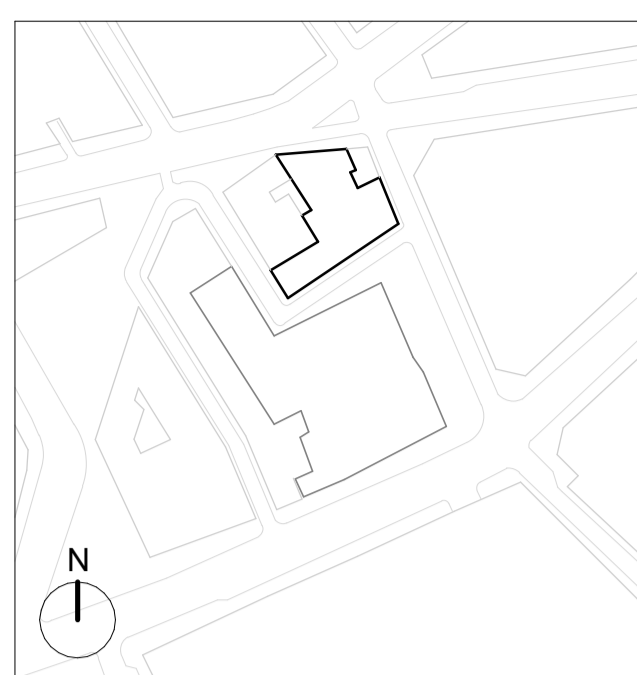

GENERAL NOTES:
 Existing drawings are for reference only - not for approval.
 Planning Boundary shown is intended to align with proposed West End Project front extents along High Holborn, and is based on available information as submitted.

- KEY:**
- Planning Boundary
 - Extent of Walls Demolition
 - Extent of Demolition
 - Extent of Existing Strip-out
 * All fixtures and fittings are to be removed
 ** Floor finishes as part of strip-out, however existing slab structure to be retained except where noted.
 - Existing structure removed and replaced
 - Existing window frame removed and replaced
 - Existing window frame removed & structural opening increased to add new window/door size
 - New structural opening in the existing facade for new door/window
 - Existing window frame demolished and structural opening closed

A 01.06.22 IM Issued for Planning Addendum
 - 22.03.21 IM Issued for Planning

PLANNING

rev | date | author / check | comments
DSDHA
 357 Kennington Lane London SE11 5QY
 T 020 7703 3555
 F 020 7703 3890
 E info@dshda.co.uk
 W www.dshda.co.uk

project
Museum Street and West Central Street

London, WC1A 1JR
 drawing title

WCS - Demolition Plan - Fourth Floor

drawn	size	date	scale
Author	A1	22/03/21	1:100
drawing number	revision		
295B_P10.305	A		

REPORT DISCREPANCIES DO NOT SCALE FROM THIS DRAWING COPYRIGHT DSDHA
 USE LATEST REVISION CHECK DIMENSIONS ON SITE

