

**NOTES**

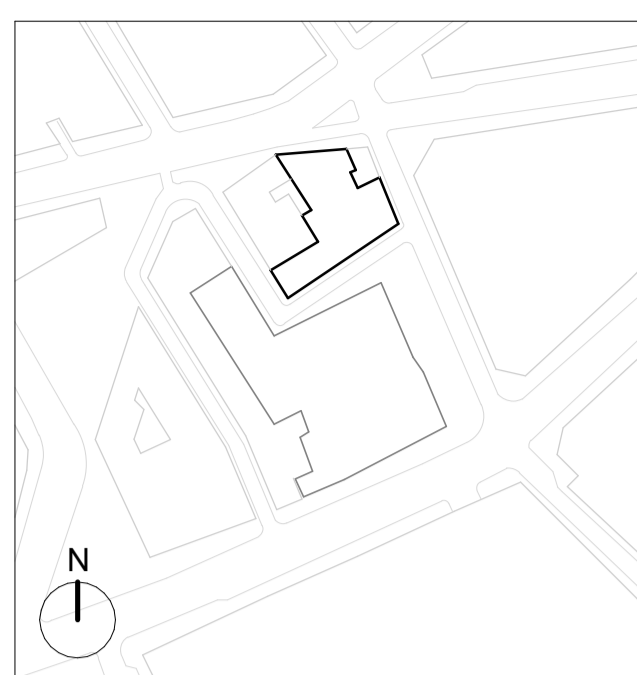

**GENERAL NOTES:**  
 Existing drawings are for reference only - not for approval.  
 Planning Boundary shown is intended to align with proposed West End Project front extents along High Holborn, and is based on available information as submitted.

- KEY:**
- Planning Boundary
  - Extent of Walls Demolition
  - Extent of Demolition
  - Extent of Existing Strip-out  
 \* All fixtures and fittings are to be removed  
 \*\* Floor finishes as part of strip-out, however existing slab structure to be retained except where noted.
  - Existing structure removed and replaced
  - Existing window frame removed and replaced
  - Existing window frame removed & structural opening increased to add new window/ door size
  - New structural opening in the existing facade for new door/ window
  - Existing window frame demolished and structural opening closed

A 01.06.22 IM Issued for Planning Addendum  
 - 22.03.21 IM Issued for Planning

# PLANNING

**DSDHA**  
 357 Kennington Lane London SE11 5QY  
 T 020 7703 3555  
 F 020 7703 3890  
 E info@dsdha.co.uk  
 W www.dsdha.co.uk

project  
**Museum Street and West Central Street**

London, WC1A 1JR  
 drawing title

WCS - Demolition Plan - Third Floor

drawn	size	date	scale
Author	A1	22/03/21	1: 100
drawing number	revision		

295B_P10.304	A
--------------	---

REPORT DISCREPANCIES DO NOT SCALE FROM THIS DRAWING COPYRIGHT DSDHA

USE LATEST REVISION CHECK DIMENSIONS ON SITE

