

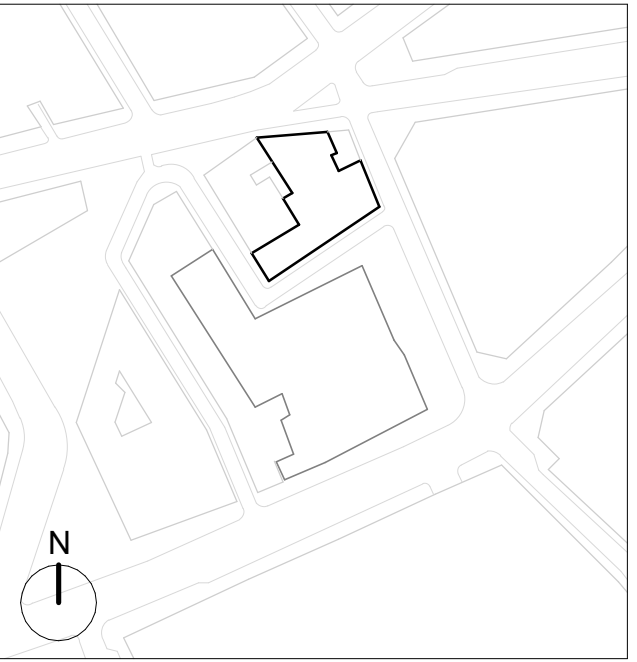

NOTES



GENERAL NOTES:

Existing drawings are for reference only - not for approval.
Planning Boundary shown is intended to align with proposed West End
Project Easement along High Holborn, and is based on available
information as submitted.

KEY

Planning Boundary

A 01.06.22 IM Issued for Planning Addendum
- 22.03.21 IM Issued for Planning

PLANNING

rev	date	author / check	comments
DSDHA 357 Kennington Lane London SE11 5QY T 020 7703 3555 F 020 7703 3890 E info@dsdha.co.uk W www.dsdha.co.uk			
project Museum Street and West Central Street			
London, WC1A 1JR			
drawing title WCS - Existing Roof Plan			
drawn	size	date	scale
Author	A1	22/03/21	1 : 100
drawing number			revision
295B_P10.185			A
REPORT DISCREPANCIES DO NOT SCALE FROM THIS DRAWING COPYRIGHT DSDHA		USE LATEST REVISION CHECK DIMENSIONS ON SITE	