

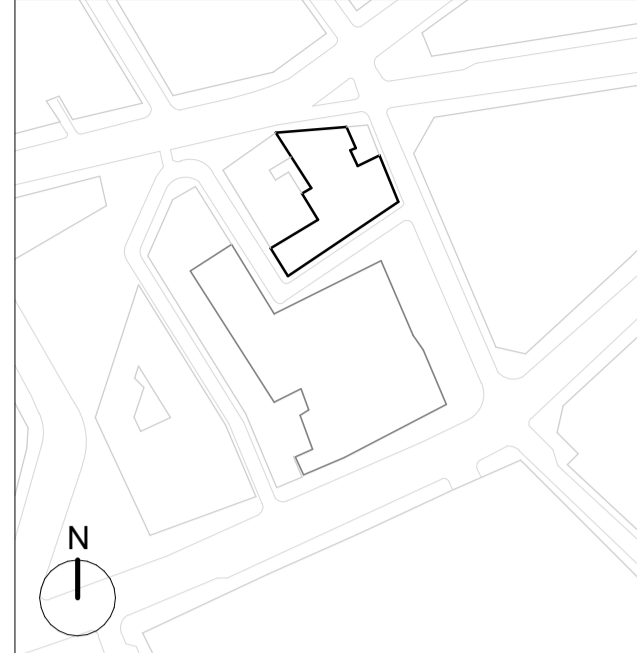

NOTES



GENERAL NOTES:
 Existing drawings are for reference only - not for approval.
 Planning Boundary shown is intended to align with proposed West End
 Project front setbacks along High Holborn, and is based on available
 information as submitted.

KEY
 — Planning Boundary

A 01.06.22 IM Issued for Planning Addendum
 22.03.21 IM Issued for Planning

PLANNING

DSDHA
 357 Kennington Lane London SE11 5QY
 T 020 7703 3555
 F 020 7703 3890
 E info@dsdha.co.uk
 W www.dsdha.co.uk

project
Museum Street and West Central Street

London, WC1A 1JR
 drawing title

WCS - Existing Basement Plan

drawn	size	date	scale
Author	A1	22/03/21	1:100
drawing number	revision		

295B_P10.179	A
--------------	---

REPORT DISCREPANCIES DO NOT SCALE FROM THIS DRAWING COPYRIGHT DSDHA

USE LATEST REVISION CHECK DIMENSIONS ON SITE