

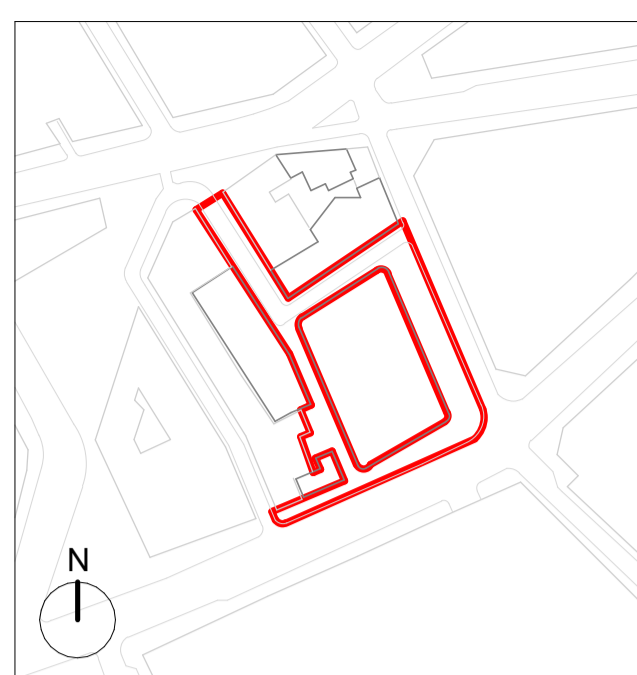

NOTES



GENERAL NOTES:
 Areas are approximate and subject to change throughout planning, design and development of the proposals.
 Area measurement definitions have been taken from IPMS but area interpretations should be measured and verified by Quantity Surveyor.
 - Planning Boundary shown is intended to align with proposed West End Project kerb extents along High Holborn. Post-submission amendment to sit-built kerb line may be required.
 - Museum Street landscape proposals are indicative only.
 - Hatches on the drawings are indicative only.
 - Existing public realm elements based on survey.
 - All dimensions to be verified on site before proceeding.
 - Plant layouts are indicative only.
 - All materials shown or highlighted are indicative only and may be subject to changes made during detailed design development.
 - Planning Boundary shown is intended to align with proposed West End Project kerb extents along High Holborn, and is based on available information as submitted.

- PLANNING BOUNDARY
- Silt Drain
- Gully
- French drain
- +24.100 Proposed level
- +24.100 Existing Level
- TOB Top of bench
- TOW Top of wall
- TOK Top of kerb

Refer to
 - Drawing P20.006 for Landscape GA Plan
 - Drawing P20.010 for Landscape Kerb type Plan
 - Drawing P20.012 for Landscape Furniture Plan

| | | | |
|---|----------|----|------------------------------|
| A | 01.06.22 | IM | Issued for Planning Addendum |
| - | 22.03.21 | CG | Issued for Planning |

PLANNING

DSDHA
 357 Kennington Lane London SE11 5QY
 T 020 7703 3555
 F 020 7703 3890
 E info@dshda.co.uk
 W www.dshda.co.uk

project
Museum Street and West Central Street
 London, WC1A 1JR
 drawing title

Proposed Landscape - GF - Levels and Drainage Intent Plan

| drawn | size | date | scale |
|----------------|----------|----------|-------|
| CG | A1 | 02/01/21 | 1:200 |
| drawing number | revision | | |
| 295_P20.011 | A | | |

REPORT DISCREPANCIES DO NOT SCALE FROM THIS DRAWING COPYRIGHT DSDHA USE LATEST REVISION CHECK DIMENSIONS ON SITE

