

**THIS DRAWING IS COPYRIGHT:**  
 DIMENSIONS SHOULD NOT BE SCALED FROM THE  
 DRAWINGS FIGURED DIMENSIONS TO BE USED &  
 CHECKED ON SITE PRIOR TO START OF ANY WORK

| REVISIONS    | Date       | Inl |
|--------------|------------|-----|
| <b>A</b>     |            |     |
| Bin store    | 08/03/2022 | NB  |
| <b>B</b>     |            |     |
| Sedum detail | 04/08/2022 | NB  |

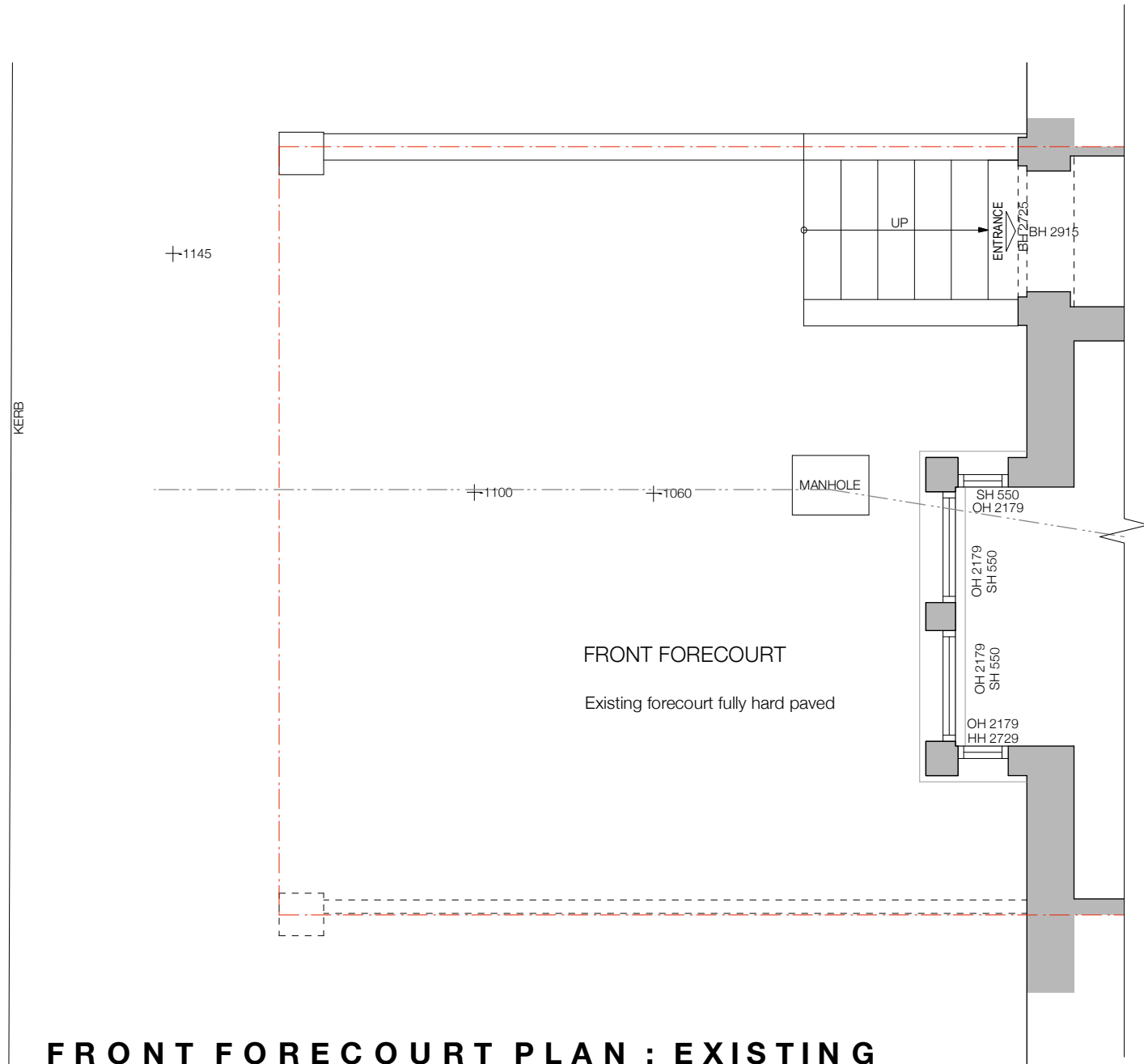

**FRONT FORECOURT PLAN : EXISTING**

Scale 1:50

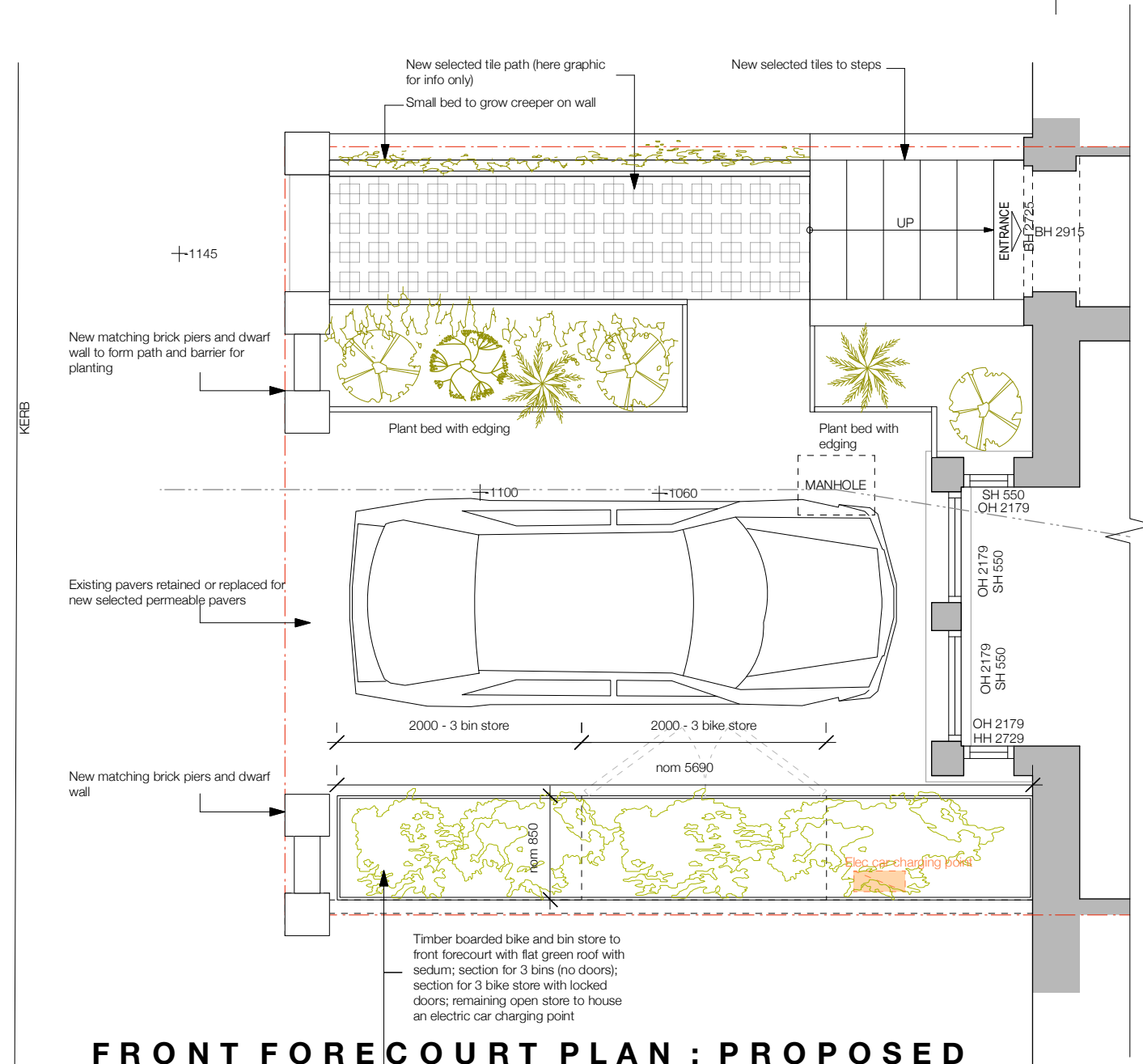

**FRONT FORECOURT PLAN : PROPOSED**

Scale 1:50

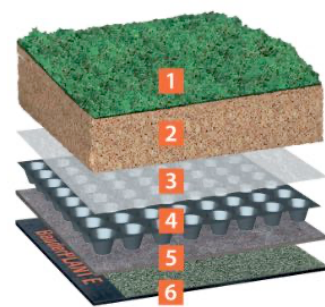

**Bauder SB Sedum Blanket system:**

- 1 - SB sedum blanket made of more than 14 species of sedum
- 2 - 100mm substrate
- 3 - Filter fleece
- 4 - DSE 20 water retention and drainage layer
- 5 - FSM 600 protection layer
- 6 - EPDM water proof membrane to be installed over a 18mm WBP plywood deck and treated softwood support structure

Sedum roof to be checked monthly by client and/or clients gardener for maintenance of sedum, providing additional water and nutrients as required for good health



**SIDE ELEV**

Bin + bike store with oiled or painted timber board finish; green sedum roof

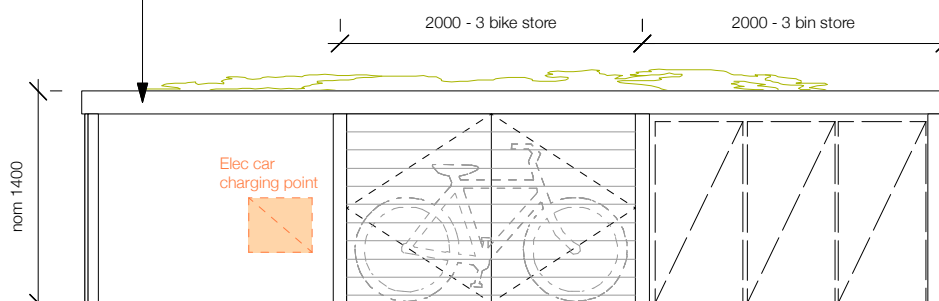

**BIKE + BIN STORE FRONT ELEVATION**

**BIN STORE SEDUM ROOF DETAIL SECTION**

Scale N.T.S



**SCHEME LEVEL**

**Job:** 47A Hillfield Road, NW6  
**Client:** A. Rahman & D. Sathe  
**Title:** Front Forecourt Plan : Existing + Proposed  
**Scale:** 1:50 @ A3  
**Drawing No:** 21/07/19  
**Rev:** NB  
**Drawn by:** NB  
**Date:** 04/03/2022

