

1  
310

Stalls Bar - Internal Elevation B

**Key**  
Existing  
Existing demolished  
Proposed

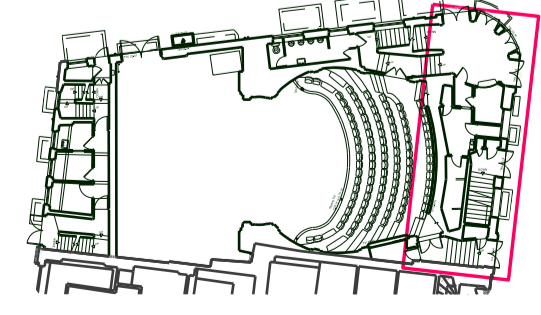

**KEY**  
--- Site Boundary  
New Building  
Existing Building  
  
**FLOOR CEILING TAGS**  
Ceiling Type  
Floor Type  
See drawing 2201-5-515 & 526 for floor types  
See drawing 2201-5-520 for ceiling types

**PARTITION TYPES**  
P1 Bar pocket door  
P2 Curved wall to Boxes  
P3 FR60, 60dB Partition  
P4 FR60, 60dB Partition  
P5 Tiled wall lining  
P6 FR60 Wall lining  
  
See drawings 1601-5-109 to 112 for partition location  
See drawings 1601-5-510 for partition and lining details.

**FLOOR TYPES**  
F1 New timber raised floor on battens, non-slip finish to Dimmer Room  
F2 New levelled raised timber floor on battens to SE details  
F3 New levelled carpet floor on battens  
F4 New raised timber floor on battens to boxes to SE details  
F5 Non-slip Linoleum/Vinyl finish on latex levelling screed on existing concrete floor  
F6 New carpet finish on existing timber floor build up  
F7 New rake timber floor on battens to SE details  
F8 New circle timber steps  
F9 New carpet floor finish to circle rake and existing stairs  
F10 Timber floor finish to new Lift Lobby  
F11 Floor threshold between Floor Type F2 and Floor Type F3/F5  
See drawings 1601-5-109 to 112 for flooring locations

**BAR EQUIPMENT**  
HWB Hand Wash Basin  
SK Single Sink  
TU Tilt Unit  
BS Bottle Skip  
IC Ice Chest  
GW Glasswasher  
IM Ice Machine  
UF Upright Freezer  
CSR Single Speed Rail  
LCS Shelf Unit  
Condiment Set  
Leg Frame  
DBC Bottle Cooler  
Base Unit Shelves  
Bar Worktop  
Bar Front  
Bar Portal  
Mirror  
Bar Skirting  
Bar Foot Rail  
Drink Shelves  
DS1 Drink Shelves  
DS2 Drink Shelves  
TDD Tiered Drink Display

THE CONTRACTOR IS TO CHECK AND VERIFY ALL BUILDING AND SITE DIMENSIONS, LEVELS AND SEWER INVERT LEVELS AT CONNECTION POINTS BEFORE WORK STARTS  
  
THIS DRAWING IS TO BE READ AND CHECKED IN CONJUNCTION WITH ENGINEERS AND OTHER SPECIALIST DRAWINGS  
  
THE DRAWING AND THE WORKS DEPICTED ARE THE COPYRIGHT OF THIS PRACTICE AND MAY NOT BE REPRODUCED EXCEPT BY WRITTEN PERMISSION

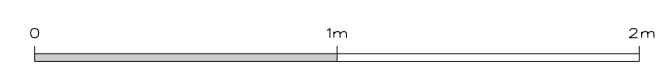

C	20/09/22	Planning			
B	18/08/22	For BC Review			
A	13/07/22	Planning			
Rev:	Date:	Description			

Job: 2201 Ambassadors Theatre  
Client: Ambassador Theatre Group

Drawing: Stalls Bar Plan  
Drawing no: 2201-3-310  
Scale: 1:50@A3, 1:25@A1  
Rev: C  
Status: Stage 3  
Date: 02/09/22

**citizensdesignbureau**  
Ground Floor Units 11 & 12, 6 Westgate Street, London, E8 3RN  
t : 02030959732  
e : everyone@citizensdesignbureau.net