

St. Martin's Theatre

New min. 37dB FD60s door to match existing doors

Allow for removable seats for additional wheelchair spaces

1no permanent wheelchair spaces

New FCU to serve back of house area. Core drill from basement to roof in corridor to run new services to FCUs

New radiators installed to dressing rooms

CL and FL shown in Basement (Sub stage) plan

WCL 23.46 C-H 1.33

WCL 19.92 C-H 1.29

New floor trenches in floor depth for AV and stage lighting cable runs from stage to new control room

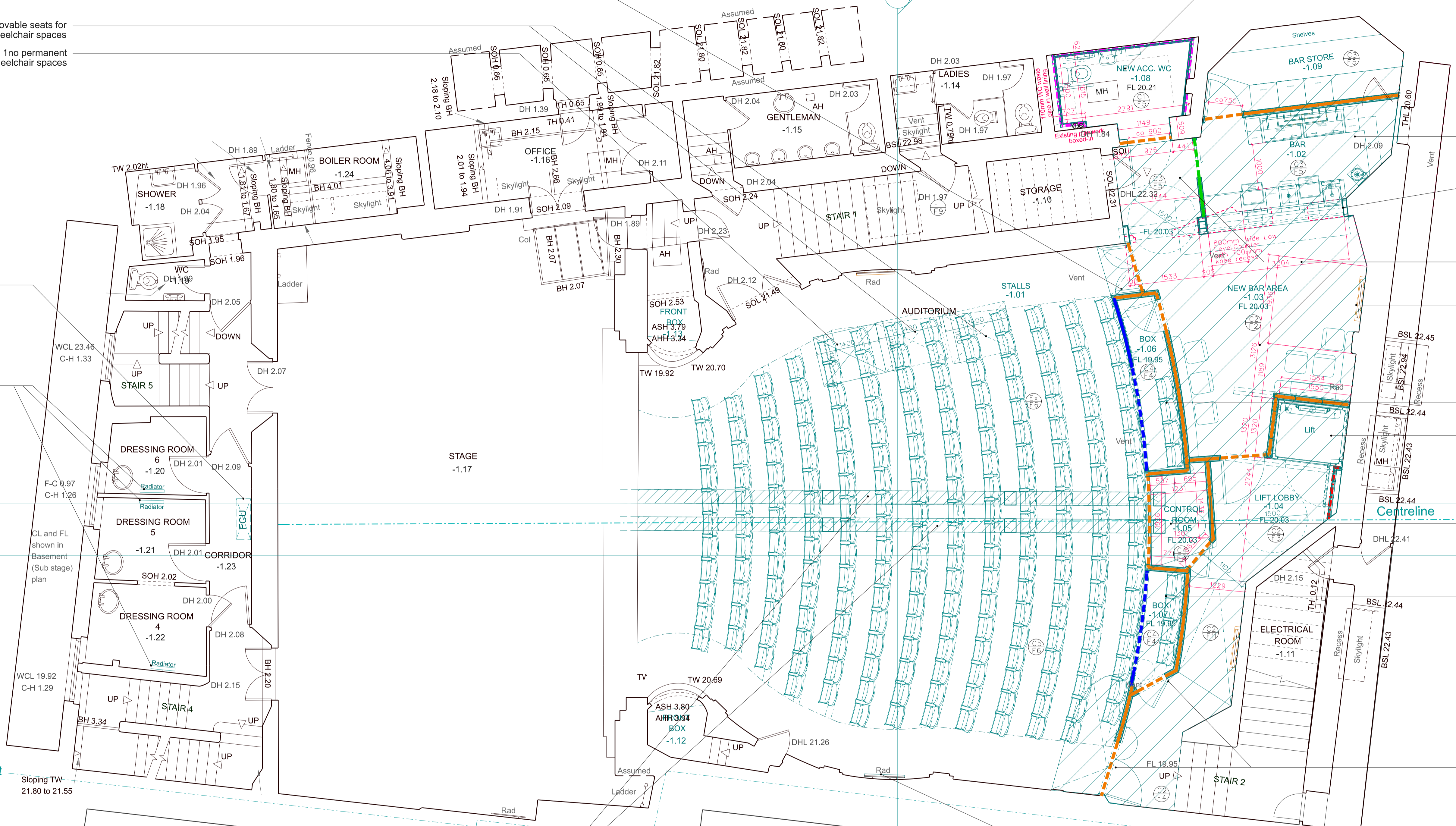

Reduced scope of demolitions
 New accessible WC obtained within existing Store
 New services concealed within new wall linings
 New waste pipework to connect into existing pipework with no disruption to existing floor

Reduced scope of demolitions in bar area
 New picture frame to Structural Engineer details

Regrade floor throughout the bar area to allow for level access from auditorium to Lift and Accessible WC

Existing water-fed cast iron radiators retained, refurbished and retrofitted to be electrical radiators to M+E details.
 Radiator and marble shelf relocated along wall away from lift

New seating box

Reduced scope of demolitions
 New platform lift with shallow pit created above existing concrete slab - existing slab not affected by the works

New Control Room & Store in symmetrical location

New seating box

New FD60s doors along new wall at back of stalls

Existing radiators retained
 Existing water-fed cast iron radiators retained, refurbished and retrofitted to be electrical radiators to M+E details.
 Radiator and marble shelf relocated along wall away from lift

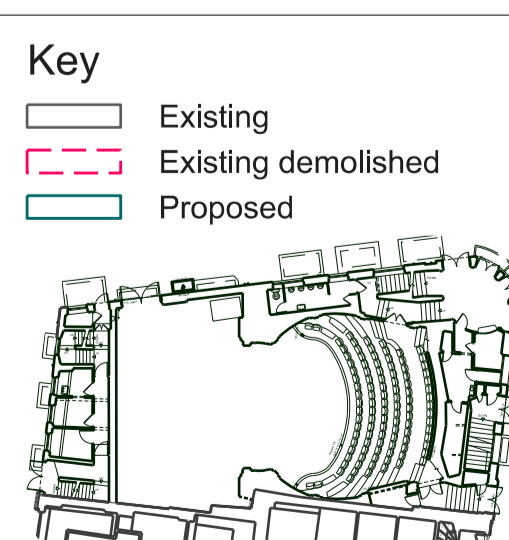

KEY		PARTITION TYPES		FLOOR TYPES	
[Solid Line]	Existing	[Green Line]	Bar pocket door	[Blue Hatched]	F1 New timber raised floor on battens, non-slip finish to Dimmer Room
[Dashed Line]	Existing demolished	[Blue Line]	Curved wall to Boxes	[Pink Hatched]	F2 New levelled raised timber floor on battens to SE details
[Dotted Line]	Proposed	[Purple Line]	FR60, 60dB Partition	[Yellow Hatched]	F3 New levelled carpet floor on battens
[Thick Solid Line]	Proposed	[Orange Line]	FR60, 60dB Partition	[Light Blue Hatched]	F4 New raised timber floor on battens to boxes to SE details
[Thin Solid Line]	Proposed	[Red Line]	Tiled wall lining	[Dark Blue Hatched]	F5 Non-slip Linoleum/Vinyl finish on latex levelled screed on existing concrete floor
[Thin Dotted Line]	Proposed	[Pink Line]	FR60 Wall lining	[Light Green Hatched]	F6 New carpet finish on existing timber floor build up
[Circle with 'C']	FLOOR CEILING TAGS	[Red Line]	FR60 Wall lining	[Light Blue Hatched]	F7 New rake timber floor on battens to SE details
[Circle with 'F']	Ceiling Type	[Red Line]	FR60 Wall lining	[Light Green Hatched]	F8 New circle timber steps
[Circle with 'FL']	Floor Type	[Red Line]	FR60 Wall lining	[Light Blue Hatched]	F9 New carpet floor finish to circle rake and existing stairs
[Circle with 'F2']	Floor Type	[Red Line]	FR60 Wall lining	[Light Green Hatched]	F10 Timber floor finish to new Lift Lobby
[Circle with 'F3']	Floor Type	[Red Line]	FR60 Wall lining	[Light Blue Hatched]	F11 Floor threshold between Floor Type F2 and Floor Type F3/F5

See drawings 2201-5-515 & 526 for floor types

See drawing 2201-5-520 for ceiling types

See drawings 1601-5-109 to 112 for partition location

See drawings 1601-5-510 for partition and lining details.

See drawings 1601-5-109 to 112 for flooring locations

See drawings 1601-5-515 & 516 for details

Note:
 Replace exiting carpet floor finish throughout the auditorium space and stairs, install new floor in the LGF bar area.
 Allow for re-leveling of floor in the new LGF bar and lift area to accessible levels.
 Allow for decorating the whole auditorium and BOH spaces at front (on West Street Side) on LGF and GF where works occur.
 ALL pavement lights to be checked for leaks and repaired as required.
 Existing water-fed cast iron radiators retained, refurbished and retrofitted to be electrical radiators to M+E details.

221no new seats installed at Stalls level to match the details of the existing seats. Seating layout to allow for 1no permanent wheelchair space and 2no additional ones by removing 4no standard seats each.

Refer to M+E specifications for the proposed lighting, heating and ventilation strategy details.
 Refer to SE details for all structural alterations.

THE CONTRACTOR IS TO CHECK AND VERIFY ALL BUILDING AND SITE DIMENSIONS, LEVELS AND SEWER INVERT LEVELS AT CONNECTION POINTS BEFORE WORK STARTS

THIS DRAWING IS TO BE READ AND CHECKED IN CONJUNCTION WITH ENGINEERS AND OTHER SPECIALIST DRAWINGS

THE DRAWING AND THE WORKS DEPICTED ARE THE COPYRIGHT OF THIS PRACTICE AND MAY NOT BE REPRODUCED EXCEPT BY WRITTEN PERMISSION

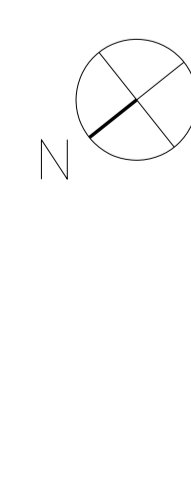

Rev:	Date:	Description:
D	20/09/22	Planning
C	06/09/22	Setting out for information
B	24/08/22	Lift Initial Setting Out
A	13/07/22	Planning
/	17/06/22	Planning

Job: 2201 Ambassadors Theatre
 Client: Ambassador Theatre Group

Drawing: Proposed LGF - Stalls Plan
 Drawing no: 2201-3-109
 Scale: 1:50@A1, 1:100@A3
 Rev: D
 Status: Stage 3
 Date: 17/06/22

citizensdesignbureau
 Ground Floor Units 01 & 03, 6 Westgate Street, London, E8 3RN
 t : 02030959732
 e : everyone@citizensdesignbureau.net