

Repair ALL pavement lights where glazed bricks re damaged or missing and reinstate perimeter seals to prevent further water ingress. Seal tarmac open joints and cracks around pavement lights and building footprint generally to prevent further water ingress. Existing steelwork to be locally strengthened as required

Retain existing glass panelling to new Acc. WC - See Acc. WC elevation drawings
New accessible WC within existing Store. Pavement lights refurbished/ repaired to prevent water ingress

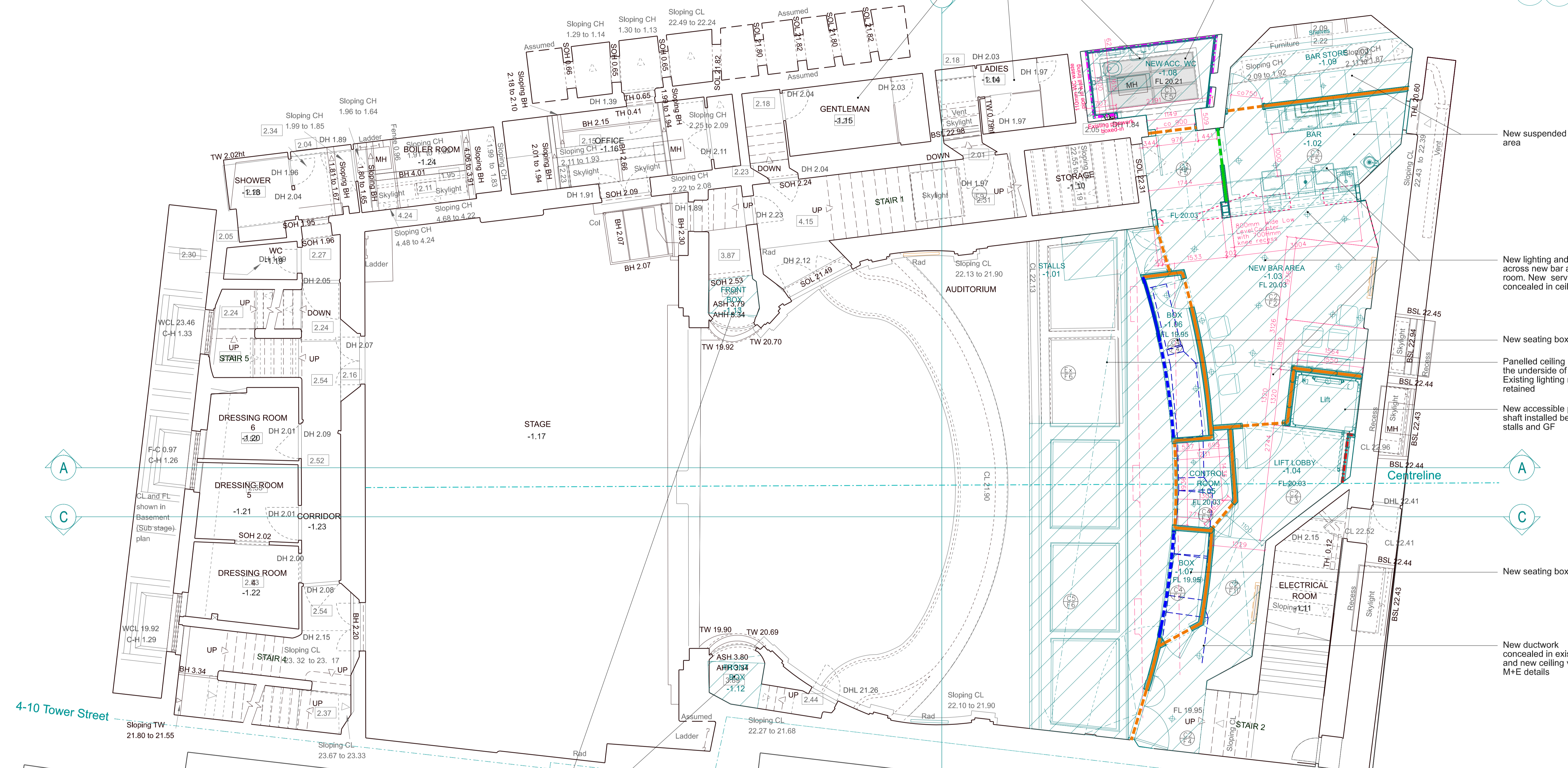

Phase 2
New bulkhead to ductwork and grilles above within existing boxes to M+E details. Allow for boxing in of ductwork and panelling to front of boxes

- New suspended ceiling in bar area
- New lighting and suspended ceiling across new bar area and control room. New services to be concealed in ceiling void
- New seating box
- Panelled ceiling reinstated across the underside of the circle rake. Existing lighting refurbished and retained
- New accessible platform lift shaft installed between LGF stalls and GF
- New seating box
- New ductwork concealed in existing and new ceiling void to M+E details

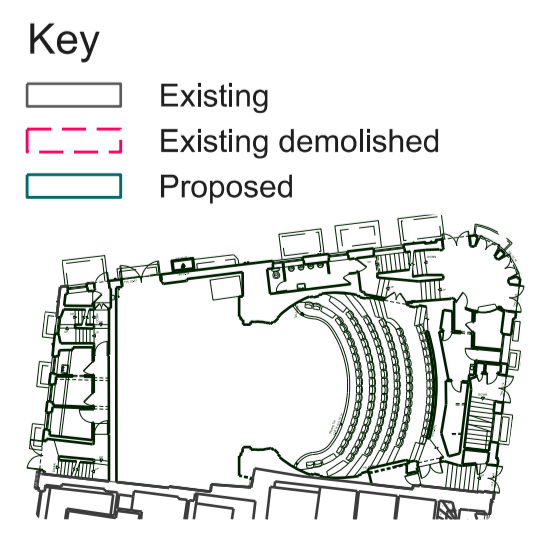

| KEY | PARTITION TYPES | CEILING TYPES |
|-------------------|---------------------------|--|
| Existing | P1 - Bar pocket door | EC - As Existing |
| New Building | P2 - Curved wall to Boxes | C1 - FR60mins - 25mm void |
| Existing Building | P3 - FR60, 60dB Partition | C2 - FR60mins - 250mm void |
| | P4 - FR60, 60dB Partition | C3 - FR60mins - 520mm void |
| | P5 - Tiled wall lining | C4 - 665mm void |
| | P6 - FR60 Wall lining | C5 - Fibre-plaster ceiling to match existing |
| | | C6 - FR60mins to steelwork |

FLOOR CEILING TAGS

CL - Ceiling Type
FH - Floor Type

See drawing 2201-5-515 & 526 for floor types
See drawing 2201-5-520 for ceiling types

See drawings 1601-5-109 to 112 for partition location
See drawings 1601-5-510 for partition and lining details
See drawings 1601-5-114 to 117 for ceiling type locations
See drawings 1601-5-520 & 521 for details

THE CONTRACTOR IS TO CHECK AND VERIFY ALL BUILDING AND SITE DIMENSIONS, LEVELS AND SEWER INVERT LEVELS AT CONNECTION POINTS BEFORE WORK STARTS

THIS DRAWING IS TO BE READ AND CHECKED IN CONJUNCTION WITH ENGINEERS AND OTHER SPECIALIST DRAWINGS

THE DRAWING AND THE WORKS DEPICTED ARE THE COPYRIGHT OF THIS PRACTICE AND MAY NOT BE REPRODUCED EXCEPT BY WRITTEN PERMISSION

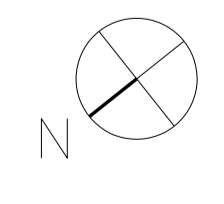

| Rev: | Date: | Description: |
|------|----------|---------------------|
| D | 20/09/22 | Planning |
| B | 25/08/22 | For review with M+E |
| A | 13/07/22 | Planning |
| / | 17/06/22 | Planning |
| Rev: | Date: | Description: |

Job: 2201 Ambassadors Theatre
Client: Ambassador Theatre Group

Drawing: Proposed LGF - Stalls RCP
Drawing no: 2201-3-115
Scale: 1:50@A1, 1:100@A3
Rev: D
Status: Stage 3
Date: 17/06/22

citizensdesignbureau
Ground Floor Units 01 & 03, 6 Westgate Street, London, E8 3RN
t : 02030959732
e : everyone@citizensdesignbureau.net