

Eleventh Floor Plan
1 : 100

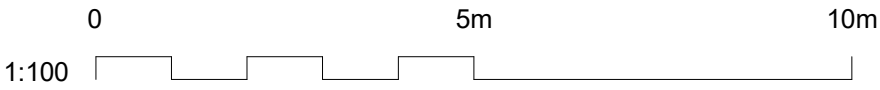

1. Do not scale from this drawing.
2. All dimensions are in millimetres unless otherwise stated.
3. This drawing is indicative only. This drawing is based upon information presented to Mott MacDonald for the purposes of RIBA Stage 2 Concept Design. Mott MacDonald are not responsible for the accuracy of the information. Any drawing errors or discrepancies should be brought to the attention of Mott MacDonald.
4. The designs shown are subject to detailed site survey, investigations, the CDM Regulations and the comments and/ or approval of various relevant Local Authority Officers, Statutory Undertakers, etc.
5. Any areas shown are approximate only and have been measured off preliminary drawings as the likely measured areas of the current design. These may be affected by future design development and construction tolerances.
6. This drawing is to be used for the purposes of assisting with design development and is not to be used for construction.
7. This drawing is to be read in conjunction with all relevant documents and drawings, including those from other disciplines.
8. No unauthorised use, disclosure, storage or copying.

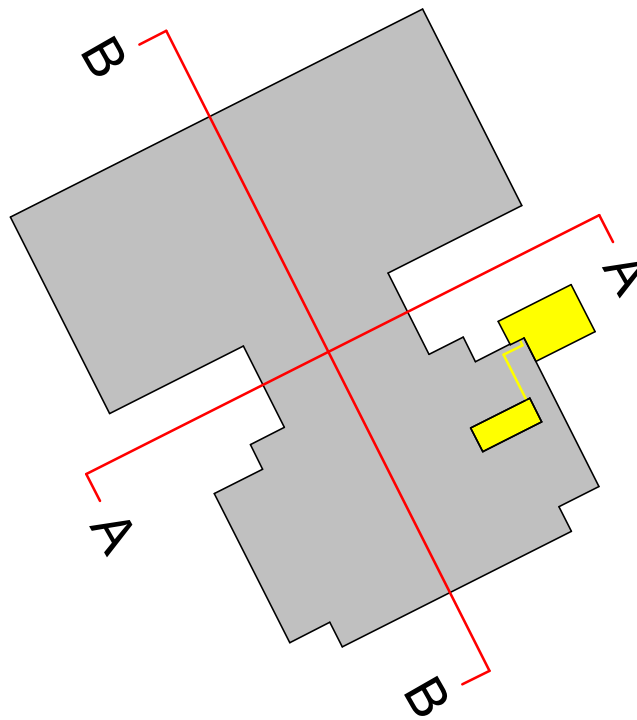

- New Build Elements
- Existing LSE Building

P1 08/09/22 DC Issued for Planning HB DC

Rev	Date	Drawn	Description	Ch'k'd	App'd
-----	------	-------	-------------	--------	-------



St Vincent Plaza
319 St Vincent St
Glasgow, G2 5LP
United Kingdom
T +44 (0)141 222 4500
F +44 (0)141 221 2048
W www.mottmac.com

Client
London School of Economics
Houghton Street
London
WC2A 2AE
UK

Title
LSE Generator Replacement
Eleventh Floor Plan

Designed	H.BUCHAN	HB	Eng.check.		
Drawn	H.BUCHAN	HB	Coordination	H.BUCHAN	HB

Dwg.check.	H.BUCHAN	HB	Approved	D.COZHILL	DC
------------	----------	----	----------	-----------	----

Scale at A1	Status	Rev	Security
As Shown	PRE	P1	STD

Drawing Number
400926 - MMD - XX - 11 - DR - A - 0014