

Copyright Hawkins\Brown Architects  
 No implied licence exists. This drawing should not be used to calculate areas for the purposes of valuation. Do not scale this drawing. All dimensions to be checked on the site by the contractor and such dimensions to be their responsibility. All work must comply with relevant British Standards and Building Regulations requirements. Drawing errors and omissions to be reported to the architect. To be read in conjunction with Architect's specification and other consultant information.

Rev	Description	Date
P01	Stage 2 Issue	04/06/18
P02	Issued for Information	08/11/18
P03	Issued for Information	13/11/18
P06	Issued for Information	07/01/18
P07	Issued for Information	11/01/19
P08	Issued for Information	28/01/19
P09	Issued for Information	15/02/19
P10	Issued for Information	25/02/19
P12	Stage 3 Draft Issue for Costing	15/03/19
P13	Stage 3 Issue	29/03/19
P14	Issued for Information	04/07/19
P15	Issued for Information	24/07/19
P16	Issued for Information	14/08/19
P17	Issued for Review & Comment/ Approval	20/09/19
P18	Updated to TLO comments	25/10/19
P19	Issued for Review & Comment/Approval Updated to capture agreed rationalisation items and instructed changes	31/01/20
P20	Issued for Review & Comment	11/12/20
P20.1	DWG WIP Issue for Information	22/02/21
P21	Issued for Review & Comment / Approval	05/03/21
P22	Issued for Review & Comment / Approval	18/07/21
P23	Issued for Review & Comment / Approval	11/08/21
P24	Issued for Review & Comment/ Approval	06/05/22

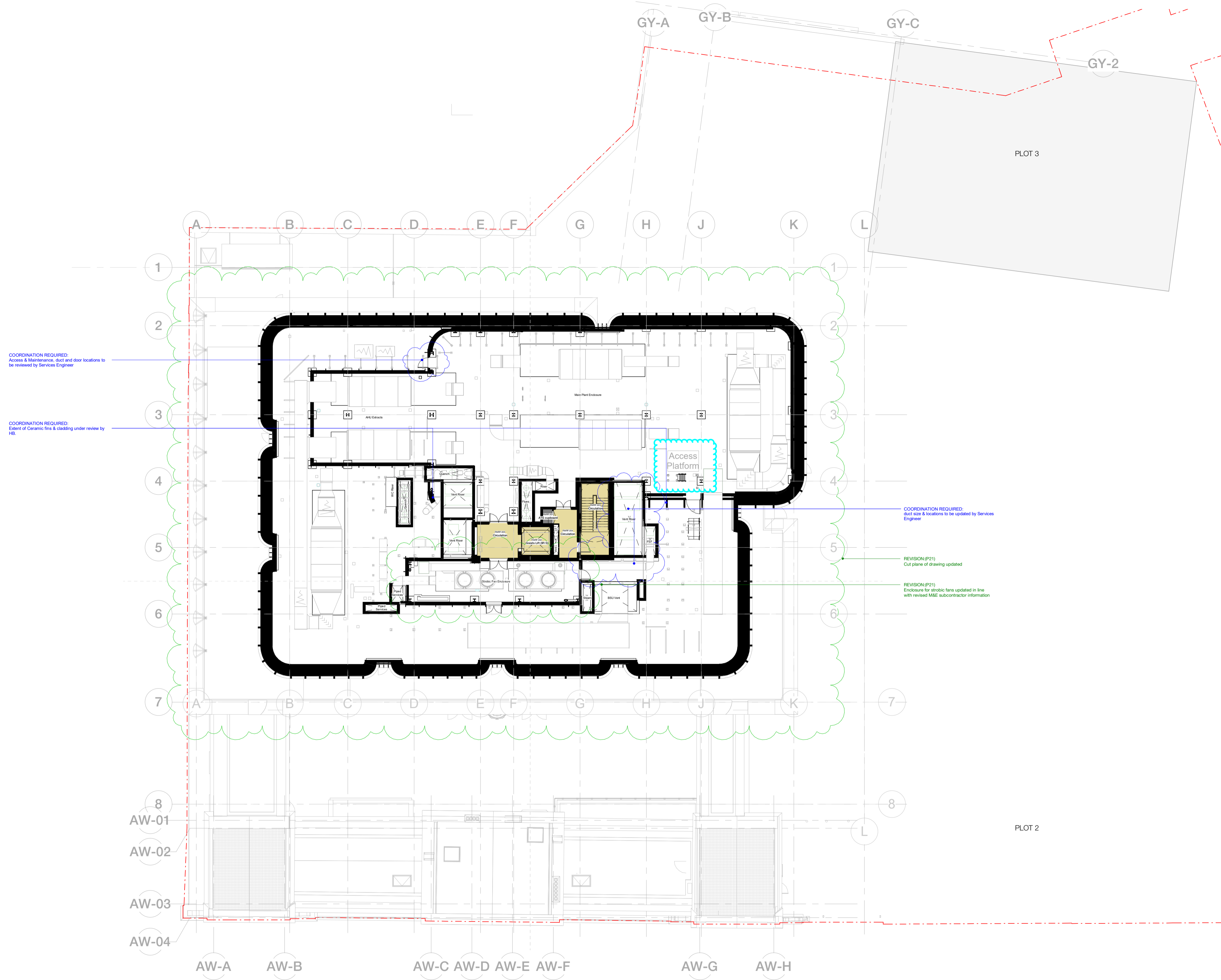

**COORDINATION NOTE:**  
 Roof plant undergoing further coordination with M&E subcontractor

159 St John Street  
 London EC1V 4QJ  
 mail@hawkinsbrown.com  
 hawkinsbrown.com

# Hawkins\Brown

Project  
 IoN/DRI Redevelopment Project  
 256 Grays Inn Road  
 London  
 WC1X 8LD

Drawing  
 Level Roof General Arrangement

Scale @ A1 1 : 200	Date 03/22/18	
Drawn By BN	Checked By EG	
Job Number 17056	Status S3/S4	Purpose of Issue For Review and Comment/Approval
Drawing No. BEMP-HBA-P1-RF-DR-A-20-0107	Rev P24	