

B

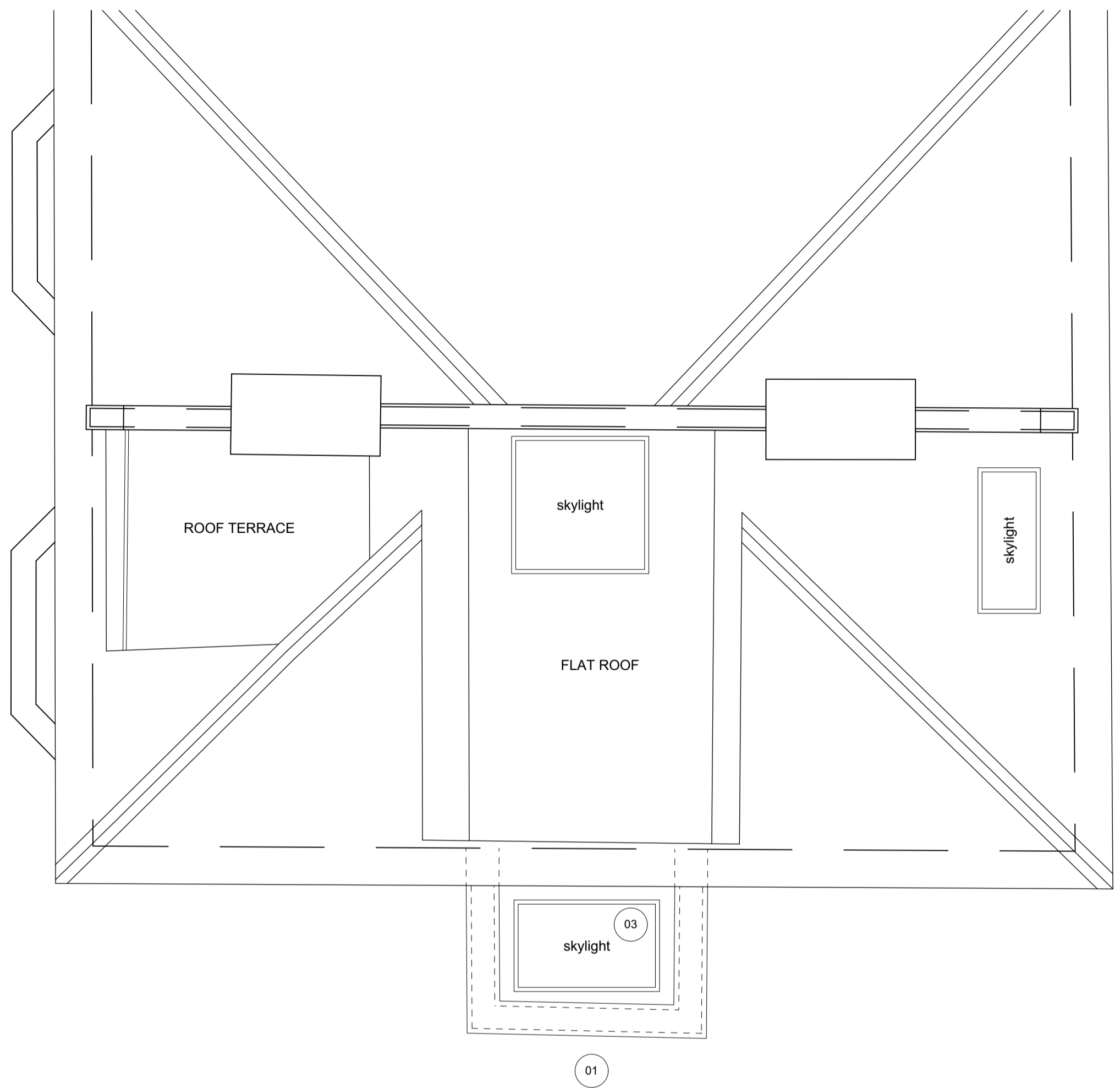

V

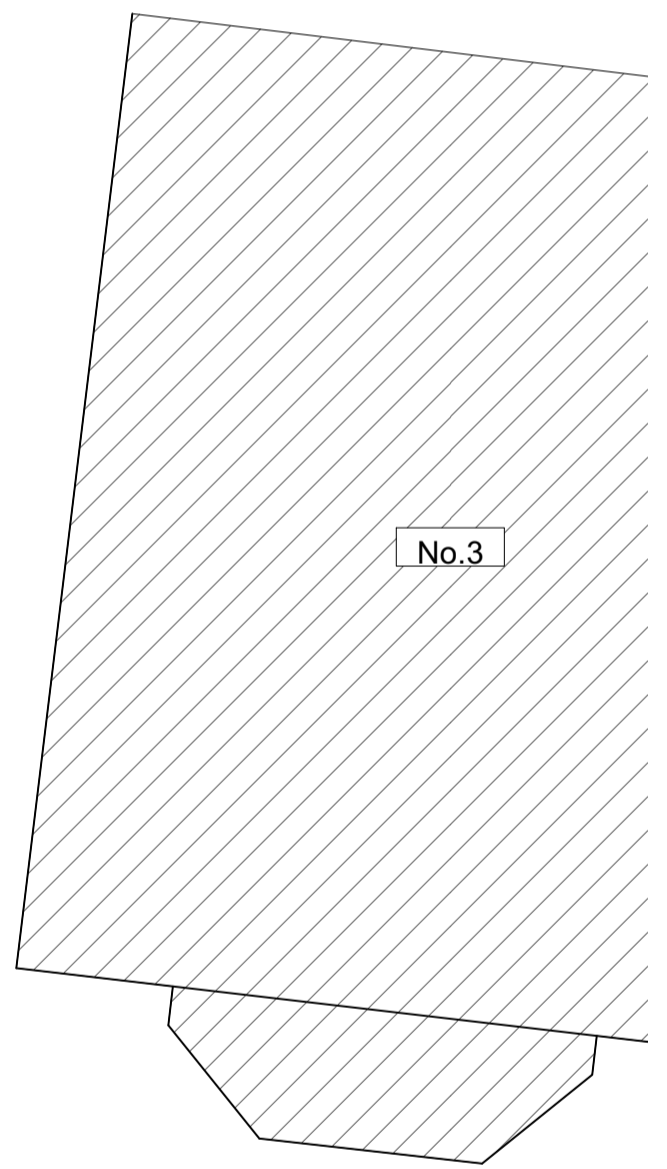

DISCLAIMER:
 FOR ACCURACY, ALL DIMENSIONS AND SPECIFICATIONS MUST BE CONFIRMED AT THE SITE AND WITH RELEVANT TECHNICAL DRAWINGS.
 TO BE READ IN CONJUNCTION WITH STRUCTURAL ENGINEER'S DRAWINGS AND SPECIFICATIONS.
 TO BE READ IN CONJUNCTION WITH SERVICE ENGINEER'S DRAWINGS AND SPECIFICATIONS.
 ANY DISCREPANCY BETWEEN DRAWINGS AND DIMENSION ON SITE ARE TO BE BROUGHT TO THE ATTENTION OF THE ARCHITECT PRIOR TO CONSTRUCTION.

© 2022 CHARLES TASHIMA ARCHITECTURE. ALL RIGHTS RESERVED.
 NO INFORMATION OR DESIGNS CONTAINED WITHIN THIS DOCUMENT SHOULD BE COPIED OR REPRODUCED WITHOUT THE CONSENT OF CHARLES TASHIMA ARCHITECTURE.

KEY

- 1 - Replacement of the second floor terrace with a new single-story closet-wing extension to form bathroom**
 - 2 - Introduction of new sash timber sash window in the side facade of the closet-wing extension, style to match existing windows.**
 - 3 - Introduction of a skylight in the flat roof of the closet wing extension**
- *All materials to match existing**

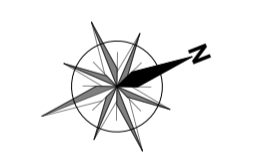

PLANNING

PROJECT: 1 SOUTH HILL PARK GARDENS LONDON NW3 2TD	
PROJECT NUMBER:	1122
PROJECT STAGE:	PLANNING
ISSUE DATE:	AUGUST 2022
SCALE:	1:50 @ A1 1:100 @ A3
DOCUMENT NUMBER:	115
REVISION:	

SUBJECT:
**PROPOSED PLAN
 ROOF - OP1**

CLIENT: Lauren Segal & Jonathan Broomberg

CHARLES TASHIMA ARCHITECTURE
 Unit 12A
 Blackstock Mews
 London N4 2BT
 Landline: +44(0)20 7281 2351
 Email: info@ct-arch.co.uk
 Website: www.ct-arch.co.uk

