

**DISCLAIMER:**  
 FOR ACCURACY, ALL DIMENSIONS AND SPECIFICATIONS MUST BE CONFIRMED AT THE SITE AND WITH RELEVANT TECHNICAL DRAWINGS.  
 TO BE READ IN CONJUNCTION WITH STRUCTURAL ENGINEER'S DRAWINGS AND SPECIFICATIONS.  
 TO BE READ IN CONJUNCTION WITH SERVICE ENGINEER'S DRAWINGS AND SPECIFICATIONS.  
 ANY DISCREPANCY BETWEEN DRAWINGS AND DIMENSION ON SITE ARE TO BE BROUGHT TO THE ATTENTION OF THE ARCHITECT PRIOR TO CONSTRUCTION.

© 2022 CHARLES TASHIMA ARCHITECTURE. ALL RIGHTS RESERVED.  
 NO INFORMATION OR DESIGNS CONTAINED WITHIN THIS DOCUMENT SHOULD BE COPIED OR REPRODUCED WITHOUT THE CONSENT OF CHARLES TASHIMA ARCHITECTURE.

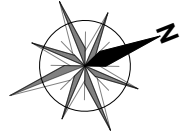
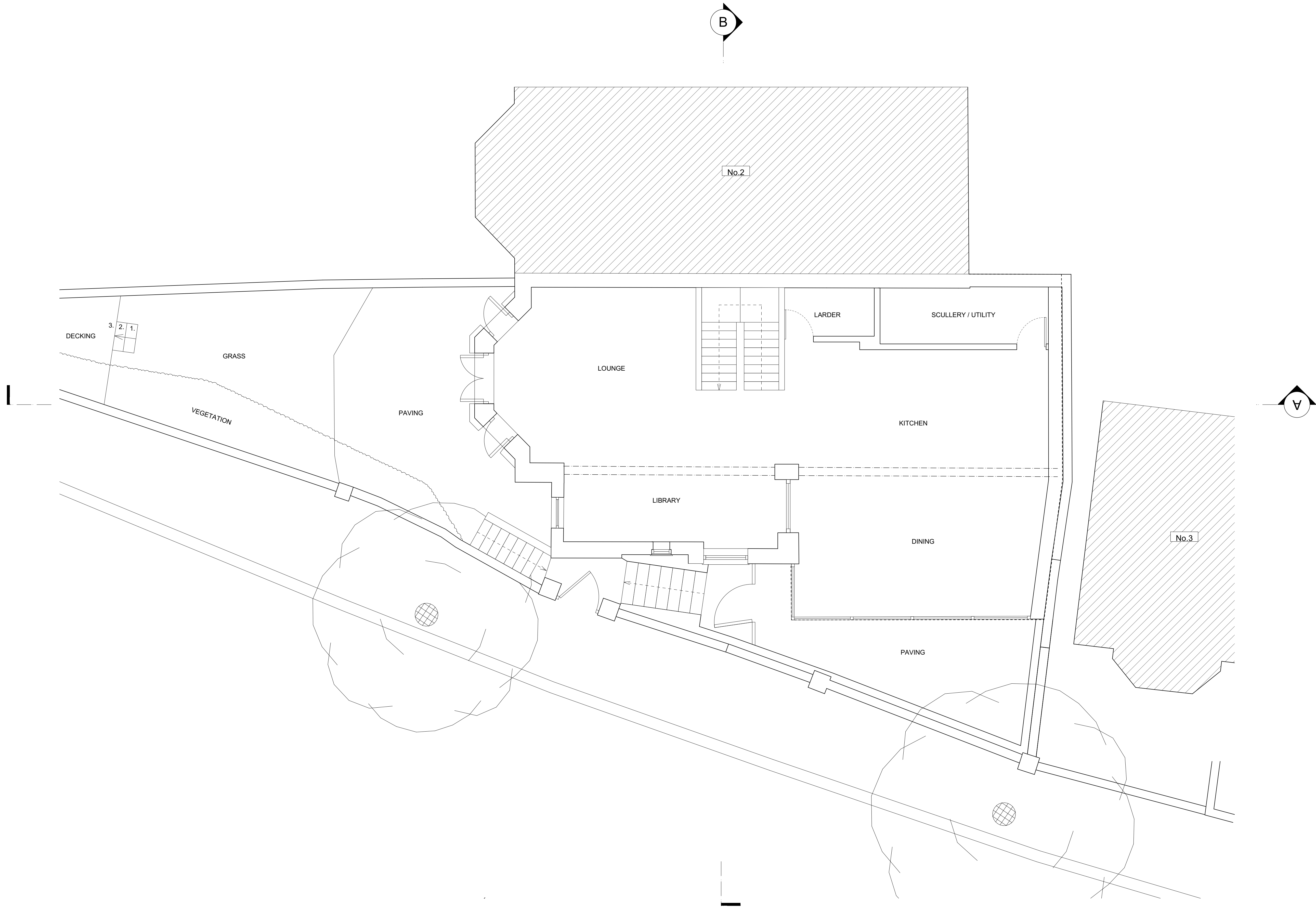

**PLANNING**

**PROJECT:**  
 1 SOUTH HILL PARK GARDENS  
 LONDON NW3 2TD

PROJECT NUMBER:	1122
PROJECT STAGE:	PLANNING
ISSUE DATE:	AUGUST 2022
SCALE:	1:50 @ A1 1:100 @ A3
DOCUMENT NUMBER:	100
REVISION:	

**SUBJECT:**  
 EXISTING PLAN  
 LOWER GROUND FLOOR

CLIENT: Lauren Segal & Jonathan Broomberg

**CHARLES TASHIMA ARCHITECTURE**  
 Unit 12A  
 Blackstock Mews  
 London N4 2BT

Landline: +44(0)20 7281 2351  
 Email: info@ct-arch.co.uk  
 Website: www.ct-arch.co.uk

