

© This drawing is the property of Miltiadou Cook Mitzman architects. No disclosure or copy of it may be made without the written permission of Miltiadou Cook Mitzman architects.

For construction purposes:

- Do not scale this drawing.
- All dimensions and levels to be checked on site.
- Discrepancies to be reported to Miltiadou Cook Mitzman architects before proceeding.
- If in any doubt about information on this drawing contact Miltiadou Cook Mitzman architects.

| REVISION | | | |
|----------|------------|----|---------------------|
| NUMBER | DATE | BY | NOTES |
| P1 | 27/01/2022 | ET | Issued for Planning |

KEY PLAN:

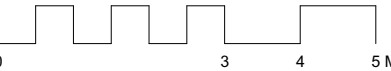
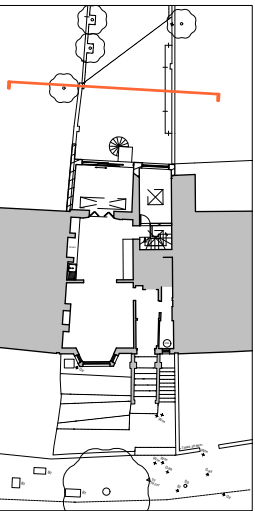

MILTIADOU COOK MITZMAN architects llp

020 7722 8525 Unit 1 Primrose Mews
office@mcma.design Sharpleshall Street
www.mcma.design London NW1 8YW

CLIENT
Yin Jones

PROJECT
14A King Henry's Road, NW3 3RP

SHEET TITLE
Elevation 2 - Revised Design with staircase

SCALE
1:100

DATE CREATED **FILE REFERENCE**

| DRAWING NUMBER | REVISION |
|----------------|----------|
| 363-DWG-128 | P1 |

No. 12

No. 14

No. 16



1 Existing North Elevation
1:100



2 Proposed North Elevation
1:100

MATERIAL KEY

- | | |
|---|---------------------------------------|
| ① LONDON STOCK BRICKWORK | ⑪ ALUMINIUM HINGED WINDOWS |
| ② SLATE TILES | ⑫ ALUMINIUM SASH WINDOWS |
| ③ TIMBER PAINTED SASH WINDOWS | ⑬ STONE COPING STONE SINGLE WEATHERED |
| ④ METAL RAILINGS | ⑭ EXISTING TIMBER FENCING |
| ⑤ TERRACOTTA CHIMNEY POT | |
| ⑥ PLASTIC DRAINAGE SYSTEM | |
| ⑦ SAND-CEMENT RENDER | |
| ⑧ POWDER COATED SLIDING ALUMINIUM DOORS | |
| ⑨ METAL STAIRCASE | |
| ⑩ GLAZED ROOF | |