

Plywood sheets where suspended ceiling tiles missing/ damaged in lift lobby

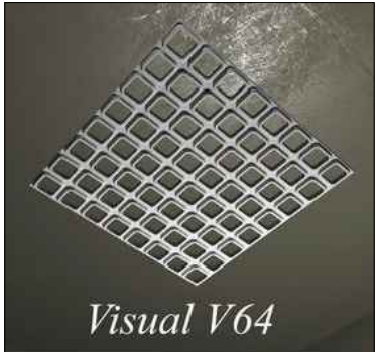

Typical damage to existing ceiling tiles



Obsolete and unavailable existing Armstrong Visual 64 600x600mm mineral fibre ceiling tiles throughout corridor and lift lobby

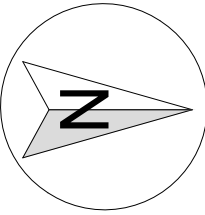
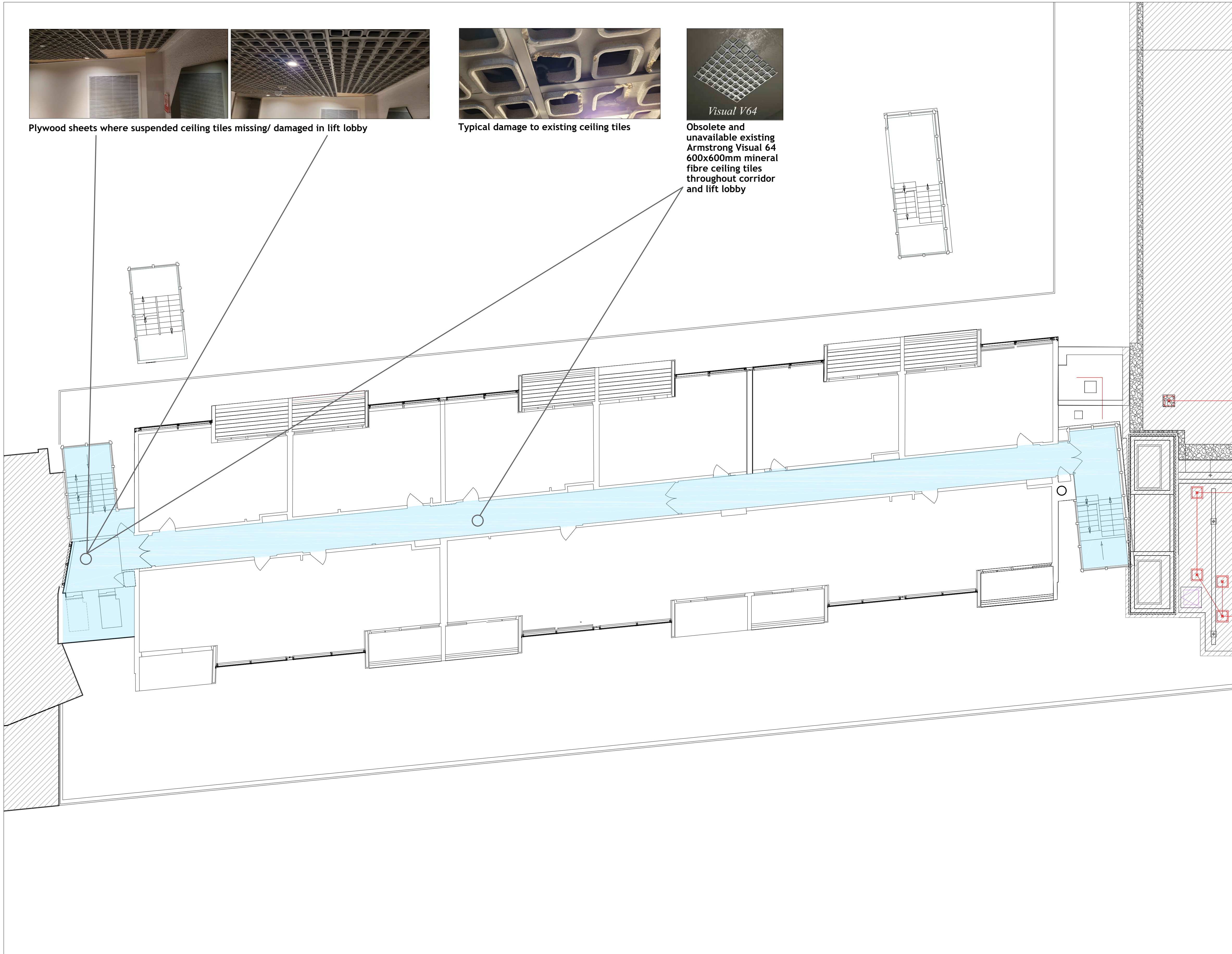

CONTRACTOR	
Harris Associates	
SITE ADDRESS	
Centre Point House 15a St. Giles High Street London, WC2H 8LW	
PROJECT NAME	
Existing Suspended Ceilings Centre Point House	
DRAWN BY	CHECKED BY
IFPL	N.GOULE
DRAWING NAME	DATE
Third Floor	7.2022
SCALE	DRAWING NUMBER
1:100@A1	HA-CPH-SC-5-ESC