

NOTES

KEY:

Areas outside site perimeter

Areas inside site perimeter

Areas of the tree protection zone outside the site perimeter indicated in red. No construction works to be carried out within these areas. If works are to be done outside of the footprint of the site, the tree exclusion zones shall be clearly marked and fenced off. No vehicular access unless specified when those needed for construction works such as light diggers, mini dumper mini piling machinery shall advance only over ground protection. No substances injurious to tree health, including fuels, oil, bitumen, cement (including cement washings), builders sand, concrete mixing and other materials shall be stored or used within or directly adjacent to the protection area of retained trees.

Areas of the tree protection zones within the site indicated in blue. With reference to the original tree report by Tree Aware UK Ltd, the tree roots of the adjoining properties are unlikely to have penetrated the perimeter boundary walls and their footings. No burning of materials and no release of hazardous substances are permitted within these areas. Furthermore, the use of plant shall be carefully coordinated to ensure no damage to the tree canopies which overlie the site boundary.

Areas of the tree protection zone outside the site perimeter indicated in red. No construction works to be carried out within these areas. If works are to be done outside of the footprint of the site, the tree exclusion zones shall be clearly marked and fenced off. No vehicular access unless specified when those needed for construction works such as light diggers, mini dumper mini piling machinery shall advance only over ground protection. No substances injurious to tree health, including fuels, oil, bitumen, cement (including cement washings), builders sand, concrete mixing and other materials shall be stored or used within or directly adjacent to the protection area of retained trees.

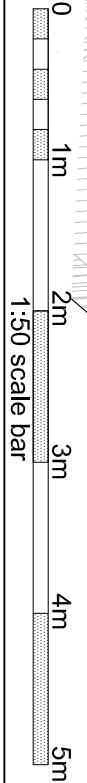
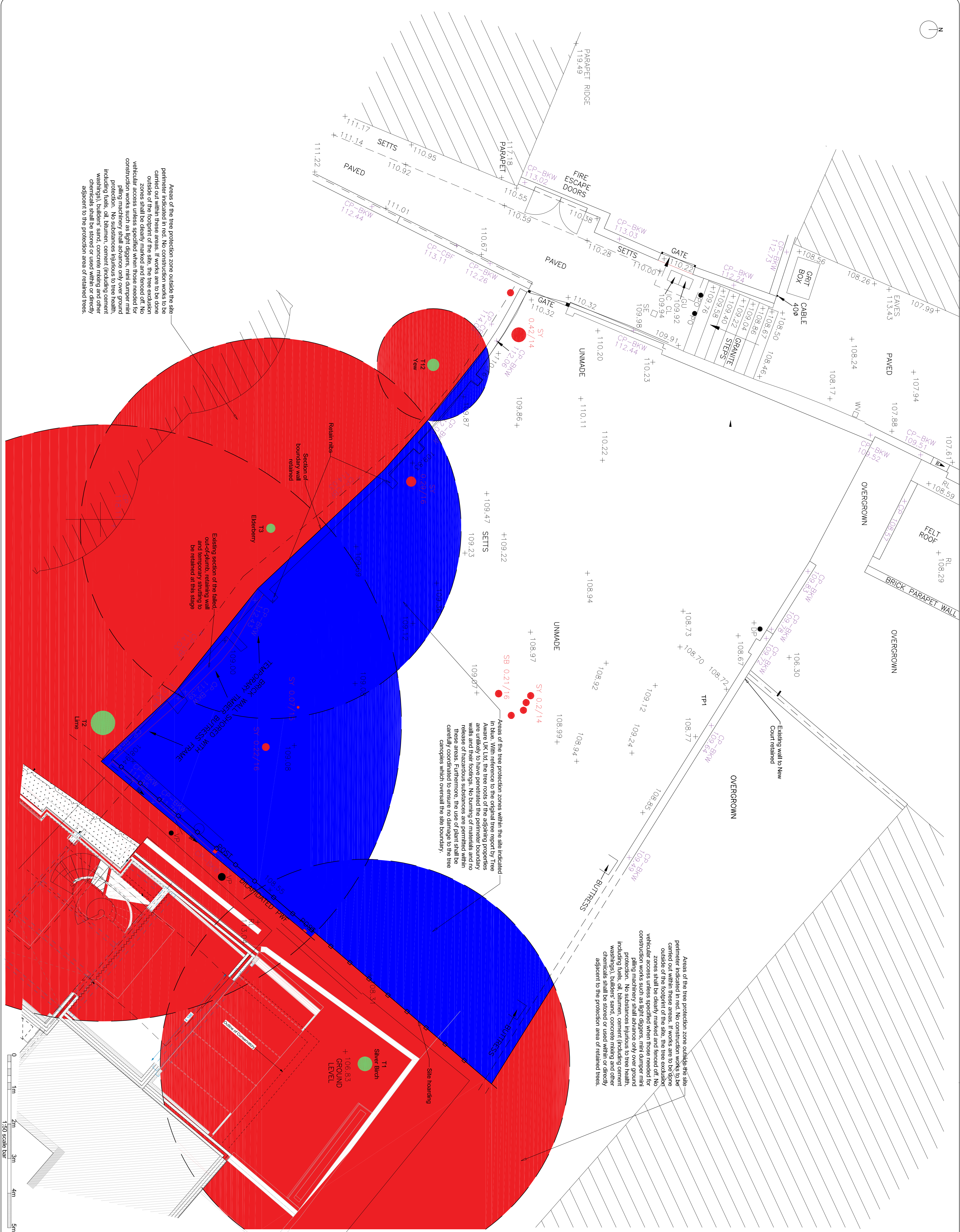

Drawn	UD	Date	Aug 22	Scale
Checked	MM	Date	Aug 22	As shown
Approved	SS	Date	Aug 22	Size A1
Drawing No.	20101-1326-T01			Rev.
				-

Retained Trees Protection
General Arrangement

Project
6 Streasley Place,
London NW3 1HP

S T S Structural
Engineering Ltd
58 Crossway, Watney Garden City, Hertfordshire, AL8 7TE
Tel: 01707 695466 Fax: 01707 693066
Web: www.sts-uk.co.uk Email: sales@sts-uk.co.uk

STREASLEY PLACE (HAMSTEAD) LIMITED

Rev.	Amendments	Date	Chkd.