

# PROPOSED ROOF PLAN

 **New Flat Roof**  
with green / brown roof finish

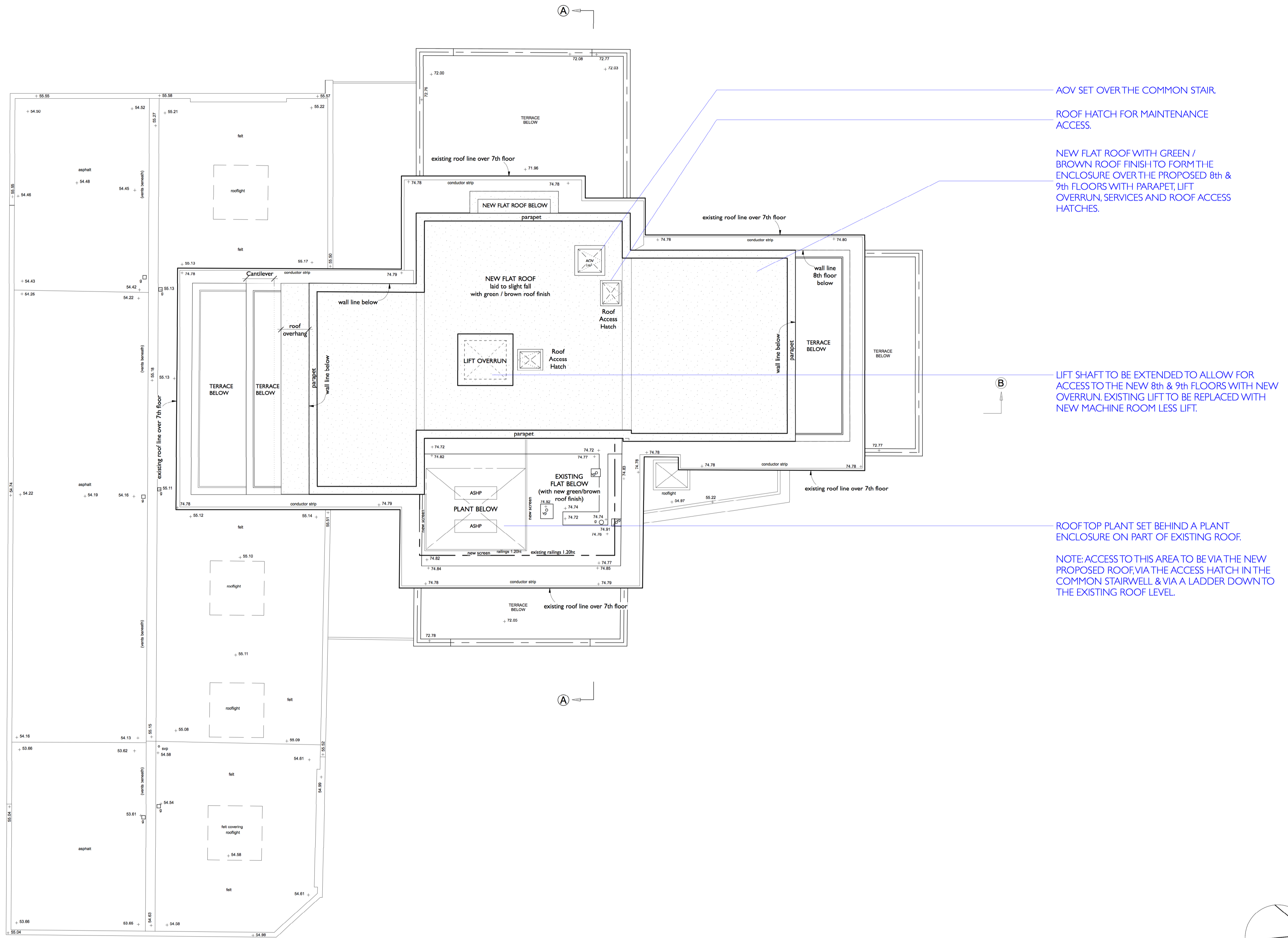

PARK LODGE  
No 1-25

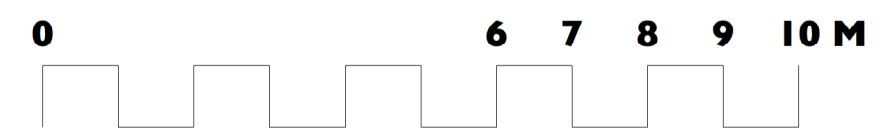
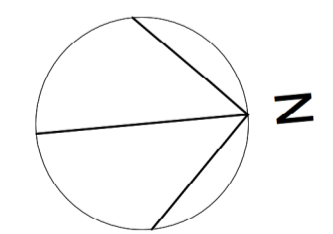

Unit 25, BASEPOINT  
EVESHAM  
WORCESTERSHIRE  
WR11 1GP  
t : 020 7328 2576  
Email: info@hubarchitects.co.uk

All dimensions are to be checked on site before commencement of works.  
All sizes and dimensions to any structural elements are indicative only. See structural engineer's drawings for actual sizes/dimensions.  
Sizes of and dimensions to any service elements are indicative only. See service engineer's drawings for actual sizes/dimensions.  
This drawing to be read in conjunction with all relevant Architect's drawings, specifications and other consultants' information.

Rev.	Date.	Description.
A	2201-26	General drawing update.
B	2203-15	General drawing update, AOV & vent added.
C	2204-19	General drawing update.
D	2204-26	General drawing update to notes & plant area.
E	2205-04	General drawing update to plant area.
F	2208-10	General drawing update AP2 terrace.
G	2208-11	General drawing update.

Initial.  
JC  
JC  
JC  
JC  
JC  
JC

## PERMITTED DEVELOPMENT

Project: 95 Avenue Road, London, NW8 6HY  
Drawing: Proposed Roof Plan  
Scale: 1:100 @ A1 & 1:200 @ A3  
Date: Jan 2021  
DWG: 1289 - PD - 114  
Revision: **G**