

General Notes
 This drawing is copyright of KSR architects. This drawing must be read in conjunction with the Designer's Risk Assessment, specification and all other relevant documentation and drawings.
 KSR architects accept no liability for any expense, loss or damage of whatsoever nature and however arising from any variation made to this drawing or in the execution of the work to which it relates which has not been referred to them and their approval obtained.
 Areas are based on un-checked survey and are approximate only. Do not scale from this drawing or the digital data, only figured dimensions are to be used. Refer to linear scale for guidance.
 Check all dimensions on the prior to carrying out any works and advise any discrepancy.

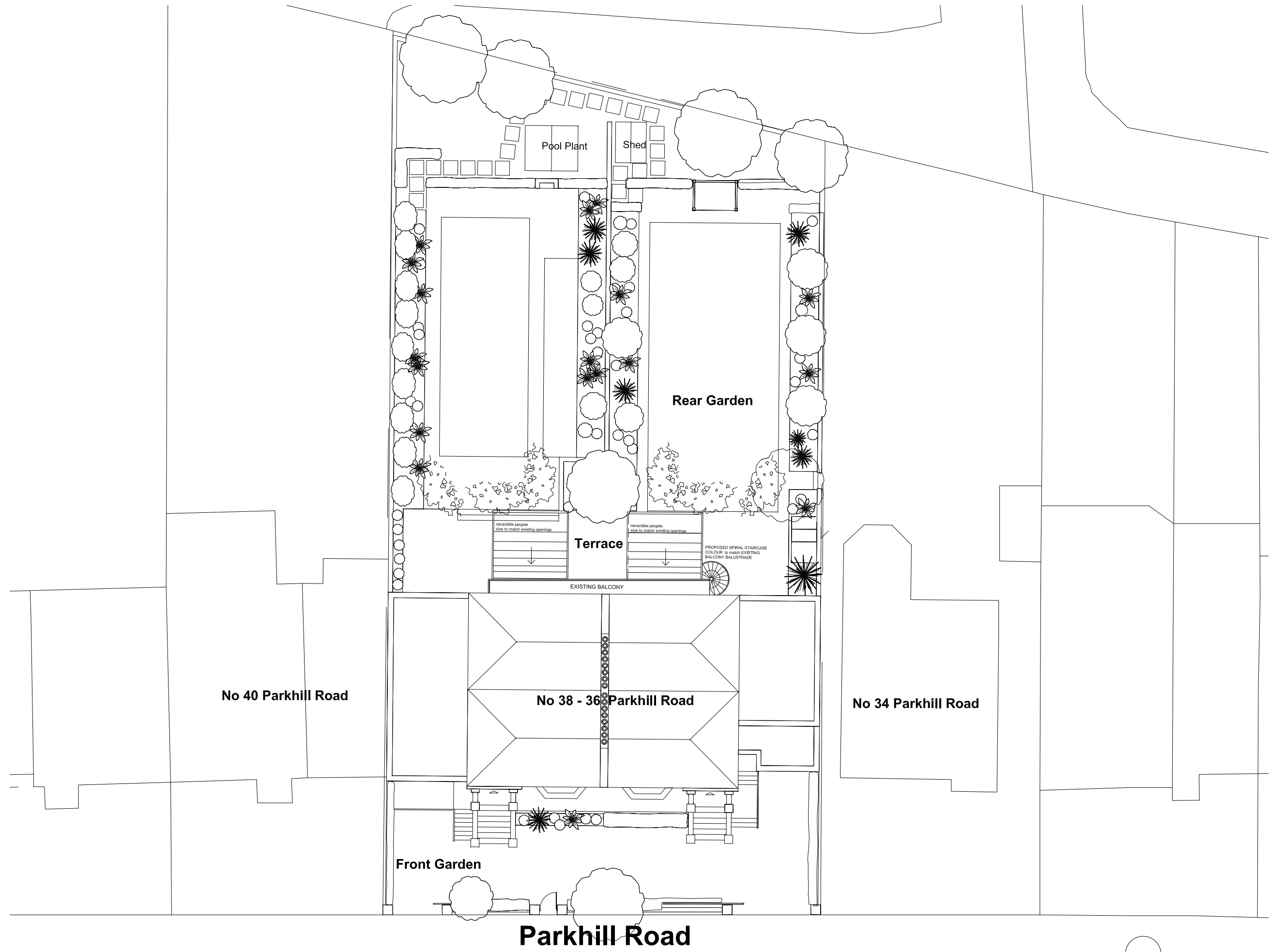

**PLANNING APPLICATION
 AS APPROVED PLANNING
 REFERENCE:2022/1806/P**

Rev.	Description	Date	By
1	Issued for Planning	30.08.2022	RM

KSR ARCHITECTS & INTERIOR DESIGNERS
 KSR Architects LLP
 14 Greenford Street
 London W5 0ND
 T: +44 (0)20 7892 5000
 www.ksrarchitects.com

Project:
36-38 PARKHILL ROAD

Drawing Title:
Site Plan As Approved

Date of first issue: 24.04.2022
 Scale: 1:200@A3
 Drawn By: RM
 Checked By: © KSR Architects

Drawing No: **21043-P-010A**
 Rev: .

