

General Notes
 Do not scale from this drawing
 All dimensions to be verified on site
 To be read in conjunction with all relevant documents
 In the event of discrepancy notify the Architect immediately
 This document is copyright of Hugh Cullum Architects Ltd

Issue Status
 SK Sketch E Existing Condition
 D Design P Permissions
 T Tender C Contract

Ridge Line
 AOD+ 10.59m

Loft Level
 AOD+ 09.24m

First Floor Level
 AOD+ 06.64m

Ground Floor Level
 AOD+ 03.87m

AOD Line
 AOD+ 00.00m

7157mm

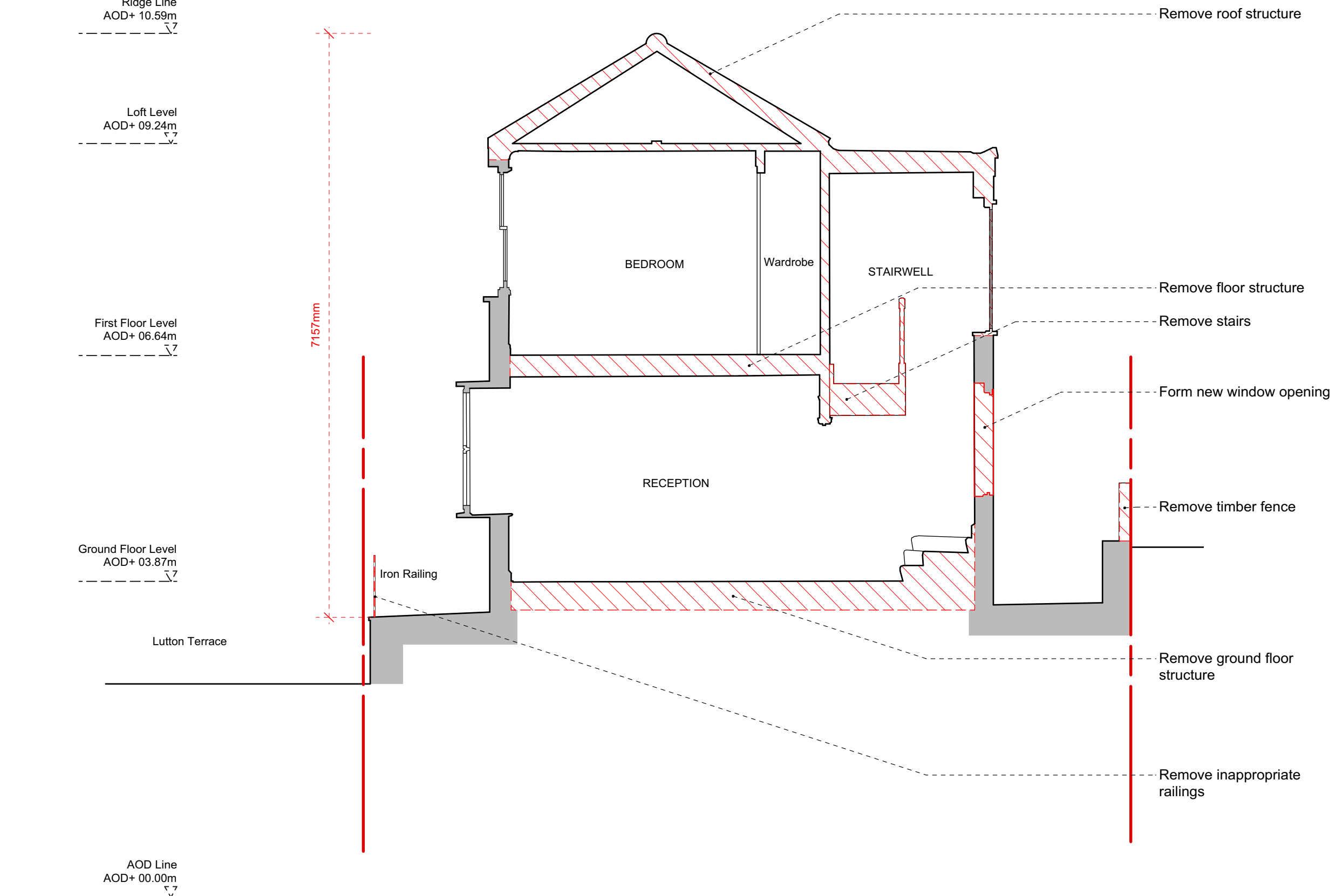

Remove roof structure

Remove floor structure

Remove stairs

Form new window opening

Remove timber fence

Remove ground floor structure

Remove inappropriate railings

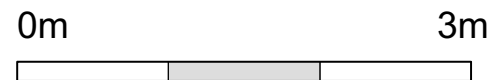

EXISTING_Section DD

Section DD

— Site boundary
 [Red hatched box] Structure demolished

(): Issued for Planning

(15.07.22 /TS/HC)

HUGH CULLUM
 ARCHITECTS LTD
 Bloomsbury Design
 61b Judd Street
 London WC1H 9QT
 t 020 7383 7647
 f 020 7387 7645
 mail@hughcullum.com

4 Lutton Terrace
 As Existing
 Section DD
 1:50@A3 Jul/2022
 Drawn: TS Checked: HC
 LT004-E203()