

- NOTES:
1. For roof structure, waterproofing, protection and insulation - Refer to Architects & Engineers details and specification
 2. Planters - raised planter system to be detailed by supplier / manufacturer, e.g. Logic or similar agreed
 3. Guardrails / balustrades - minimum 1.1m high from FFL, refer to Architect & Engineer's detail and specification and as agreed with approve inspector
 4. FFL and threshold details to Architect's design and specification
 5. Drainage outlets to Architects & Engineers details and specification
 6. Fixings to structural slab to be agreed / coordinated with Architects and Engineers
 7. External lighting shown indicatively - refer to lighting designer for details and specification of light fittings
 8. Electrical services - service runs, ducting, plug sockets etc. shown indicatively only - refer to Engineer's detail and specification
 9. Irrigation - automatic drip-line irrigation system required to all areas of intensive green roof planting. Irrigation system to be CDP by specialist Irrigation company, refer also to Engineer's details
 10. Refer to TLP-400 series drawings for detailed planting plans

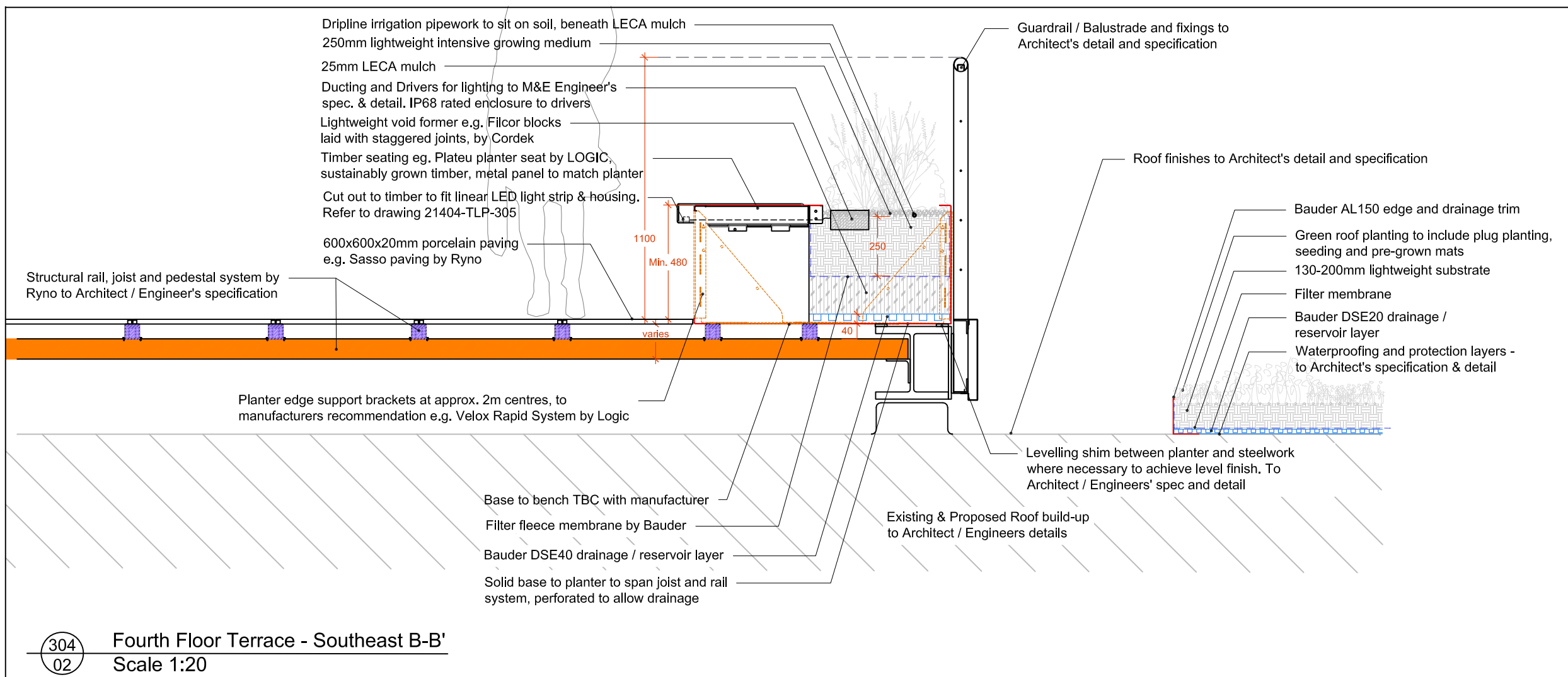

Revision	Number	By	Date
Minor amendments Additional lighting info, included and paving spec. amended	B A	RB RB	14-07-2022 05-07-2022



Project	Bedford 01234 261315 <input type="checkbox"/>
The MET Building	Woodbridge 01394 380509 <input type="checkbox"/>
	London 020 7252 0002 <input checked="" type="checkbox"/>
	Norwich 01603 230777 <input type="checkbox"/>
Drawing	Job No. L21404
Detail Sections 4	Dwg. No. 21404-TLP-304
	Scale 1:20@A3
Status STAGE 4	Drawn RB
	Checked LW
	Date 24-06-2022

Do not scale off drawing. All dimensions & Levels are to be checked on site. Any discrepancies must be reported to the landscape architect immediately.
 Copyright THE LANDSCAPE PARTNERSHIP LTD

