

P.B

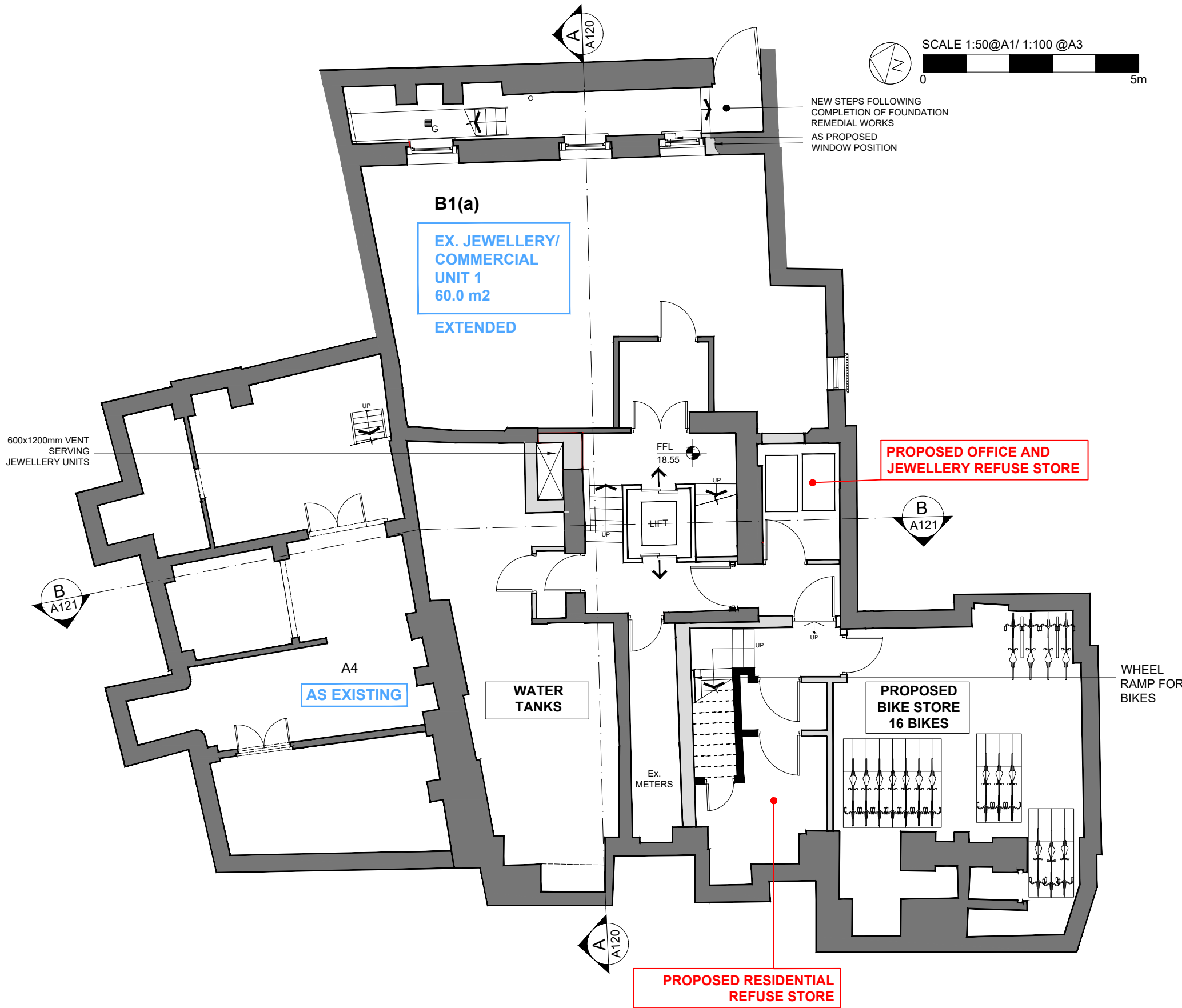
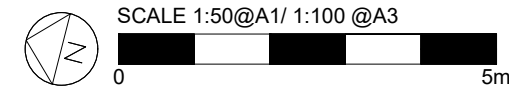

KEY

- EXISTING
- PROPOSED
- EXISTING NEIGHBOURING BUILDING
- TERRACE
- PLANTER
- BIODIVERSE ROOF

NOTE:

- THIS DRAWING IS BASED ON SURVEY INFORMATION PREPARED BY OTHERS
- ALL AREAS ARE APPROXIMATE
- ALL EXISTING USES ARE ASSUMED.
- SEE A111-114 DETAILS OF PROPOSED RESIDENTIAL LAYOUTS

INDICATES EXISTING

INDICATES PROPOSED

CLIENT: WHITE LION ESTATES LTD.	PROJECT : 72-80 LEATHER LANE LONDON, EC1N 7TR	<ol style="list-style-type: none"> 1. DO NOT SCALE THIS DRAWING 2. ALL DIMENSIONS ARE TO BE VERIFIED ON SITE BY THE CONTRACTOR AND REPORTED TO THE ARCHITECT BEFORE CONSTRUCTION 3. ANY DISCREPANCY FOUND BETWEEN THIS DRAWING AND ANY OTHER DOCUMENT MUST BE REPORTED IMMEDIATELY TO THE ARCHITECT 4. REMOVE THIS DRAWING FROM CURRENCY WHEN A REVISED DRAWING IS ISSUED 5. COPYRIGHT OF THIS DRAWING REMAINS WITH HODGES ARCHITECTS LTD 	<table border="1" style="width: 100%; border-collapse: collapse;"> <thead> <tr> <th>NO</th> <th>DATE</th> <th>REVISION</th> </tr> </thead> <tbody> <tr> <td>E</td> <td>12.08.22</td> <td>BASEMENT WINDOW SHOWN IN ORIGINAL POSITION ON "AS CONSENTED" REAR ELEVATION</td> </tr> <tr> <td>F</td> <td>12.08.22</td> <td>BASEMENT WINDOW SHOWN IN NEW POSITION AS SHOWN ON "AS PROPOSED" REAR ELEVATION</td> </tr> </tbody> </table>	NO	DATE	REVISION	E	12.08.22	BASEMENT WINDOW SHOWN IN ORIGINAL POSITION ON "AS CONSENTED" REAR ELEVATION	F	12.08.22	BASEMENT WINDOW SHOWN IN NEW POSITION AS SHOWN ON "AS PROPOSED" REAR ELEVATION	DRAWING TITLE: BASEMENT PLAN AS PROPOSED	
NO	DATE	REVISION												
E	12.08.22	BASEMENT WINDOW SHOWN IN ORIGINAL POSITION ON "AS CONSENTED" REAR ELEVATION												
F	12.08.22	BASEMENT WINDOW SHOWN IN NEW POSITION AS SHOWN ON "AS PROPOSED" REAR ELEVATION												
DRAWN BY : NH	CHECKED BY : SH	DRAWING STATUS: PLANNING		SCALE: AS NOTED	DATE: 18.06.21	REV.: F	A3							
				PROJ. NO: 011	DWG NO: A101	<div style="text-align: right;"> <p>HODGES ARCHITECTS LTD</p> <p>TEL: 07932 376 008 EMAIL: NH@HODGESARCHITECTS.CO.UK</p> </div>								