

A4201 SIDE ALLEY - PARAPET SECTION
SCALE 1:25

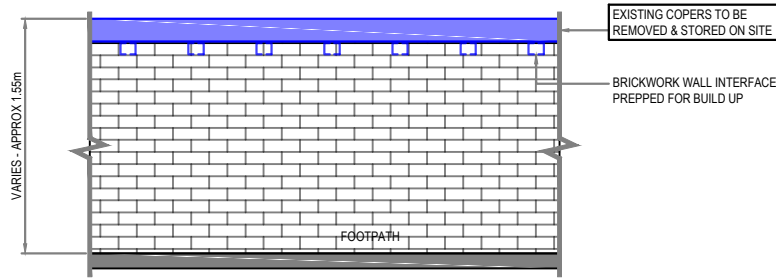

A4201 SIDE ALLEY - PARAPET ELEVATION
SCALE 1:25

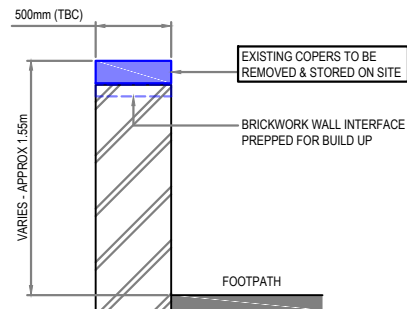

OVAl ROAD - PARAPET SECTION
SCALE 1:25

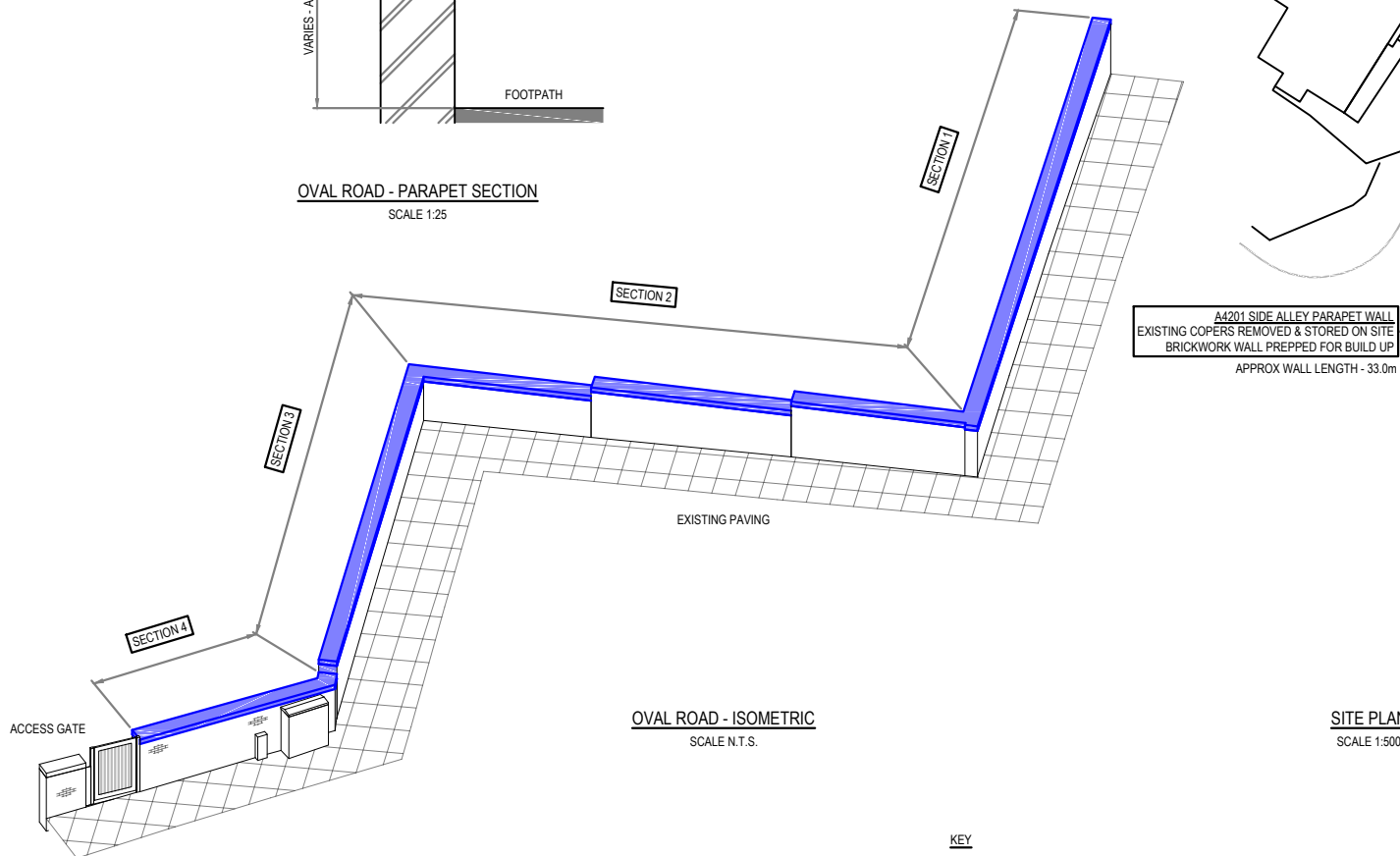

OVAl ROAD - ISOMETRIC
SCALE N.T.S.

SITE PLAN
SCALE 1:500

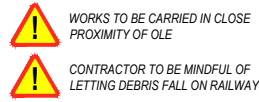

OVAl ROAD PARAPET WALL
EXISTING COPERS REMOVED & STORED ON SITE
BRICKWORK WALL PREPPED FOR BUILD UP
APPROX WALL LENGTH - 50.0m

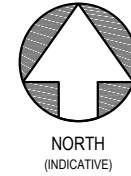

EXISTING SERVICES

- ALL BURIED, SURFACE AND OVERHEAD SERVICES INFORMATION CONTAINED WITHIN THIS DRAWING ARE INDICATIVELY ONLY.
- THE CONTRACTOR SHALL ENSURE THAT ALL SERVICES BOTH BURIED AND EXPOSED ARE FOUND AND IDENTIFIED PRIOR TO THE COMMENCEMENT OF ANY WORKS.
- DESIGNER TO BE INFORMED IMMEDIATELY OF ANY UNEXPECTED SERVICES FOUND.

REMOVAL OF EXISTING ITEMS

- ALL EXISTING ITEMS TO BE REMOVED ARE TO BE REMOVED IN A WAY THAT DAMAGES THE EXISTING STRUCTURE THE LEAST.
- ALL EXISTING ITEMS TO BE REMOVED ARE TO BE TAKEN OFF SITE AND RECYCLED OR DISPOSED OF CORRECTLY.
- IF ANY OF THE EXISTING STRUCTURES ARE DAMAGED IN REMOVAL OF EXISTING ITEMS, REPAIRS ARE TO BE CARRIED UNDER THE SUPERVISION / AGREEMENT OF THE NWR ENGINEER

DELANCEY STREET PARAPET WALL
ALTHOUGH EXISTING MASONRY WALL MEETS 1.8m HEIGHT REQUIREMENTS THE EXISTING COPERS ARE BE CHECKED FOR DEFECTIVES
APPROX WALL LENGTH - 5.0m

GENERAL NOTES

- THIS DRAWING IS FOR F001 PURPOSES ONLY.
- THIS DRAWING HAS BEEN PRODUCED FROM A POINT CLOUD SURVEY UNDERTAKEN BY NETWORK RAIL IN NOV / DEC 2020.
- DO NOT SCALE OFF THIS DRAWING. ALL DIMENSIONS TO BE CHECKED AND CONFIRMED BY THE CONTRACTOR PRIOR TO STARTING OF ANY WORK. ANY ERRORS OR DISCREPANCIES ARE TO BE BROUGHT TO THE ATTENTION OF THE NETWORK RAIL ENGINEER.
- ANY DISCREPANCIES IN THE INFORMATION GIVEN ARE TO BE BROUGHT TO THE ATTENTION OF THE ENGINEER AS SOON AS POSSIBLE.
- THIS DRAWING IS TO BE READ IN CONJUNCTION WITH ALL OTHER CONTRACT DRAWINGS AND RELEVANT SPECIFICATIONS / DOCUMENTATION.
- THE CONTRACTOR IS RESPONSIBLE FOR THE STABILITY OF THE STRUCTURES / EMBANKMENT AT ALL TIMES DURING THE WORKS.



B01	05.08.21	FORM 003 (1) ISSUE	NR	DK	TP
A01	28.01.21	FORM 001 (1) ISSUE	NR	DK	TP
REV	DATE	DESCRIPTION OF REVISIONS	DRAWN	CHK'D	APPR'D

SAFETY HEALTH AND ENVIRONMENTAL INFORMATION

THE HAZARDS AND RISKS ASSOCIATED WITH THE WORKS SHOWN ON THIS DRAWING AND DESCRIBED IN THE SCHEDULE OF WORKS ARE CONSIDERED TO BE WITHIN THE REASONABLE, NORMAL AND ACCEPTABLE LIMITS FOR GENERAL BUILDING AND MAINTENANCE WORKS. PLEASE REFER TO DESIGNER RISK ASSESSMENT
DOCUMENT REF:

STATUS
FORM F002/F003 ACCEPTANCE



Basingstoke Campus
Gresley Road
Basingstoke RG21 4ES

PROJECT: 163514

PROJECT ALPHA - PHASE 2 ANTI-TRESPASS MEASURES

DRAWING TITLE

EUSTON STATION - NORTHERN SITES EXISTING LAYOUT

DESIGNED	NWR	SIGNED	NWR	DATE	AUG 21
DRAWN	N Reinhardt	SIGNED	N Reinhardt	DATE	AUG 21
CHECKED	D Kennedy	SIGNED	D Kennedy	DATE	AUG 21
APPROVED	T Phillips	SIGNED	T Phillips	DATE	AUG 21

SCALE(S) AT A1 SHEET SIZE 841 x 594
AS SHOWN AT A1

DRAWING NUMBER
171110-NRW-LEC1-EUS-DRG-ECV-000001

REVISION
B01