

Apt

The Earnshaw and Medius House

Retail Splits

14th July 2022 - Revision E

Project Title The Earnshaw and Medius House	Project Number 15023/18013
Document Name Retail Splits	Date 14/07/2022
Status -	Revision E
Author -	Reviewed by -

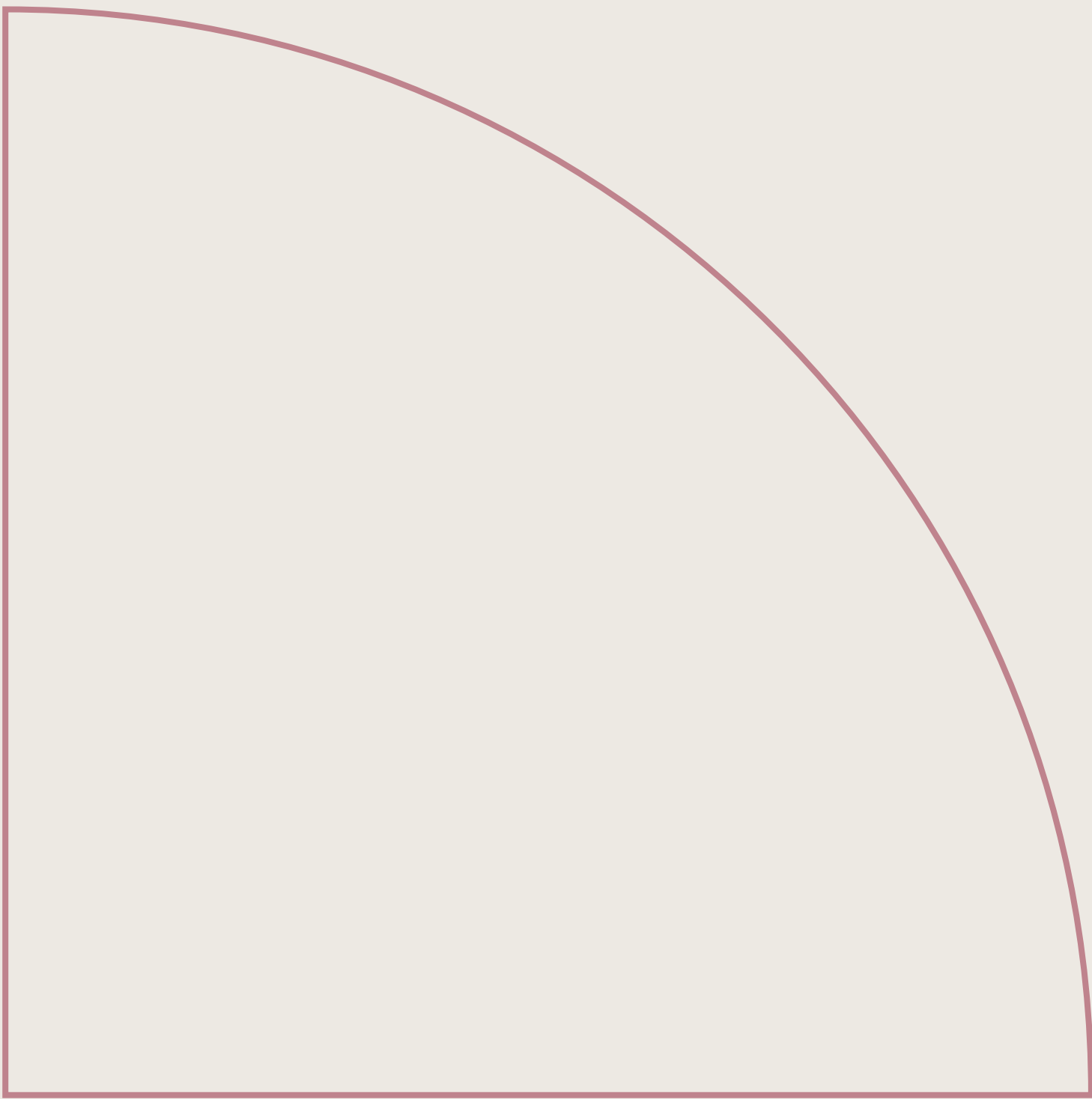

Level 00 - Castlewood House and
Medius House - S73

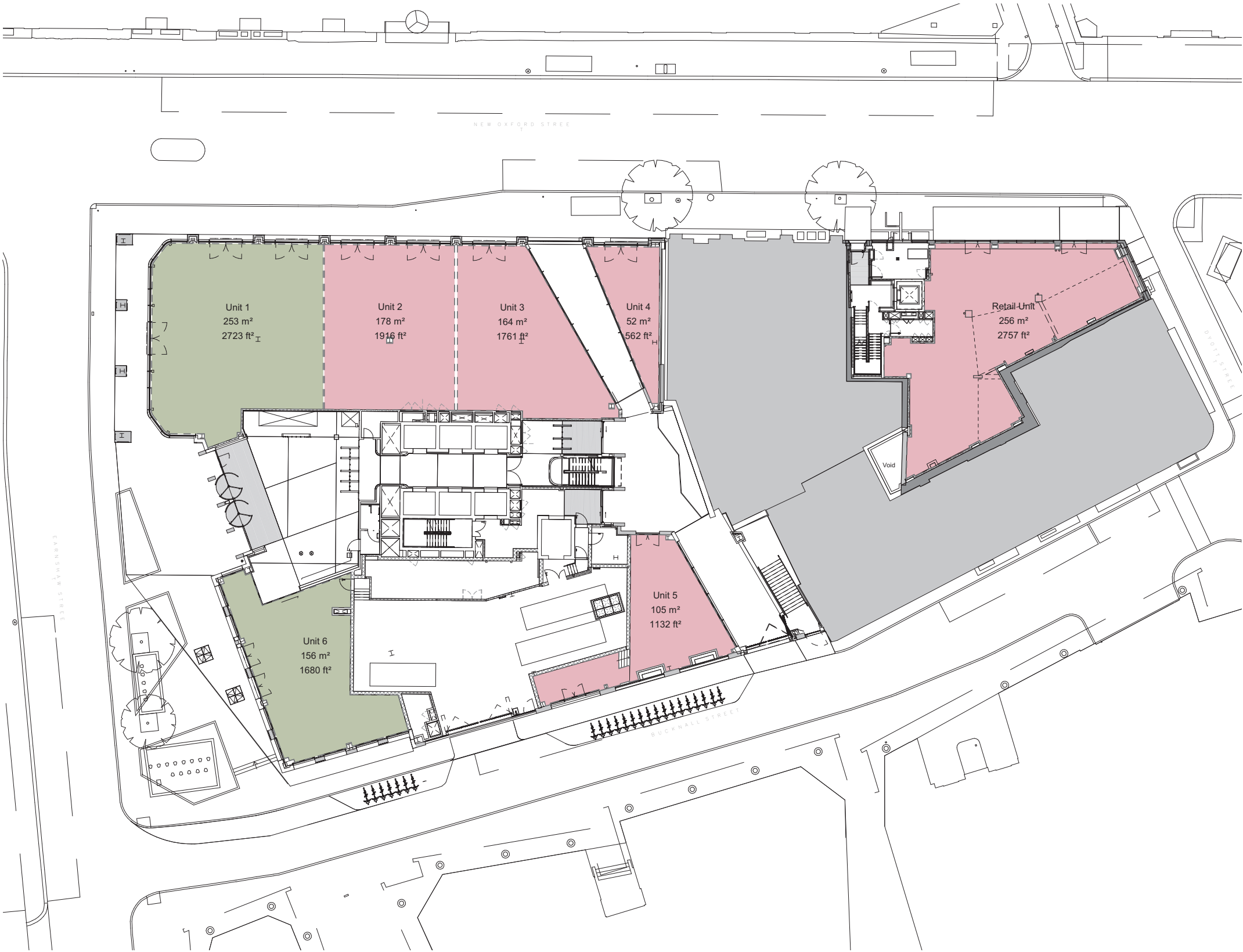

Key

Class E(a) Retail (A1)

Class E(b) Retail (A3)

Level B1 - Castlewood House and Medius House - S73

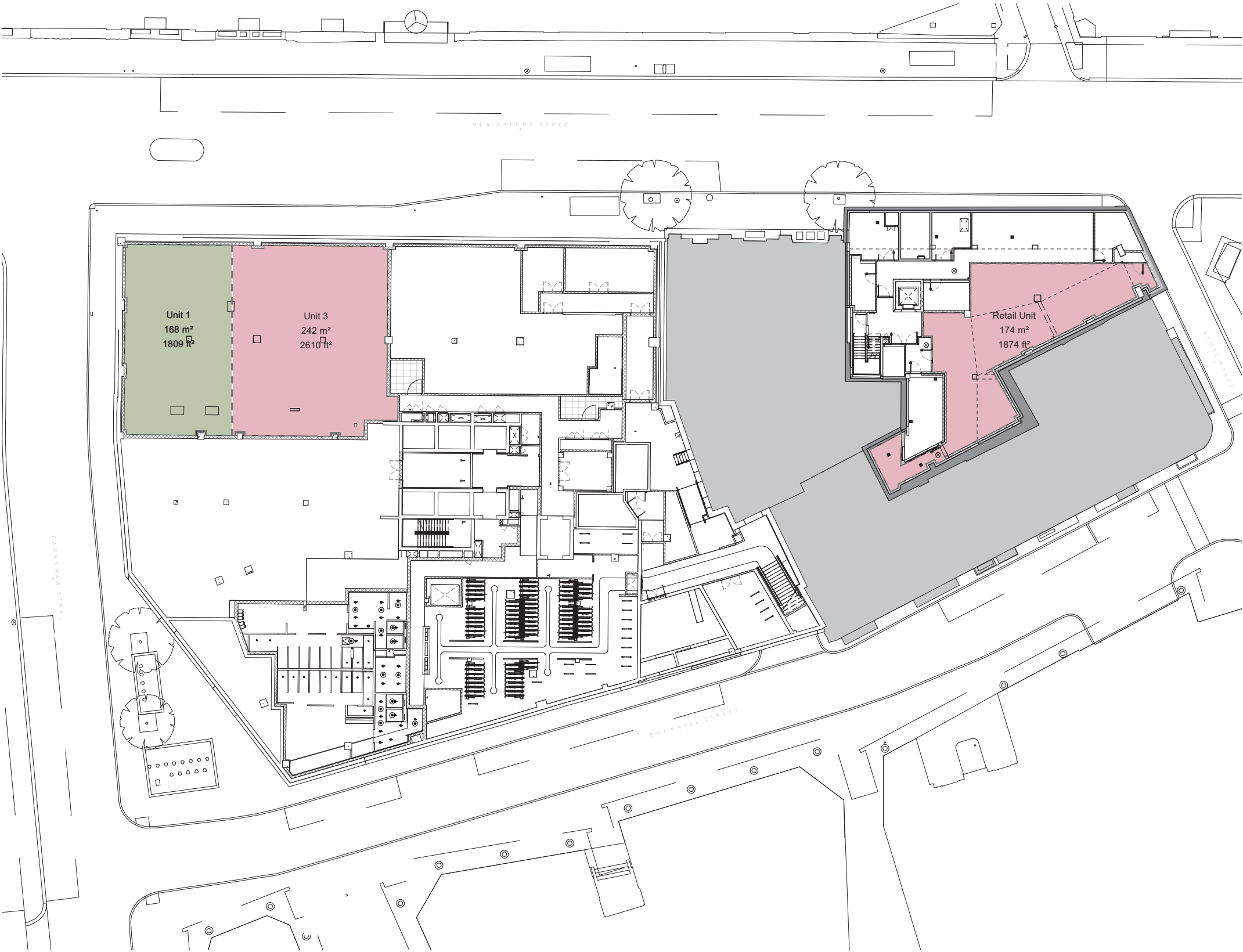

Key

- Class E(a) Retail (A1)
- Class E(b) Retail (A3)

Level 00 - Castlewood House and Medius House - Proposed

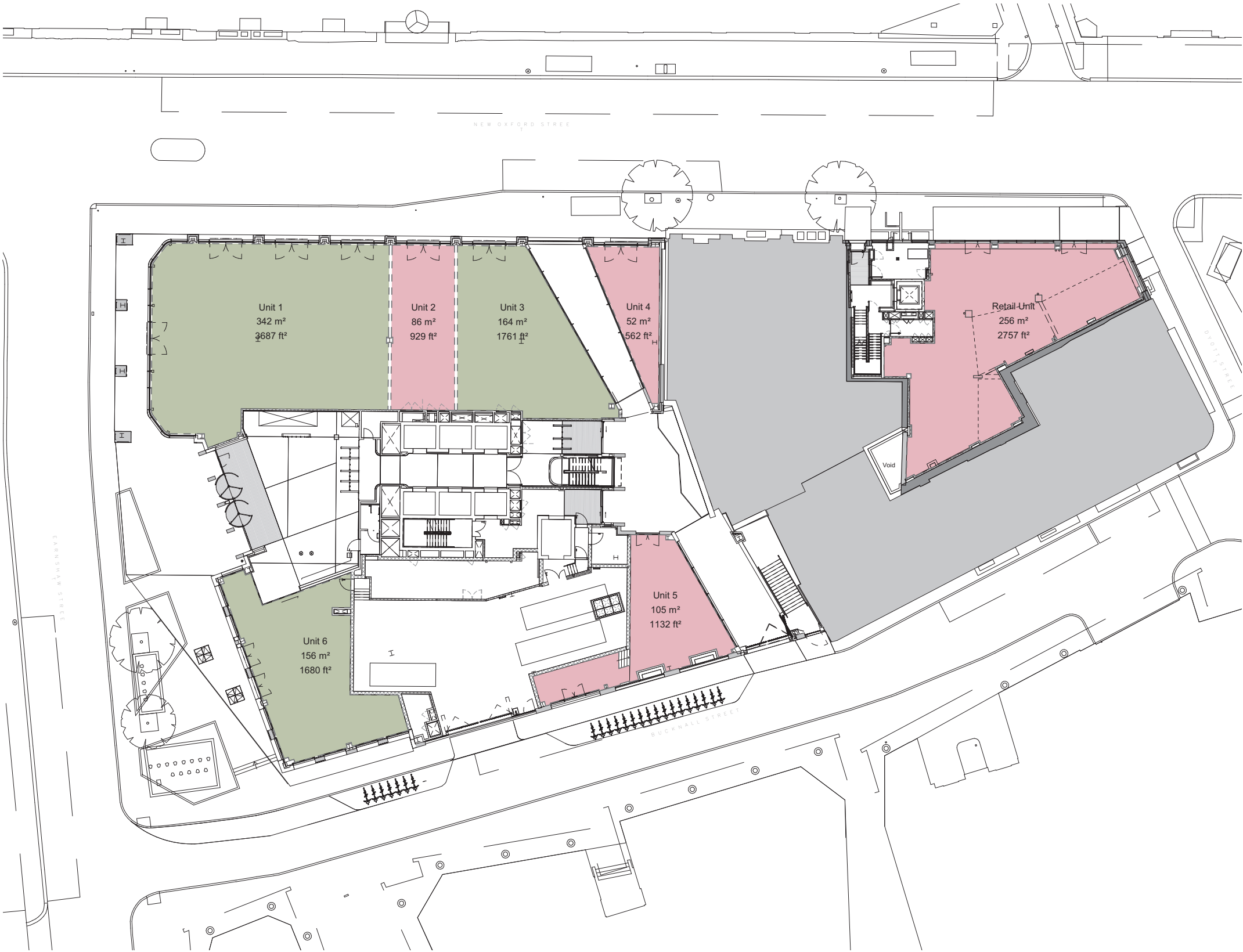

Key

Class E(a) Retail (A1)

Class E(b) Retail (A3)

Level B1 - Castlewood House and Medius House - Proposed

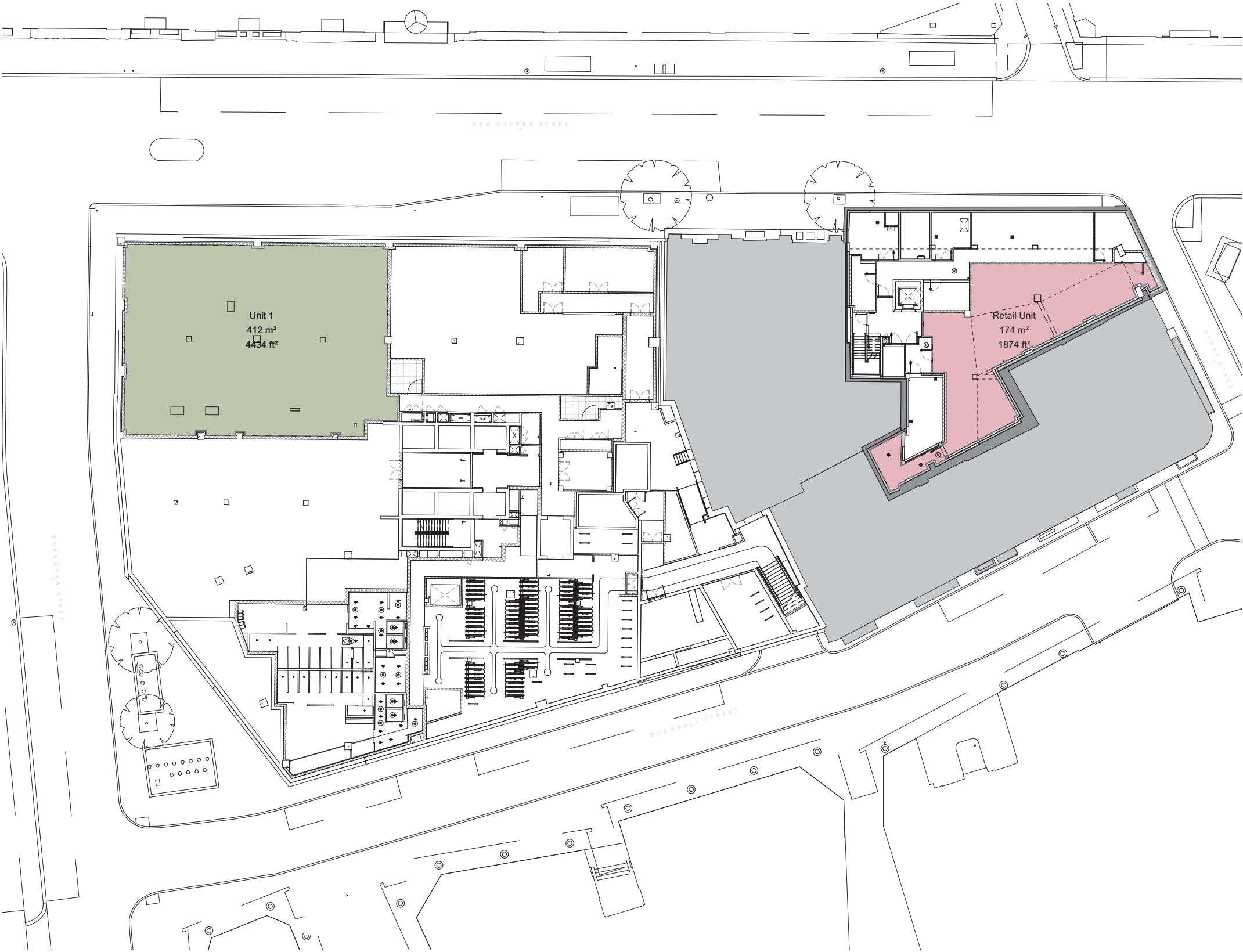

Key

- Class E(a) Retail (A1)
- Class E(b) Retail (A3)

Combined Retail Split

Castlewood House & Medius House Combined Area (sqft)	S73		Proposed Split based on S73	
Class E(a) Retail (A1)	12,611 sqft	67%	7,254 sqft	39%
Class E(b) Retail (A3)	6,212 sqft*	33 %*	11,569 sqft	61%
Total Retail Use	18,823 sqft	100%	18,823 sqft	100%

* Maximum percentage of A3 Retail permitted under original consent (33%)

Key

Class E(a) Retail (A1)

Class E(b) Retail (A3)

