

This drawing has been produced for the below named Client for the development of the below named Project and for that application alone and is not intended for use by any other person or for any other purpose. Drawings remain copyright of RAFT and may not be reproduced without written consent or licence. Do not scale off this drawing. All dimensions and levels to be checked on site or measured survey before starting work. Any discrepancies to be reported to architects before execution of relevant works. Read with other drawings and specification.

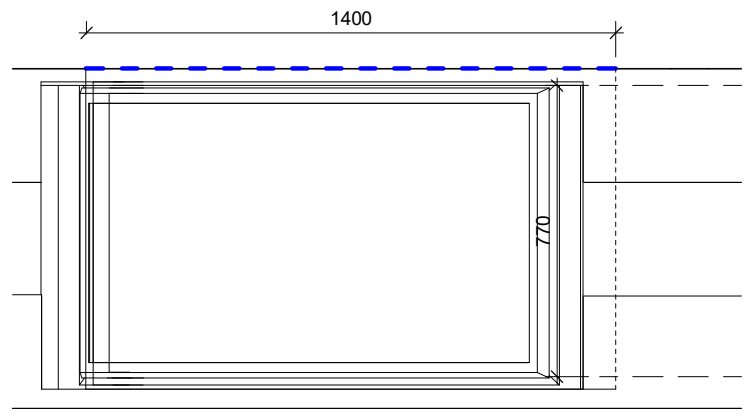

1. DETAILED PLAN R1.01
Scale 1:20

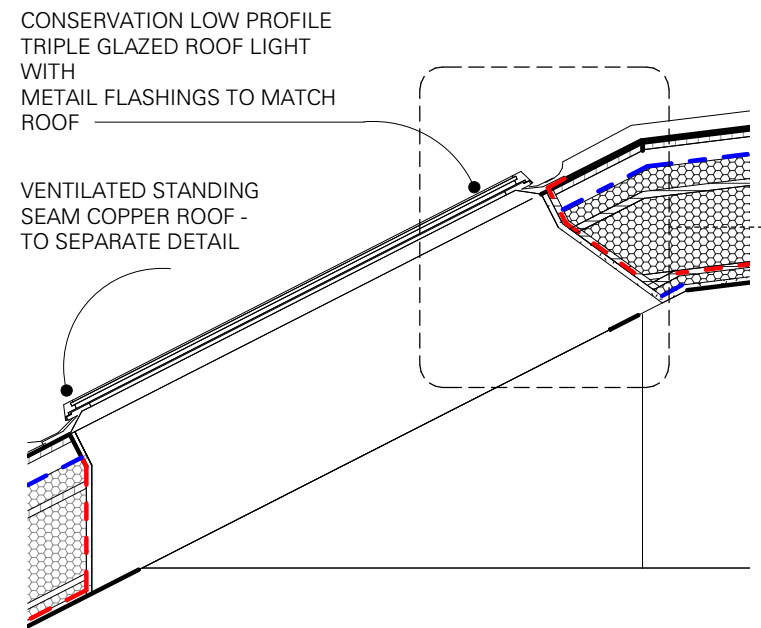

2. DETAILED SECTION R1.01
Scale 1:20

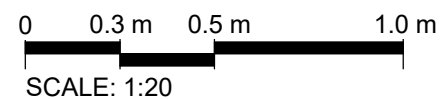

Detail 3-3105

LOW PROFILE TRIPLE GLAZED METAL FACED CONSERVATION ROOFLIGHT ON A CENTRE PIVOT

PLASTERBOARD LININGS WITH SKIM AND PAINT FINISH

3. JAMB DETAIL R1.01
Scale 1:10

METAL FLASHING TO MATCH STANDING SEAM COPPER ROOF

50 MM VENTILATED VOID WITH BREATHER MEMBRANE ROOF CLADDING TO SEPARATE DETAIL

AIRTIGHT BOARD SEALED TO ROOF WINDOW FRAME WITH AIRTIGHT TAPE

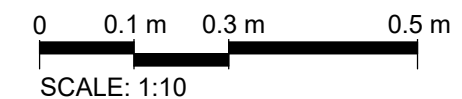

P01 Stage 4 Draft 15/08/22 GJ AK

Revision Number	Revision Description	Revision Date	Issued by	Checked by

project name

24 Grafton Road

client name

Thomas Lefevre & Celine Fornaro

project address

24 Grafton Rd London NW5 3DU

scale

As indicated

sheet size

A3

drawing title

Details - Roof Window R3.01

suitability description

S2 - Issued for information

current stage

Stage 4

drawing title

021-RA-03-03-DR-A-3105

revision

P01