

General Notes :

These drawings are to be read in conjunction with all relevant Architects/ Engineers drawings and specifications as applicable.

1. Do not scale from this drawing.
2. All dimensions are in millimeters unless clearly noted.
3. All levels and dimensions are to be checked on site prior to commencement of work.
4. Contractor to notify the consultant for any discrepancies.
5. No work should commence without planning and building regulations approval by relevant governing bodies as applicable.
6. No work should commence without party wall notices being served as applicable.
7. Contractor to check on site for the exact positioning of drainage/SVP and mains and notify relevant authorities for approval as necessary.
8. Any removal of structural elements and required steelwork is to be approved and installed in accordance with the structural engineers specifications.
9. All proprietary materials and components are to be delivered, stored, protected, installed and finished in accordance with the manufacturers recommendations.
10. All works to be strictly in accordance with CDM (Health & Safety) Regulations.

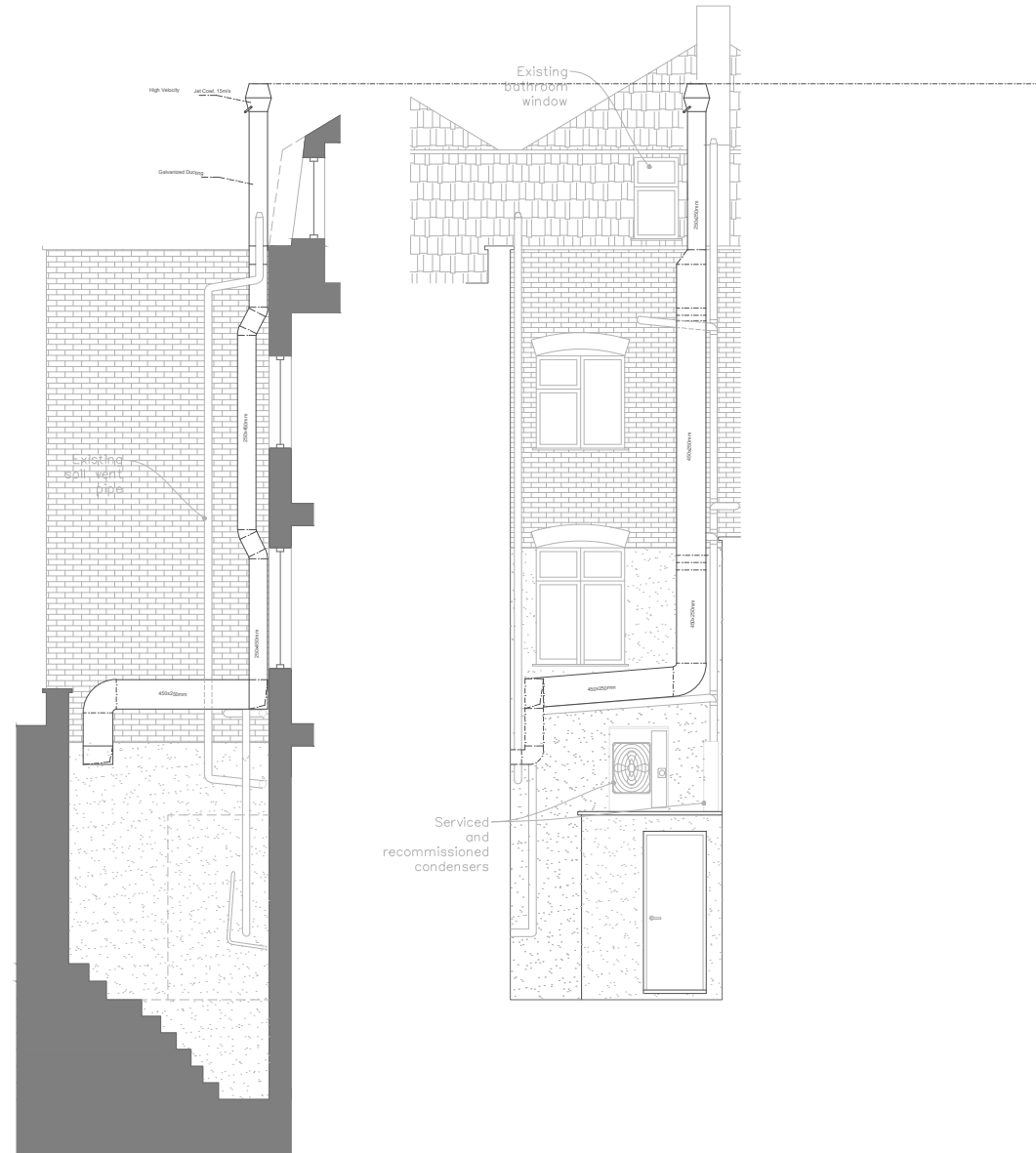

Proposed Side Elevation Proposed Rear Elevation

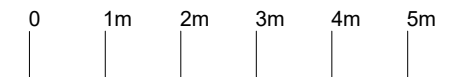

Scale 1:100

AGENT: Neolydia Design & Architecture	TITLE: Proposed Rear & Side Elevations	Drawn By: Yusuf Aydin/Riba P2	
CONTRACT: 82 Camden High Road NW1 0LT	DATE: 08.08.2022	JOB NO: 060101	