

REV	DATE	AMENDMENTS

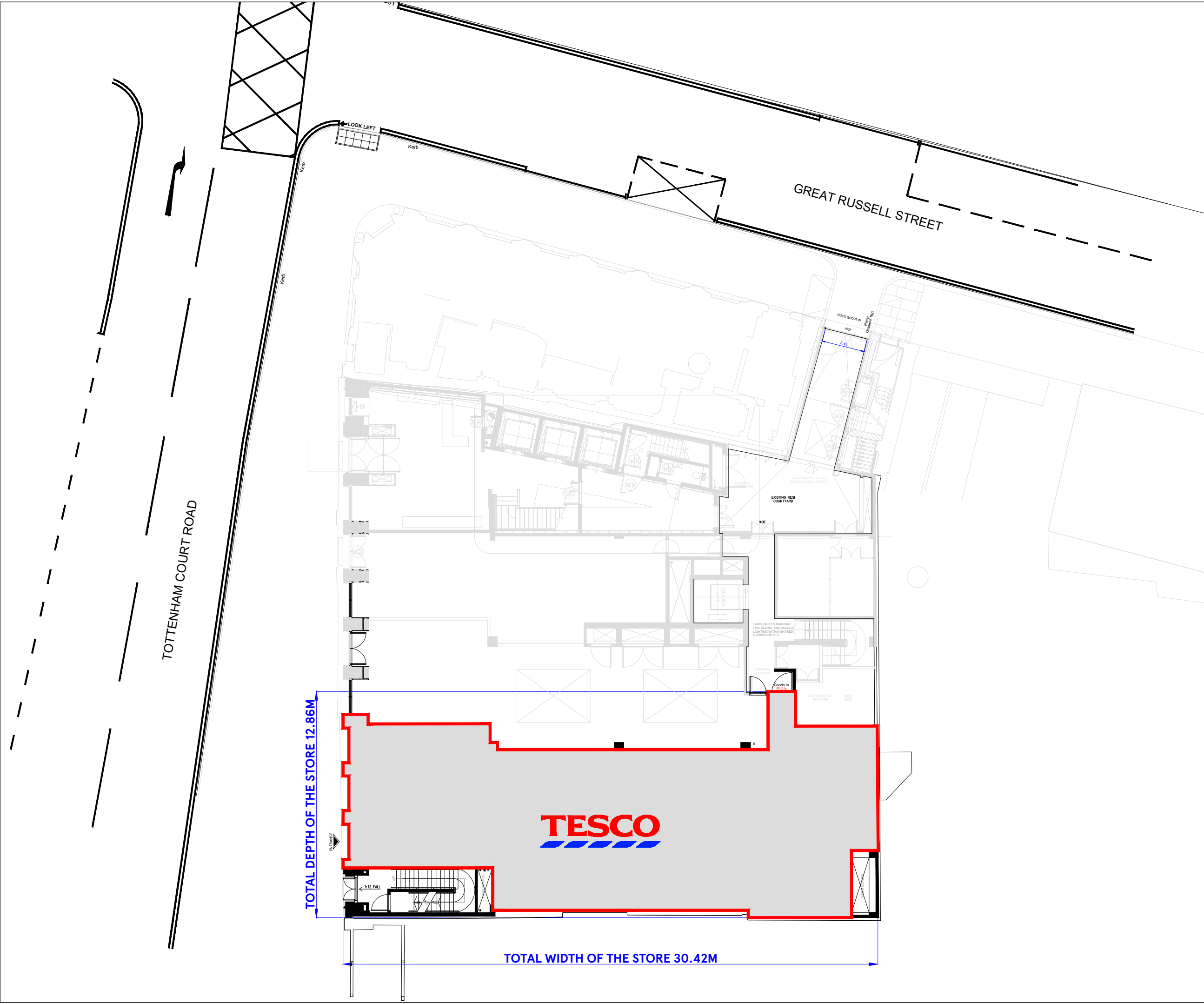

ADDRESS:
267 Tottenham Court Road, Fitzrovia
W1T 7RQ

- FIRE DETECTION LEGEND
- SOUNDER
 - VISUAL INDICATOR (BEACON)
 - 6KG 27A FOAM & 2KG CO2 EXTINGUISHERS
 - AREA COVERED BY SMOKE DETECTIONS
 - BREAK GLASS CALL POINT

PROJECT:
GARFUNKEL,
TOTTENHAM COURT ROAD

DESCRIPTION
PROPOSED SITE
BWS LICENSE LAYOUT

DRAWING NO. GARFUNKLESFeaspg##BWSPLAN

PHASE 1 ISSUE ##

SYSTEM ID. No. GARFUNKLESFeasbg##.dwg

SCALE 1:200@A3 DATE 28.04.2022

UK PLANNING MANAGER TOM BAYLIS



TESCO STORES LIMITED
EXPRESS GROUP
PLUS BUILDING, THE BOULEVARD, SHIRE PARK,
WELWYN GARDEN CITY, HERTFORDSHIRE, AL7 1GB UK
TELEPHONE - 01707 395150
THE COPYRIGHT IN THIS DRAWING IS THE PROPERTY OF TESCO STORES LIMITED
ALL RIGHTS ARE RESERVED. WITHOUT THE WRITTEN CONSENT OF TESCO STORES LIMITED
THIS DRAWING IS NOT TO BE REPRODUCED OR TRANSMITTED IN ANY FORM OR BY ANY MEANS
OR FROM ANY RETRIEVAL SYSTEM WITHOUT THE WRITTEN LICENCE FROM THE OWNER
© 2022 TESCO STORES LIMITED

TOTAL DEPTH OF THE STORE 12.86M

TOTAL WIDTH OF THE STORE 30.42M

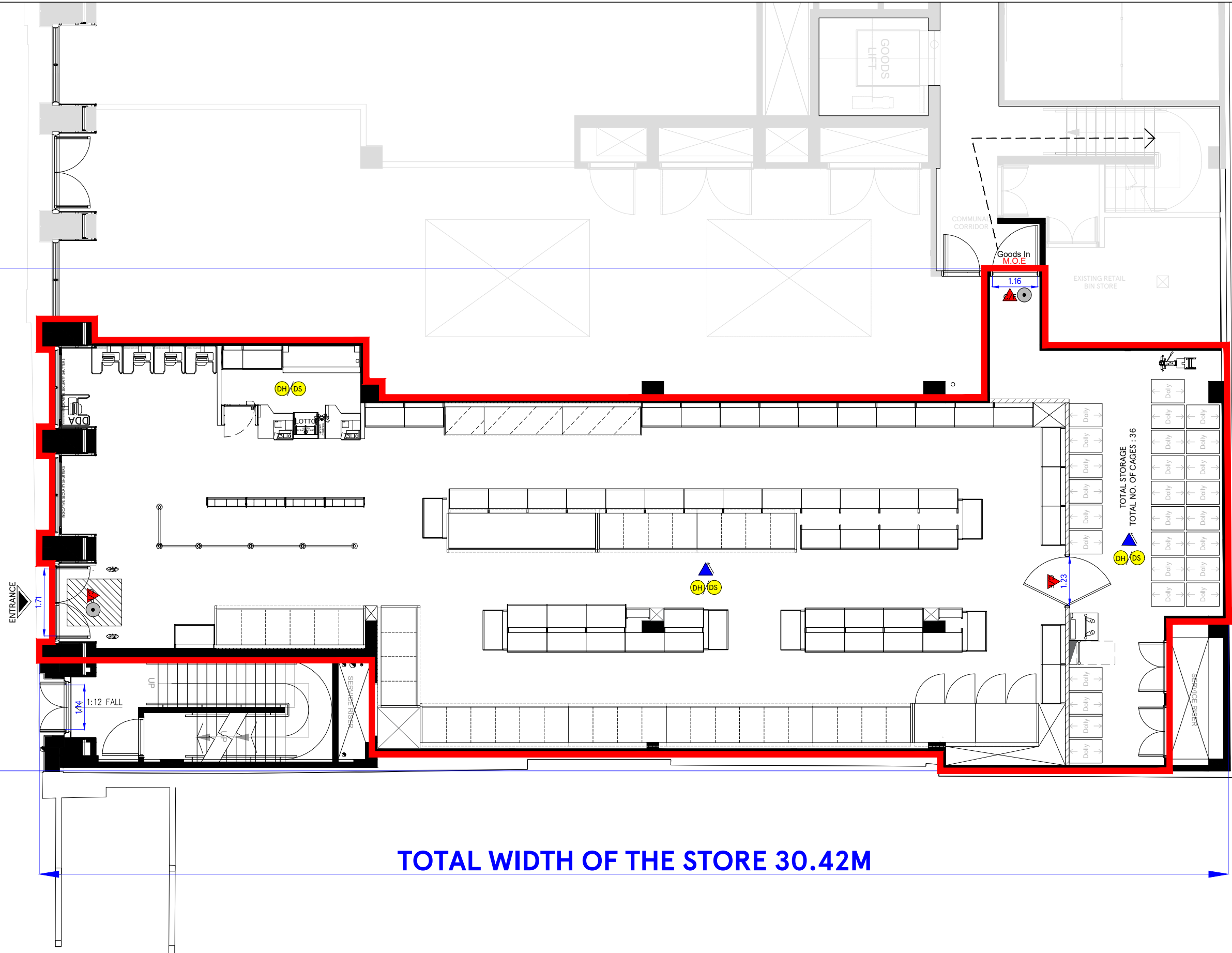

REV	DATE	AMENDMENTS

ADDRESS:
267 Tottenham Court Road, Fitzrovia
W1T 7RQ

- FIRE DETECTION LEGEND
- SOUNDER
 - VISUAL INDICATOR (BEACON)
 - 6KG 27A FOAM & 2KG CO2 EXTINGUISHERS
 - AREA COVERED BY SMOKE DETECTIONS
 - BREAK GLASS CALL POINT

PROJECT:
GARFUNKEL, TOTTENHAM

DESCRIPTION
PROPOSED RETAIL - GROUND
BWS LICENSE LAYOUT

DRAWING NO. GARFUNKLESFeasg##BWSPLAN

PHASE 1 ISSUE ##
SYSTEM ID. No. GARFUNKLESFeasg##.dwg
GARFUNKLESFeasg##.dwg

SCALE 1:100@A3 DATE 28.04.2022

UK PLANNING MANAGER TOM BAYLIS



TESCO STORES LIMITED
EXPRESS GROUP
PLUS BUILDING, THE BOULEVARD, SHIRE PARK,
WELWYN GARDEN CITY, HERTFORDSHIRE, AL7 1GB UK
TELEPHONE: 01707 395150
WEBSITE: www.tesco.com
ALL RIGHTS ARE RESERVED. WITHIN THE SCOPE OF THIS PUBLICATION
THE COPYRIGHT IS RESERVED TO THE PROPERTY OF TESCO STORES LIMITED
NO PART OF THIS PUBLICATION MAY BE REPRODUCED OR TRANSMITTED IN ANY FORM OR BY ANY MEANS
WITHOUT THE PRIOR WRITTEN LICENCE FROM THE OWNER
© 2022 TESCO STORES LIMITED

TOTAL DEPTH OF THE STORE 13.93M

TOTAL WIDTH OF THE STORE 27.43M

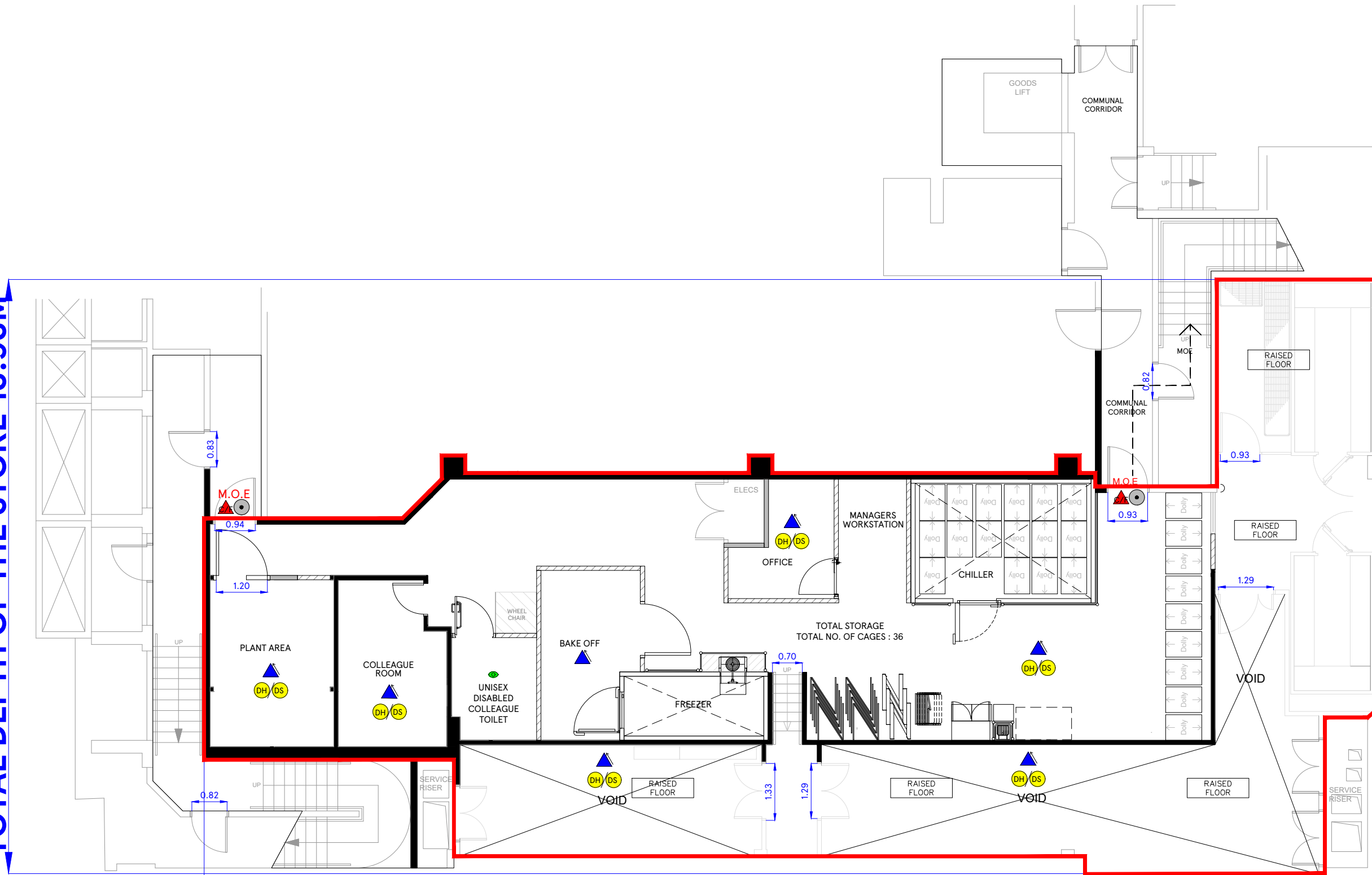

REV	DATE	AMENDMENTS
ADDRESS: 267 Tottenham Court Road, Fitzrovia W1T 7RQ		
FIRE DETECTION LEGEND		
	SOUNDER	
	VISUAL INDICATOR (BEACON)	
	6KG 27A FOAM & 2KG CO2 EXTINGUISHERS	
	AREA COVERED BY SMOKE DETECTIONS	
	BREAK GLASS CALL POINT	
PROJECT: GARFUNKEL, TOTTENHAM		
DESCRIPTION PROPOSED RETAIL - BASEMENT BWS LICENSE LAYOUT		
DRAWING NO. GARFUNKLESFeasgab##BWSPLAN		
PHASE	1	ISSUE ##
SYSTEM ID. No.	GARFUNKLESFeasg##.dwg GARFUNKLESFeasg##.dwg	
SCALE	DATE	
1:100@A3	28.04.2022	
UK PLANNING MANAGER	TOM BAYLIS	
STORE PLANNING		
TESCO STORES LIMITED EXPRESS GROUP PLUS BUILDING, THE BOULEVARD, SHIRE PARK, WELWYN GARDEN CITY, HERTFORDSHIRE, AL7 1GB UK TELEPHONE: 01707 395150 THE COPYRIGHT IN THIS DRAWING IS RESERVED BY TESCO STORES LIMITED ALL RIGHTS ARE RESERVED. NEITHER THE WHOLE NOR ANY PART OF THIS PUBLICATION MAY BE REPRODUCED OR TRANSMITTED IN ANY FORM OR BY ANY MEANS, WITHOUT THE PRIOR WRITTEN LICENCE FROM THE OWNER © 2022 TESCO STORES LIMITED		