

FROM Rob Lewis, [REDACTED]
FAO Camden Planning Department

Dear Sir/Madam

Re: Major concerns that ambulances will have nowhere to offload patients if these works proceed

I am very concerned that GOSH's plans do not provide sufficient access for ambulance and hospital visitors and deliveries during the multi year construction period.

See the following diagrams and photographs which clearly show a major problem with the design.

This is GOSH's 3D models showing how half of Great Ormond Street will be taken over by building works, with 90% of the available parking and 45% of road space disappearing.

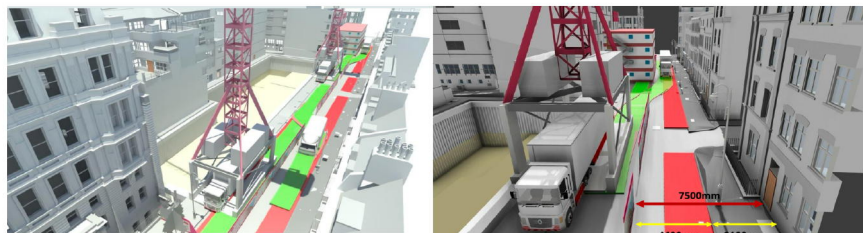

They propose a tiny area at one end of the road for ALL ambulances, delivery vehicles, disabled patient, visitors and residents.

See below. This looks only big enough for perhaps six or eight vehicles.

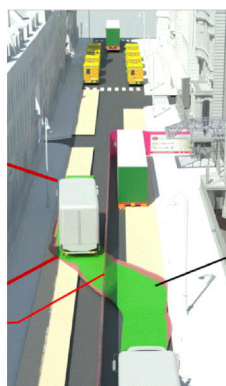

This is a fatal flaw in the programme design. At least if they want to continue to be able to run the hospital safely.

Here are photographs of the ambulances as at today at 1pm on Monday 8 August 2022, not a particularly busy time.

It still shows 15 ambulances, about twice the total capacity for all road users available during development phase.

And this 15 figure is before

- (a) hospital deliveries,
- (b) taxis,
- (c) disabled patients/visitors,
- (d) local residents dropping stuff off
- (e) supermarket or other deliveries to those living on Great Ormond Street.

The 15 figure is literally **just the ambulances!**

See below today's ambulances (which were all present simultaneously)







I continue to worry about all the other issues previously discussed but felt it important to highlight this issue today.

GOSH need to propose a scheme which allows patients visitors to get to the hospital easily and safely, noting many will arrive on wheelchairs or be suffering from an illness, and that there will be a constant stream of 30 ton lorries also ploughing down the round.

Medical professionals at UCLH have already raised concerns about delays for blue light ambulances – but the photographs show that normal ambulances and patients will be unable to get to GOSH and UCLH safely either.

The scheme needs to be totally rethought for the benefit of patients, residents, and for safety.

Best wishes,

Rob Lewis