

**Notes:**

**SALES FLOOR:**

- Principle contractor to fit equipment
- Water Drop pendant light refer to specification pack
- Wall lights in booth area refer to spec pack
- Black grid ceiling refer to spec pack
- Wall mounted AC unit

**DDA:**

- HVAC is indicative and HVAC specialist to confirm layout and requirements for planning

**BASEMENT:**

- MC to provide and install wall mounted AC

**GENERAL NOTES**

1. ALL WORKS WITHIN THIS DOCUMENT TO BE INSTALLED/CARRIED OUT IN COMPLIANCE WITH THE LATEST BUILDING REGULATIONS AND BRITISH STANDARDS.
2. CONTRACTOR TO CHECK AND VERIFY ALL ON-SITE DIMENSIONS PRIOR TO MANUFACTURE/INSTALLATION AND MUST REPORT ANY DISCREPANCIES BACK TO RETAIL DESIGN SOLUTIONS. FAILURE TO DO SO WILL BE AT THE CONTRACTORS EXPENSE.
3. THIS DRAWING MUST NOT BE SCALED. WORK TO DIMENSIONS ONLY.
4. ANY CONSTRUCTION/WORKING DRAWINGS IN THIS DOCUMENT ARE INDICATIVE ONLY. IT IS THE RESPONSIBILITY OF THE CONTRACTOR TO ENSURE THEY ARE FIT FOR PURPOSE AND TO MAKE AMENDMENTS WHERE NECESSARY PRIOR TO INSTALLATION.
5. THE CONTENTS OF THIS DOCUMENT ARE THE PROPERTY OF RETAIL DESIGN SOLUTIONS. IT IS NOT TO BE COPIED OR DISTRIBUTED IN WHOLE OR PART WITHOUT FORMAL CONSENT.

**DATE**   **NOTES**

- 20.03.22   EXISTING LAYOUTS PRODUCED
- 21.04.22   PROPOSED LAYOUTS PRODUCED

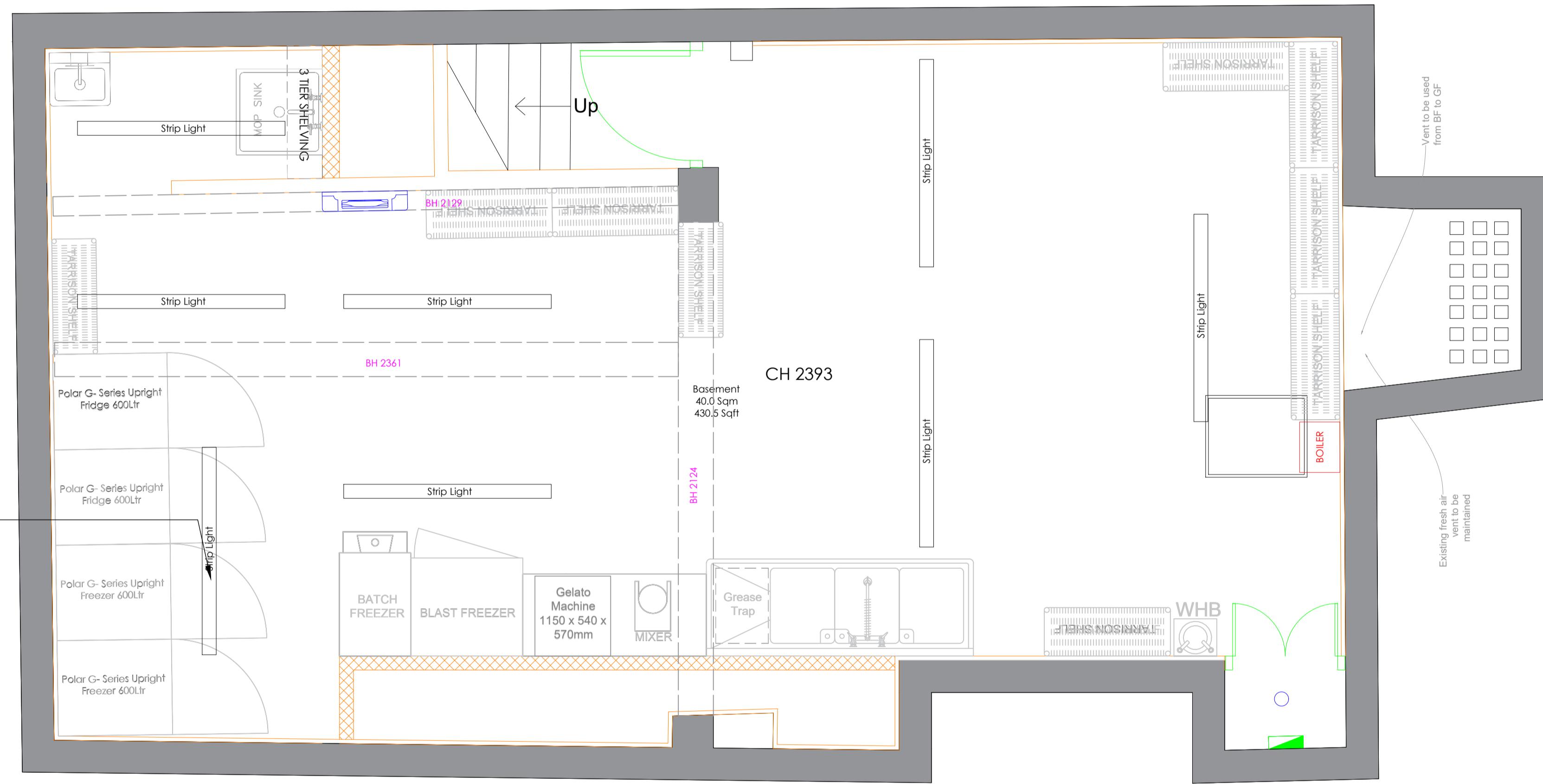

Basement ceiling to be retained and silver baton strip lighting added

TOTAL SEAT COUNT - 20

SOLID WALLS

NEW PARTITION WALLS

Proposed Basement RCP  
Scale 1:25 @ A1



KEY FINISHES	
	BULKHEAD PAINTED TO MATCH JOHNSTONE'S MANHATTAN GREY MATT
	BLACK GRID CEILING AT HEIGHT 2200MM
	EXISTING CEILING TO BE REDECORATED

PROPOSED CEILING AND RCP LIGHTING KEY	Qty.	SPEC
	8	Article number: 61318 Colour: White
	3	Article number: HL497649 Colour: White Material: Aluminium
	21	Article number: 102850 Colour: Black Bulb included: No excl. light bulb
	3	
	12	Article number: 102850 Colour: Black Bulb included: No excl. light bulb
	1	Article number: BH15W Colour: White 15W LED

HVAC	
	Air-Con Cassette
	Wall Mounted Air-Con Cassette
	Fresh Air Grille
	Ceiling Access Hatch
	Recessed Heater Panel
	Radiator
	Overhead Heater
	WC Extraction

**PROJECT** CREPE DELICIOUS

**ADDRESS**  
89 LEATHER LANE  
CENTRAL LONDON  
EC1N 7TS

**SCALE** 1:50@A1

**CLIENT**

**DRAWN BY**

The Mill Store, Foundry Lane, Earls Colne, Essex, CO6 2SB  
Tel. 01787 224878