

Notes:

SALES FLOOR:

- Principle contractor to fit equipment
- Water Drop pendant light refer to specification pack
- Wall lights in booth area refer to spec pack
- Black grid ceiling refer to spec pack
- Wall mounted AC unit

DDA:

- HVAC is indicative and HVAC specialist to confirm layout and requirements for planning

BASEMENT:

- MC to provide and install wall mounted AC

GENERAL NOTES

1. ALL WORKS WITHIN THIS DOCUMENT TO BE INSTALLED/CARRIED OUT IN COMPLIANCE WITH THE LATEST BUILDING REGULATIONS AND BRITISH STANDARDS.
2. CONTRACTOR TO CHECK AND VERIFY ALL ON-SITE DIMENSIONS PRIOR TO MANUFACTURE/INSTALLATION AND MUST REPORT ANY DISCREPANCIES BACK TO RETAIL DESIGN SOLUTIONS. FAILURE TO DO SO WILL BE AT THE CONTRACTORS RISK.
3. THIS DRAWING MUST NOT BE SCALED. WORK TO DIMENSIONS ONLY.
4. ANY CONSTRUCTION/WORKING DRAWINGS IN THIS DOCUMENT ARE INDICATIVE ONLY. IT IS THE RESPONSIBILITY OF THE CONTRACTOR TO ENSURE THEY ARE FIT FOR PURPOSE AND TO MAKE AMENDMENTS WHERE NECESSARY PRIOR TO INSTALLATION.
5. THE CONTENTS OF THIS DOCUMENT ARE THE PROPERTY OF RETAIL DESIGN SOLUTIONS. TO BE USED ONLY AS ISSUED OR DISTRIBUTED IN WHOLE OR PART WITHOUT FORMAL CONSENT.

DATE **NOTES**

- 20.03.22 EXISTING LAYOUTS PRODUCED
- 21.04.22 PROPOSED LAYOUTS PRODUCED

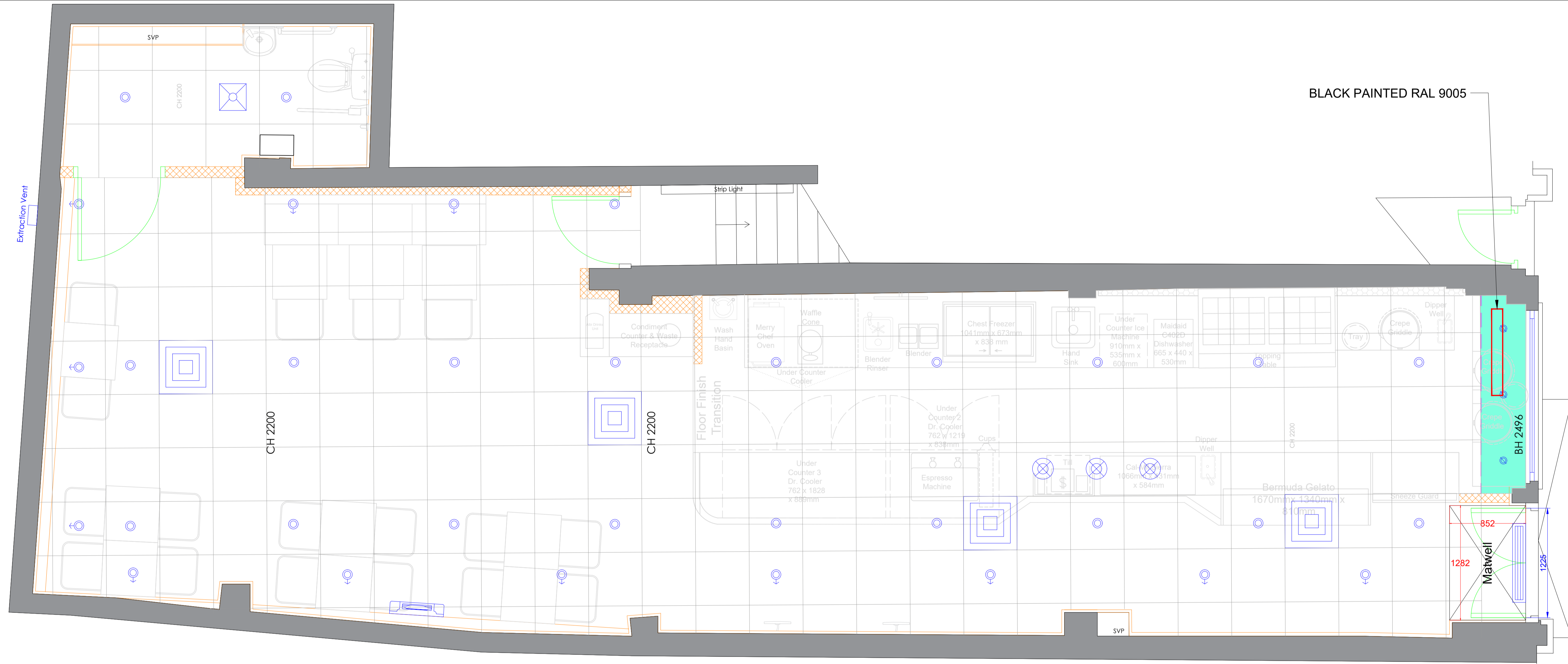

TOTAL SEAT COUNT - 20

SOLID WALLS

NEW PARTITION WALLS

Proposed Ground Floor RCP
Scale 1:25 @ A1

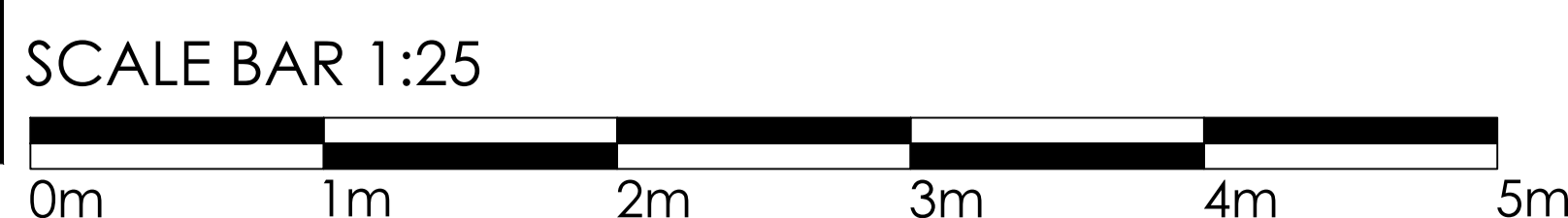

| KEY FINISHES | |
|--------------|-------------------------------------|
| | BULKHEAD PAINTED BLACK RAL 9005 |
| | BLACK GRID CEILING AT HEIGHT 2200MM |
| | EXISTING CEILING TO BE REDECORATED |

| PROPOSED CEILING AND RCP LIGHTING KEY | Qty. | SPEC |
|---------------------------------------|------|---|
| | 8 | Article number: 61318 Colour: White |
| | 3 | Article number: HL497649 Colour: White Material: Aluminium |
| | 21 | Article number: 102850 Colour: Black Bulb included: No excl. light bulb |
| | 3 | |
| | 12 | Article number: 102850 Colour: Black Bulb included: No excl. light bulb |
| | 1 | Article number: BH15W Colour: White 15W LED |

| HVAC | |
|------|-------------------------------|
| | Air-Con Cassette |
| | Wall Mounted Air-Con Cassette |
| | Fresh Air Grille |
| | Ceiling Access Hatch |
| | Recessed Heater Panel |
| | Radiator |
| | Overhead Heater |
| | WC Extraction |

PROJECT CREPE DELICIOUS

ADDRESS
89 LEATHER LANE
CENTRAL LONDON
EC1N 7TS

SCALE
7.1 **SCALE** 1:50@A1

CLIENT

DRAWN BY

The Mill Store, Foundry Lane, Earls Colne, Essex, CO6 2SB
Tel. 01787 224878